

12 EXTERIOR/INTERIOR

EXTERIOR/INTERIOR-----	12 - 1
BASIC CHECK AND ADJUSTMENT----	12 - 1
BUMPER -----	12 - 2
REMOVAL AND INSTALLATION (STANDARD-BUMPER EQUIPPED VEHICLE)-----	12 - 2
REMOVAL AND INSTALLATION(AERO- BUMPER EQUIPPED VEHICLE) -----	12 - 4
REAR BUMPER -----	12 - 6
REMOVAL AND INSTALLATION-----	12 - 6
COWL TOP VENTILATOR LOUVER -----	12 - 8
REMOVAL AND INSTALLATION-----	12 - 8
SIDE STONE GUARD-----	12 - 10
REMOVAL AND INSTALLATION -----	12 - 10
ROOF END SPOILER-----	12 - 11
REMOVAL AND INSTALLATION -----	12 - 11
ROOF MOLDING-----	12 - 12
REMOVAL AND INSTALLATION -----	12 - 12
BLACKOUT TAPES(FRONT DOOR)-----	12 - 15
REMOVAL AND INSTALLATION -----	12 - 15
BLACKOUT TAPES(REAR DOOR)-----	12 - 19
REMOVAL AND INSTALLATION -----	12 - 19
INSTRUMENT PANEL -----	12 - 23
REMOVAL AND INSTALLATION -----	12 - 23
REAR CONSOLE BOX -----	12 - 31
REMOVAL AND INSTALLATION -----	12 - 31
FRONT SEAT-----	12 - 33
REMOVAL AND INSTALLATION -----	12 - 33
DISASSEMBLING AND ASSEMBLING -----	12 - 35
REAR SEAT-----	12 - 37
REMOVAL AND INSTALLATION -----	12 - 37
DISASSEMBLING AND ASSEMBLING -----	12 - 39
FRONT SEAT OUTER BELT -----	12 - 42
REMOVAL AND INSTALLATION -----	12 - 42
REAR SEAT OUTER BELT -----	12 - 44
REMOVAL AND INSTALLATION(TWO- POINT SEAT BELTS)-----	12 - 44
REMOVAL AND INSTALLATION(THREE- POINT SEAT BELTS)-----	12 - 46
TRIM PANEL-----	12 - 48
REMOVAL AND INSTALLATION -----	12 - 48
ROOF HEADLINING-----	12 - 53
REMOVAL AND INSTALLATION -----	12 - 53
FLOOR CARPET -----	12 - 57
REMOVAL AND INSTALLATION -----	12 - 57

1 EXTERIOR/INTERIOR

1-1 BASIC CHECK AND ADJUSTMENT

1-1-1 SEATBELT DAMAGE CHECK

1. Visually check the seatbelt for damage.

SPECIFIED VALUE: There should be no defect.

2. Operate the buckle to see if there is any problem in engagement

SPECIFIED VALUE: There should be no defect.

2 BUMPER

2-1 REMOVAL AND INSTALLATION(STANDARD-BUMPER EQUIPPED VEHICLE)

2-1-1 ARTICLES TO BE PREPARED

Tool

Clip remover

2-1-2 REMOVAL AND INSTALLATION PROCEDURES

(1) Components

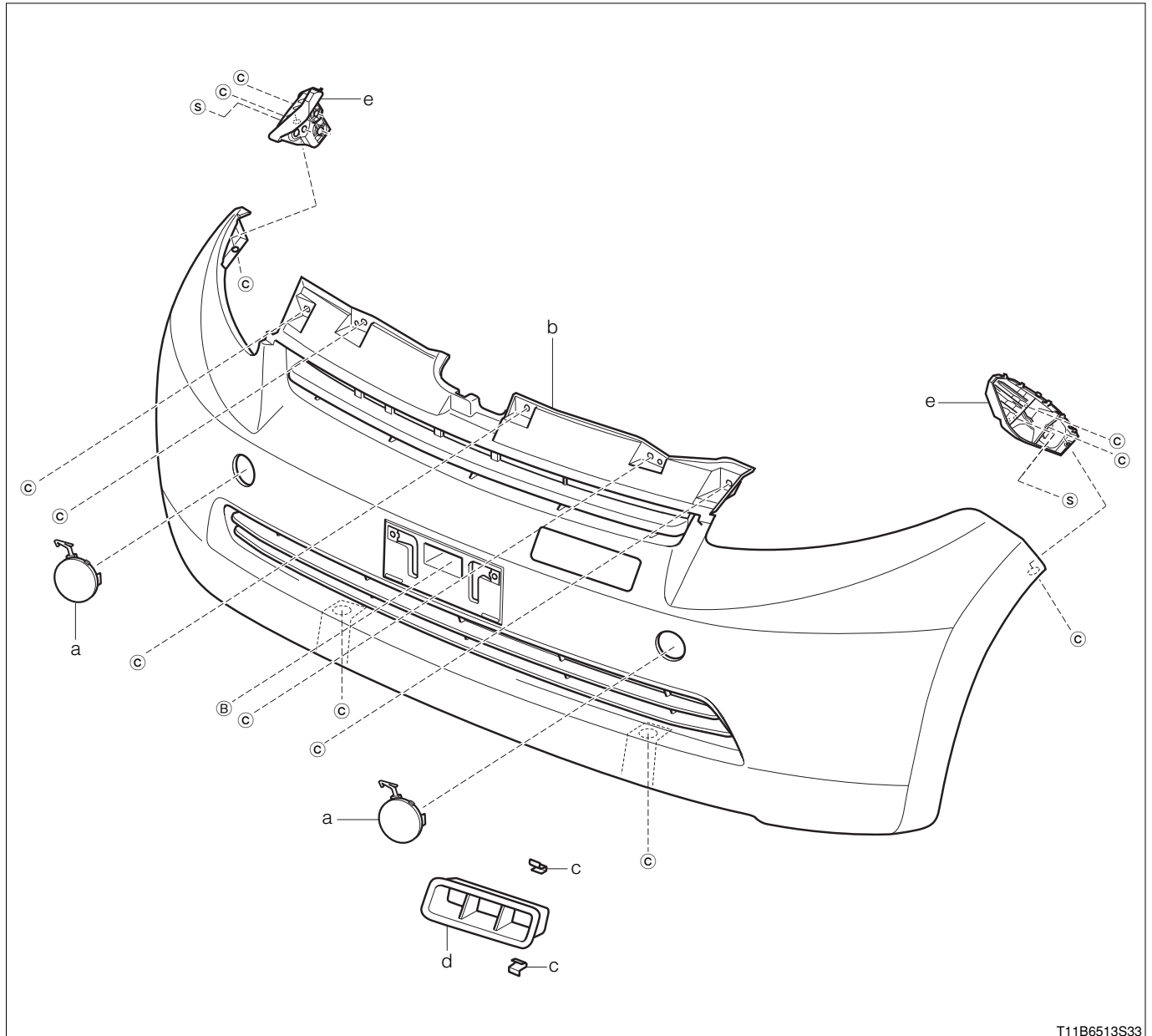

T11B6513S33

(2) Removal and installation procedures

- 1 a Cover, front bumper hole, RH/LH
- 2 b Cover, front bumper
- 3 c Clip (not equipped for some specifications)
- ▲ 4 d Garnish, front bumper (not equipped for some specifications)
- 5 e Support, front bumper side, RH/LH

12-3

2-1-3 POINTS OF INSTALLATION

(1) Cover, front bumper

1. When replacing the cover with a new one, cut the cover at the scribing line shown at the back of the cover.

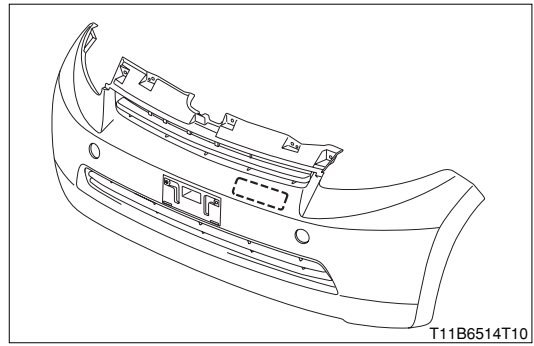

2-2 REMOVAL AND INSTALLATION(AERO-BUMPER EQUIPPED VEHICLE)

2-2-1 ARTICLES TO BE PREPARED

Tool

Clip remover

2-2-2 REMOVAL AND INSTALLATION PROCEDURES

(1) Components

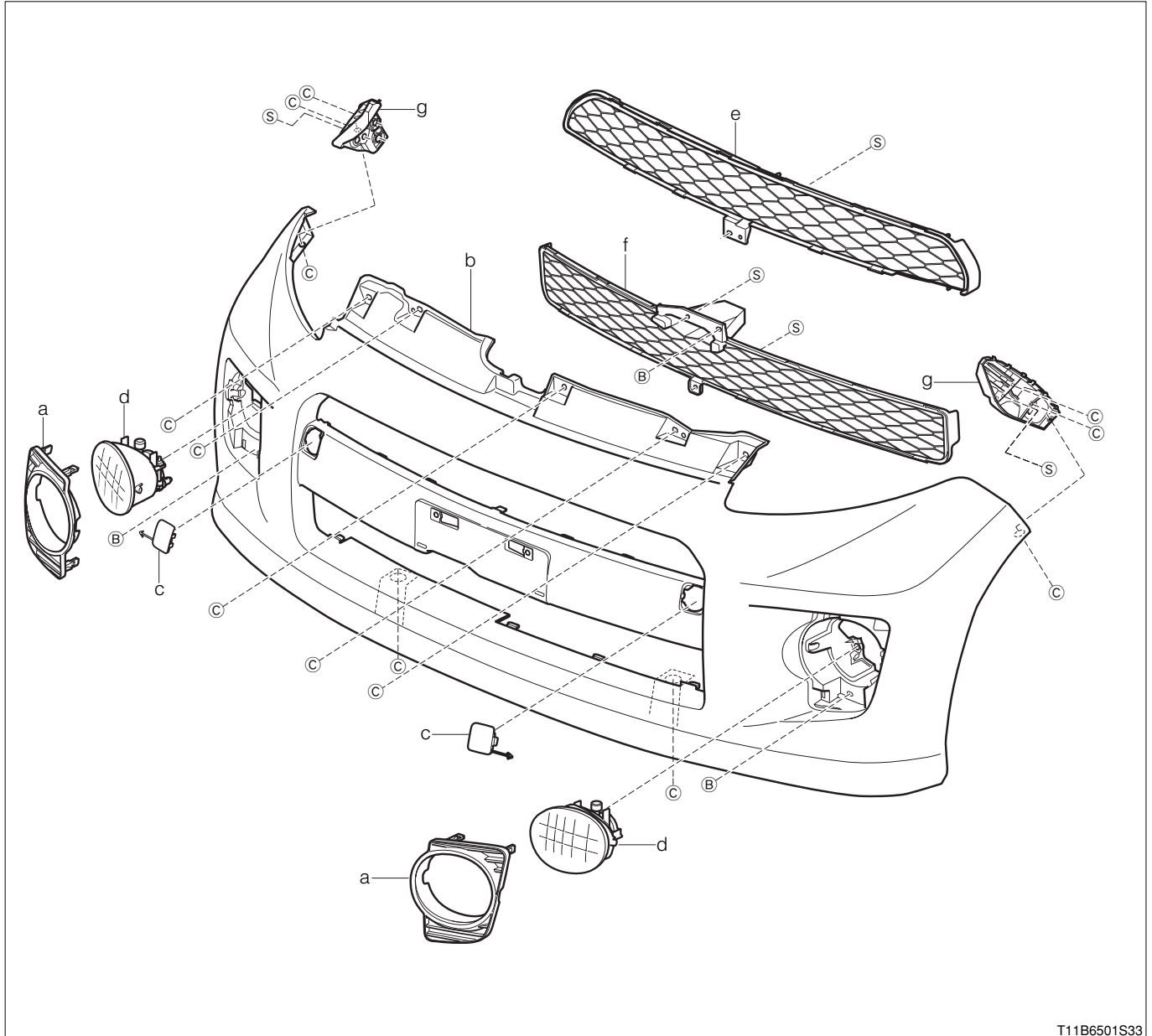

T11B6501S33

(2) Removal and installation procedures

- ▼ 1 a Moulding, front bumper side, RH/LH
- 2 b Cover, front bumper
- 3 c Cover, front bumper hole, RH/LH
- ▼ ▲ 4 d Lamp Ay, fog, RH/LH
- 5 e Grille, radiator, lower No.1
- 6 f Grille, radiator, lower No.2
- 7 g Support, front bumper side, RH/LH

I2-5

2-2-3 POINTS OF REMOVAL

(1) Moulding, front bumper side, RH/LH

- 1.Remove by detaching the pawl at the position indicated in the right figure.

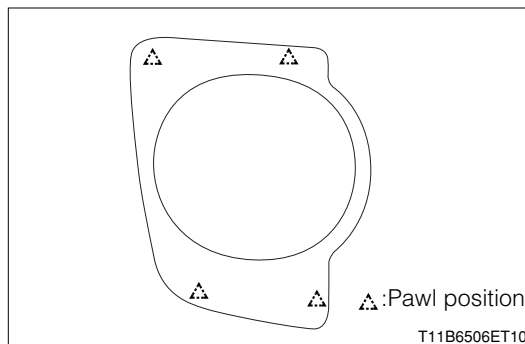

(2) Lamp Ay, fog, RH/LH

Refer to Page J1-9.

2-2-4 POINTS OF INSTALLATION

(1) Lamp Ay, fog, RH/LH

Refer to Page J1-9.

2-2-5 OPERATION AFTER INSTALLATION

- 1.Carry out the photometric axis adjustment of the front fog lamp.
Refer to Page J1-2.

3 REAR BUMPER

3-1 REMOVAL AND INSTALLATION

3-1-1 ARTICLES TO BE PREPARED

Tool

Long TORX® wrench T40,Clip remover

3-1-2 OPERATION BEFORE REMOVAL

- 1.Remove the license plate lamp Ay.
Refer to Page J1-14.

3-1-3 REMOVAL AND INSTALLATION PROCEDURES

(1) Components

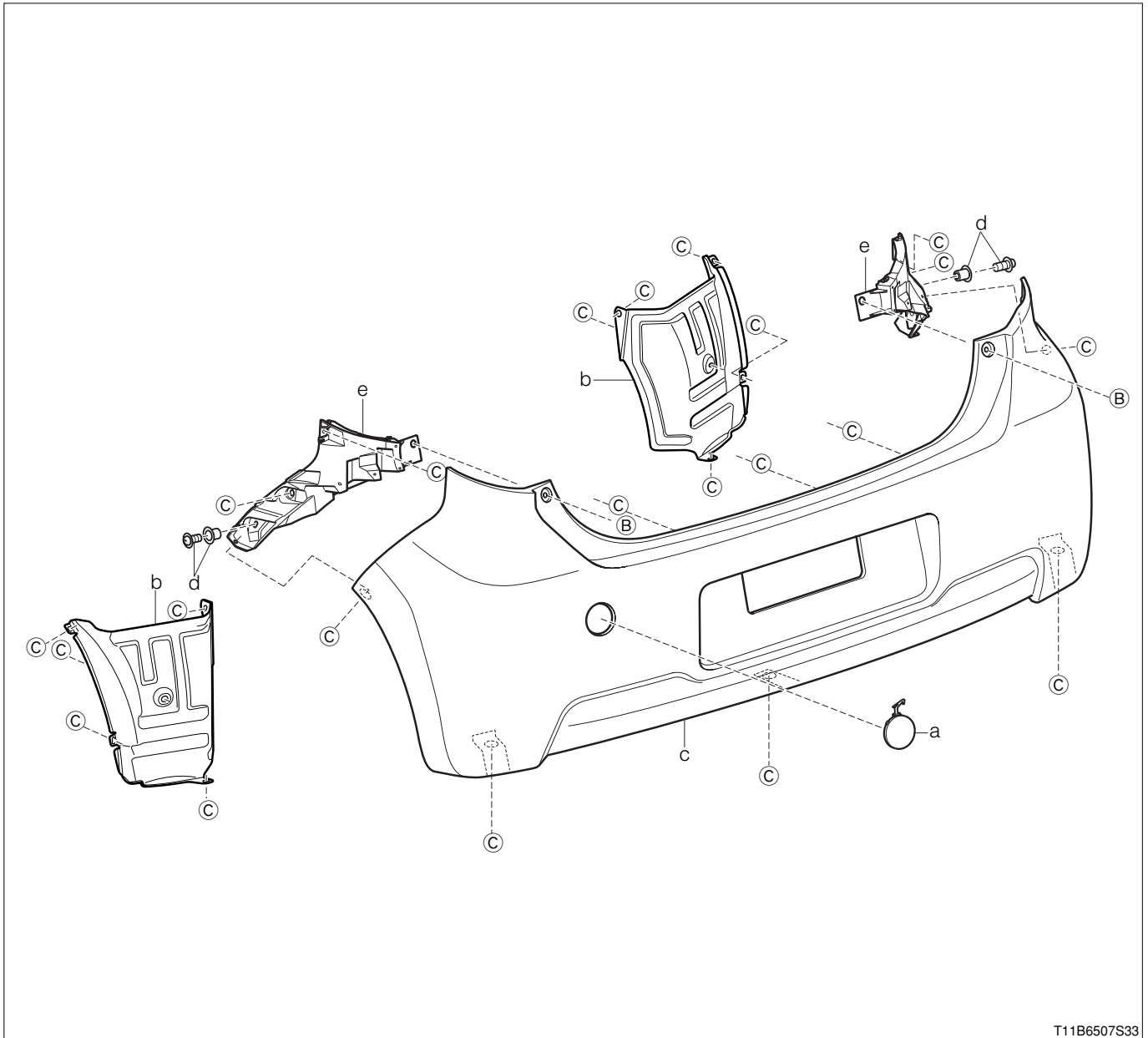

(2) Removal and installation procedures

- 1 a Cover, rear bumper, upper LH
- 2 b Liner, rear wheel house, RH/LH
- ▼ 3 c Cover, rear bumper
- 4 d Retainer, front bumper, upper
- 5 e Support, rear bumper side, RH/LH

3-1-4 POINTS OF REMOVAL

(1) Cover, rear bumper

1. Remove the clips (8 pcs) and the bolts (2 pcs).

TOOL: Long TORX® wrench T40

2. Remove the pawls of the bumper side support in the order of a→b→c→d.

NOTE

- Draw the cover to the outer side of the vehicle and disengage the pawls.

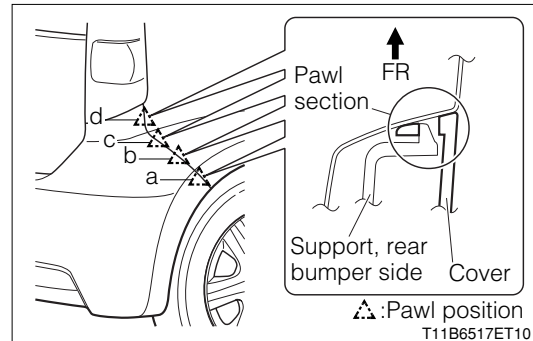

3. Turn the lower end of the cover to the front of the vehicle; the upper end to the rear of the vehicle. Pass the license plate through the service hole for the cover removal/installation use. Move the cover downward to remove.

CAUTION

- Be careful not to allow the cover to interfere with the rear end of the exhaust pipe.

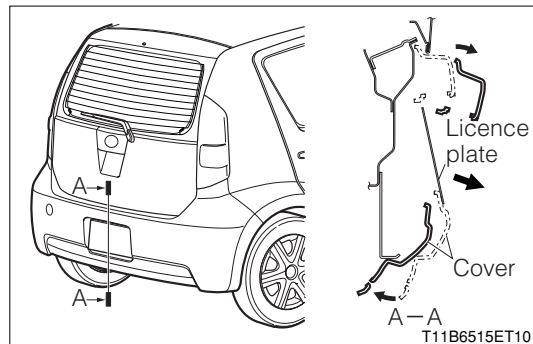

3-1-5 OPERATION AFTER INSTALLATION

1. Install the license plate lamp Ay.

Refer to Page J1-14.

4 COWL TOP VENTILATOR LOUVER

4-1 REMOVAL AND INSTALLATION

4-1-1 ARTICLES TO BE PREPARED

Tool

Clip remover

Lubricant, adhesive, others

Primer for molding (equivalent 3M K-500)

4-1-2 OPERATION BEFORE REMOVAL

1. Remove the front wiper arm RH/LH.
Refer to Page J2-12.

4-1-3 REMOVAL AND INSTALLATION PROCEDURES

(1) Components

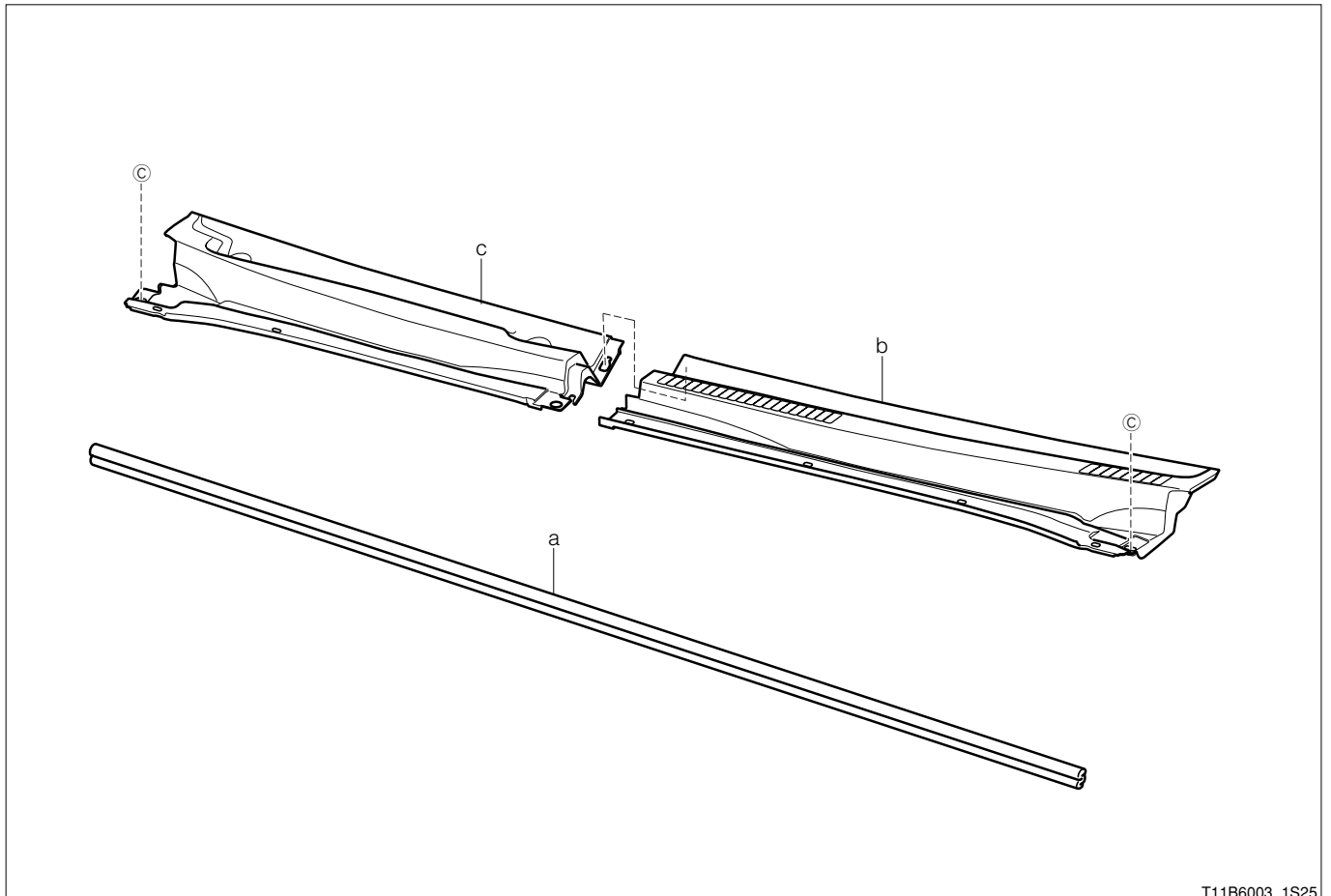

T11B6003_1S25

(2) Removal and installation procedures

- ▼ ▲ 1 a Seal, hood to cowl top
- 2 b Louver, cowl top ventilator, LH
- ▼ ▲ 3 c Louver, cowl top ventilator, RH

4-1-4 POINTS OF REMOVAL

(1) Hood to cowl top seal, RH cowl top ventilator louver

- When removing the seal and the louver from the vehicle, remove them while the seal is mounted to the louver.

CAUTION

- When the seal is removed from the louver, the seal surface will be broken where the double-coated tape is attached.

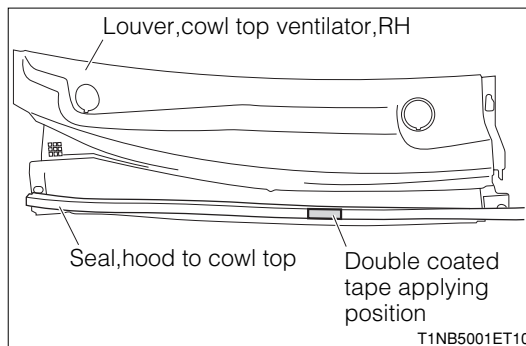

4-1-5 POINTS OF INSTALLATION

(1) Hood to cowl top seal, RH cowl top ventilator louver

① When the RH louver is reused

- After removing the seal from the louver, remove any remaining double-coated tape and primer on the louver.
- Apply primer to the louver.

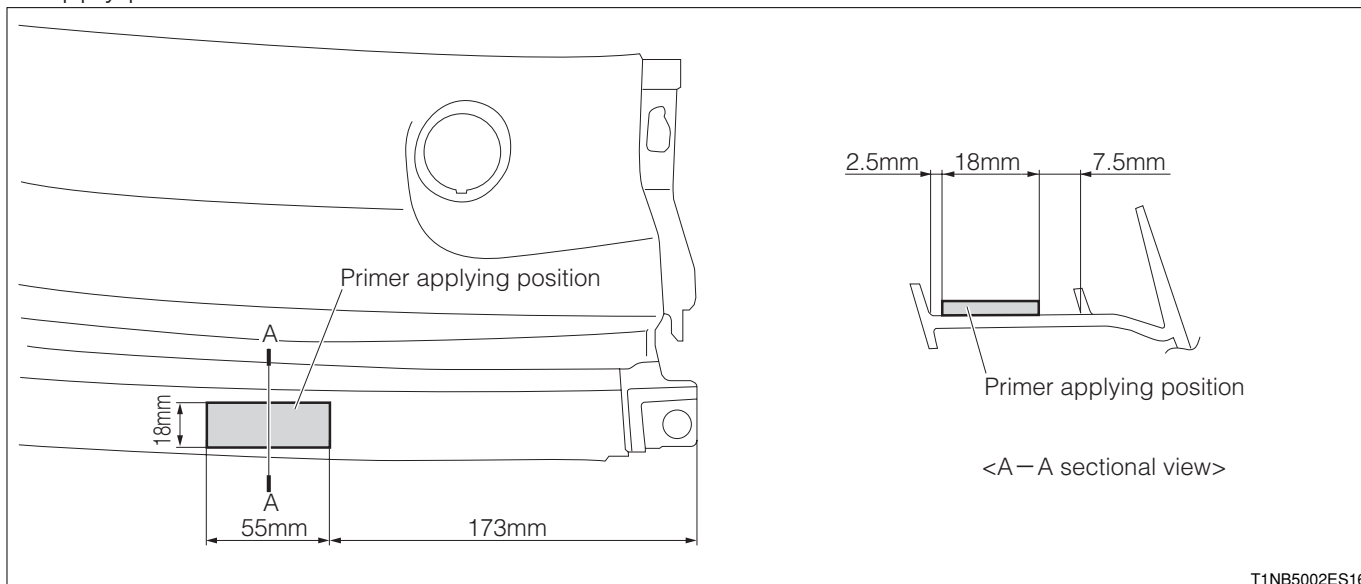

NOTE

- When applying the primer, follow the instruction of the primer instruction manual, etc.

LUBRICANT: Primer for molding (equivalent to 3M K-500)

- After installing the louver to the vehicle, attach the seal clips onto the louver, except for the double-coated tape, to temporarily attach the seal.
- Peel-off the affixed paper of the double-coated tape and apply the double-coated tape to the louver.

② When the new RH louver is used

- Install the louver to the vehicle.

NOTE

- There is no need to apply the primer, as the primer has been coated to the replacement parts.

- Attach the seal clips onto the louver, except for the double-coated tape, to temporarily attach the seal.
- Peel-off the affixed paper of the double-coated tape and apply the double-coated tape to the louver.

4-1-6 OPERATION AFTER INSTALLATION

- Install the front wiper arm RH/LH.

Refer to Page J2-12.

5 SIDE STONE GUARD

5-1 REMOVAL AND INSTALLATION

5-1-1 ARTICLES TO BE PREPARED

Tool

Clip remover

5-1-2 REMOVAL AND INSTALLATION PROCEDURES

(1) Components

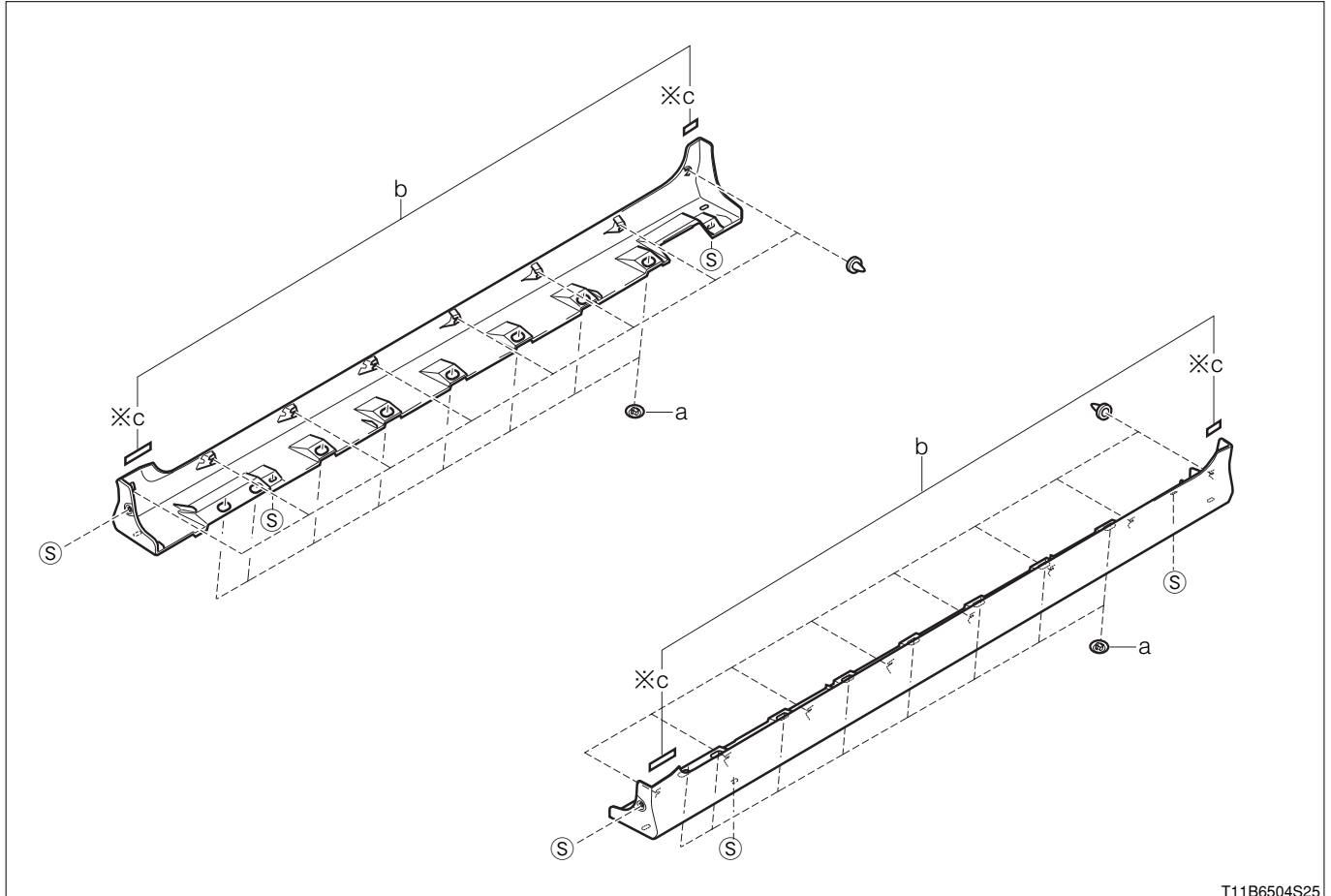

T11B6504S25

※:Non - reusable parts

(2) Removal and installation procedures

- 1 a Retainer, side mudguard, No.2
- 2 b Moulding, body rocker panel, RH/LH
- ▲ 3 c Tape, moulding, No.1

5-1-3 POINTS OF INSTALLATION

1. When using the body rocker panel molding again, peel off the tape that has already been affixed. Then, affix the tape along the scribing line shown in the illustration at the back of the body rocker panel molding.

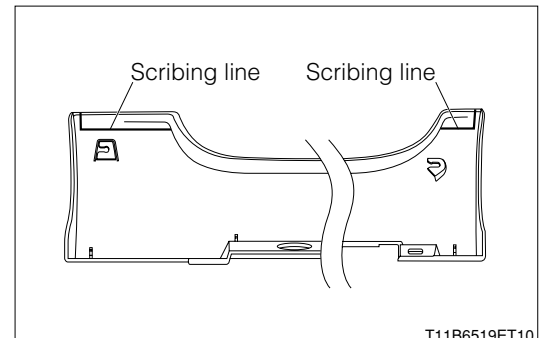

T11B6519ET10

6 ROOF END SPOILER

6-1 REMOVAL AND INSTALLATION

6-1-1 ARTICLES TO BE PREPARED

Tool

Clip remover

6-1-2 REMOVAL AND INSTALLATION PROCEDURES

(1) Components

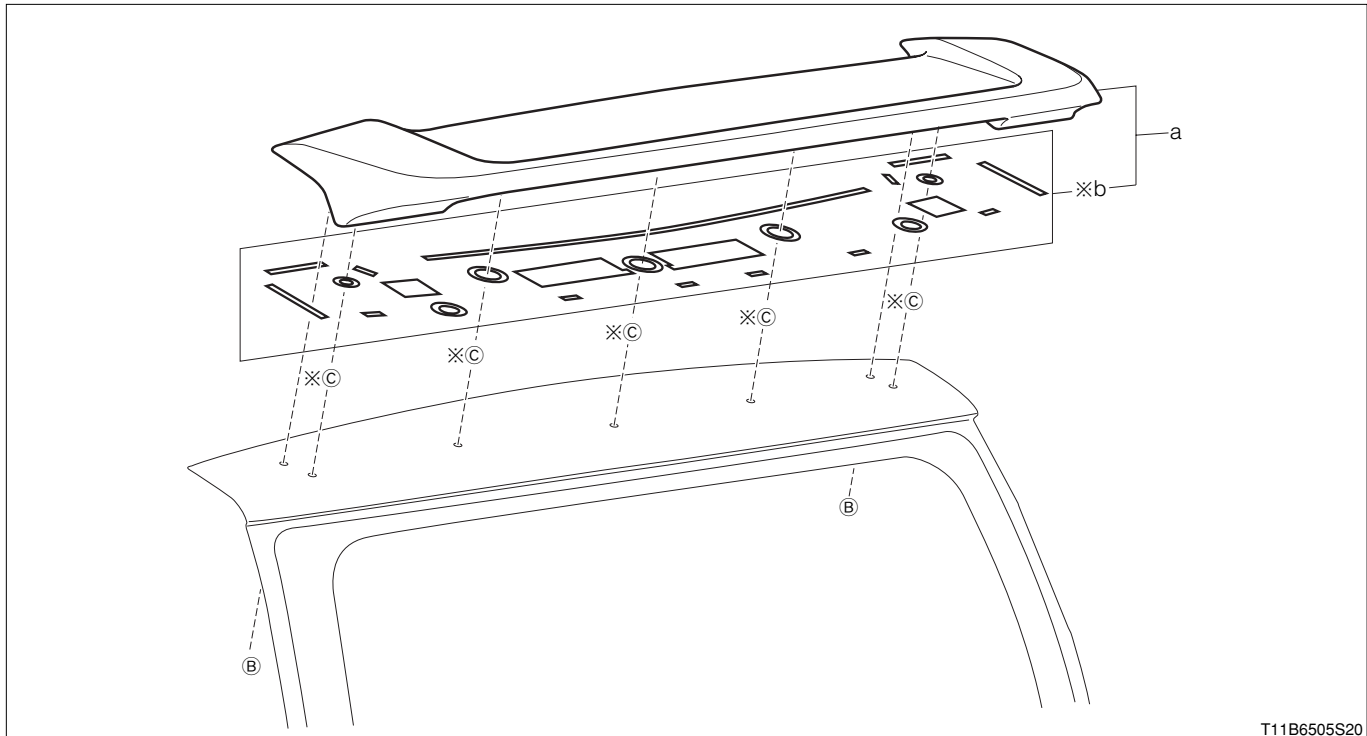

T11B6505S20

※:Non - reusable parts

(2) Removal and installation procedures

- 1 a Spoiler S/A, rear upper
- ▲ 2 b Seal, rear spoiler

6-1-3 POINTS OF INSTALLATION

1. When using the rear upper spoiler S/A again, peel off the seal that has already been affixed. Then, affix the seal along the scribing line shown in the illustration at the back of the rear upper spoiler S/A.

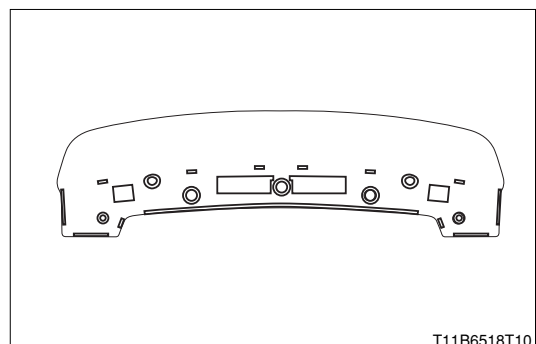

T11B6518T10

7 ROOF MOLDING

7-1 REMOVAL AND INSTALLATION

7-1-1 ARTICLES TO BE PREPARED

Lubricant, adhesive, others

Alcohol or white gasoline, Cemedine EP001

7-1-2 REMOVAL AND INSTALLATION PROCEDURES

(1) Components

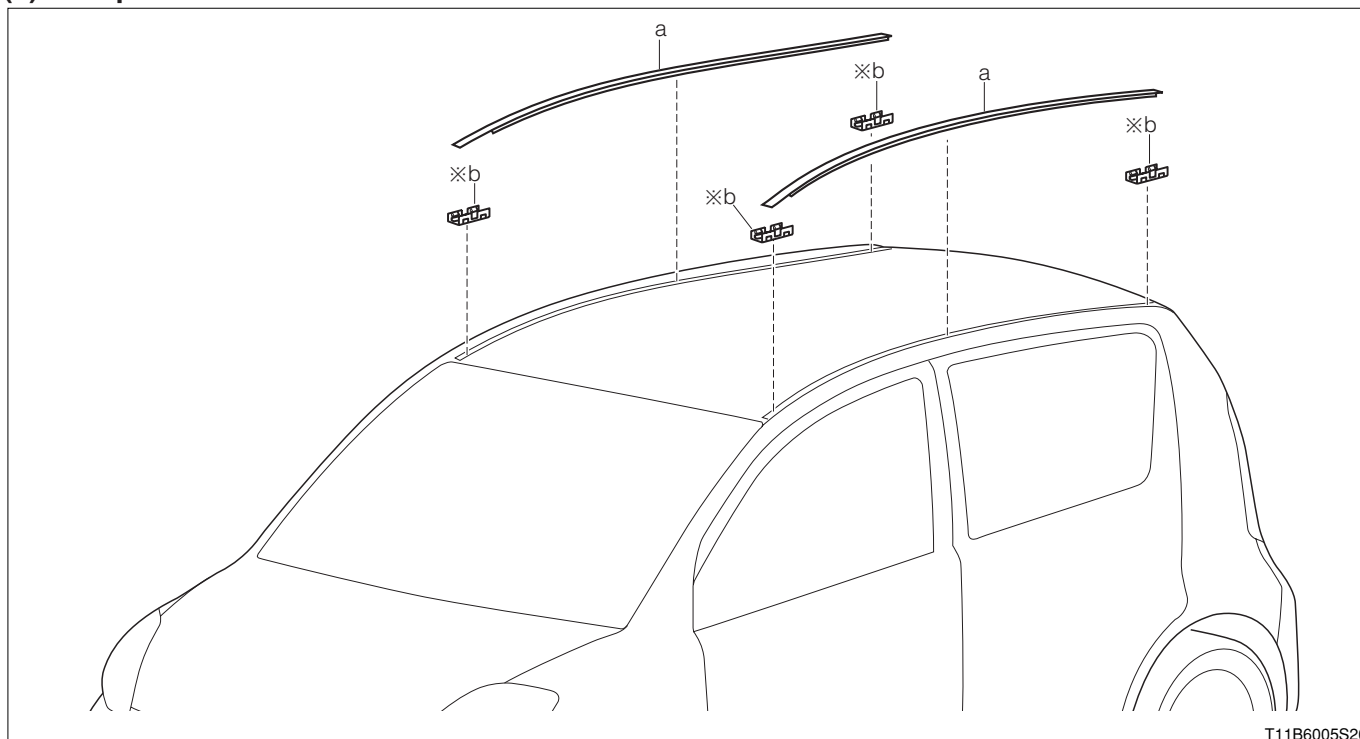

T11B6005S20

※:Non - reusable parts

(2) Removal and installation procedures

- ▼ 1 a Moulding, roof drip side, RH
- ▼ ▲ 2 b Clip, roof drip side finish moulding

7-1-3 POINTS OF REMOVAL

(1) Moulding, roof drip side, RH

1. Disengage the fitting of the roof drip side finish moulding clip, and remove the moulding.

(2) Clip, roof drip side finish moulding

1. Remove using tools such as a flat screw driver.

CAUTION

- Do not damage the body.

NOTE

- If the tape is hard and difficult to remove, heat up the tape (needs to be lower than 80°C) to soften it for easy removal.

2. Remove the remaining tape without damaging the body.

7-1-4 POINTS OF INSTALLATION

(1) Clip, roof drip side finish moulding

1. Clean up the sealed side.

LUBRICANT: Alcohol or white gasoline

2. Put adhesive material and hardener at the ratio of 1 to 1 in a plastic bag and mix them until the clear adhesive material becomes milky white.

CAUTION

- Note that incorrect ratio of the adhesive material and hardener impairs adhesiveness.
- Note that unevenly mixed material could cause a hardening problem.
- Spread the material within 20 minutes after mixing.

ADHESIVE: Cemedine EP001

3. Spread the adhesive material on the clip whose thickness shall be thicker than 0.5mm.

SPECIFIED VALUE: The adhesive material comes out at the sides of the clips when pressed down hard.

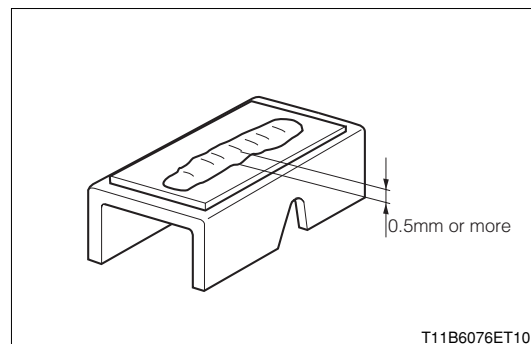

4. Press the clips on the exact places indicated in the figure below.

CAUTION

- Do not touch the sealed side with fingers.
- Note that no oil, water or dust shall be in the material.
- Press the tape onto the body evenly.
- Pressed at right angles to the body.

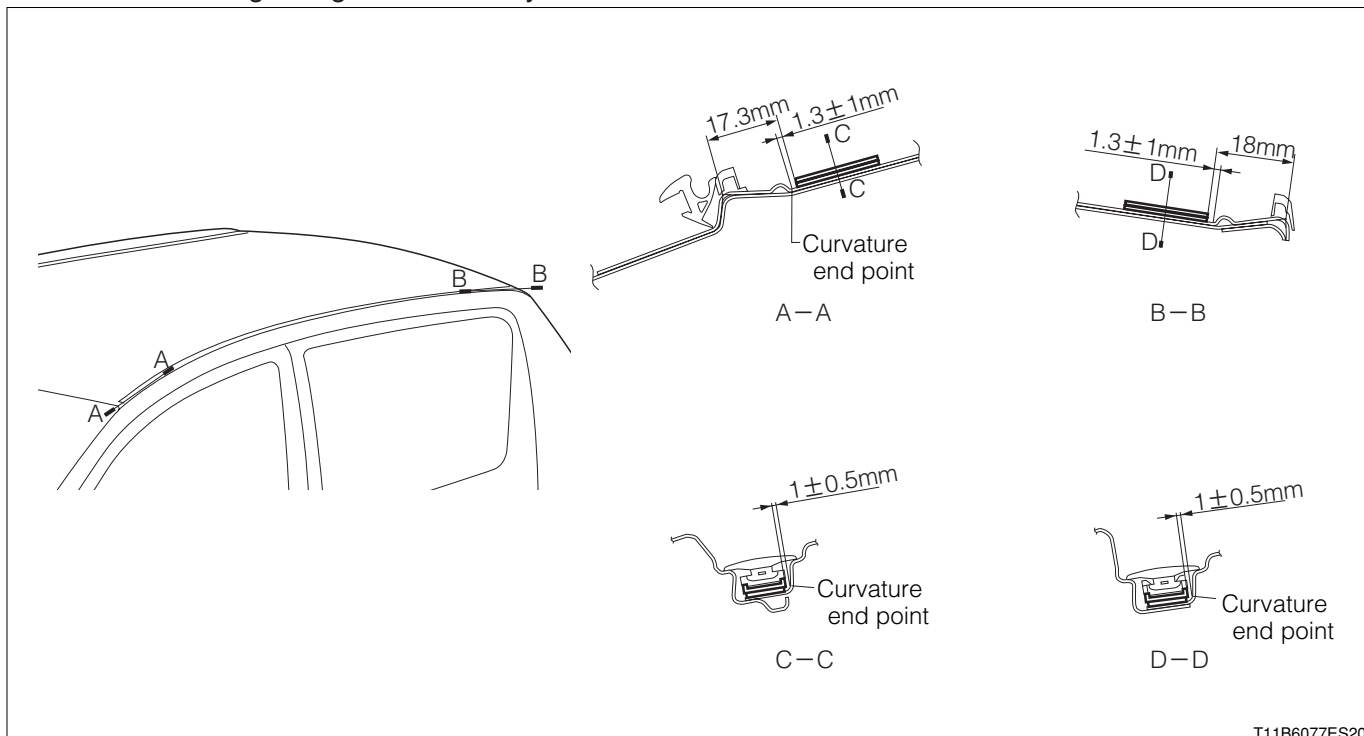

5. Let the adhesive material harden.

CAUTION

- Do not touch until the material hardens.

NOTE

- Warming up (lower than 80°C) accelerates the hardening procedure.

Let it sit.	Longer than 3 hours at a room temperature.
Heat up.	Longer than 30 minutes at 80°C.

6. Remove/install the RH roof drip side moulding to ensure the clips stay firmly.

I2-15

8 BLACKOUT TAPES(FRONT DOOR)

8-1 REMOVAL AND INSTALLATION

8-1-1 ARTICLES TO BE PREPARED

Tool

Rubber spatula

Lubricant,adhesive,others

Spray,Dryer,Soap water,Cloth

8-1-2 OPERATION BEFORE REMOVAL

1.Remove the front door window outer weather-strip.

Refer to Page I1-11.

2.Remove the front door glass run RH/LH.

Refer to Page I1-11.

8-1-3 REMOVAL AND INSTALLATION PROCEDURES

(1) Components

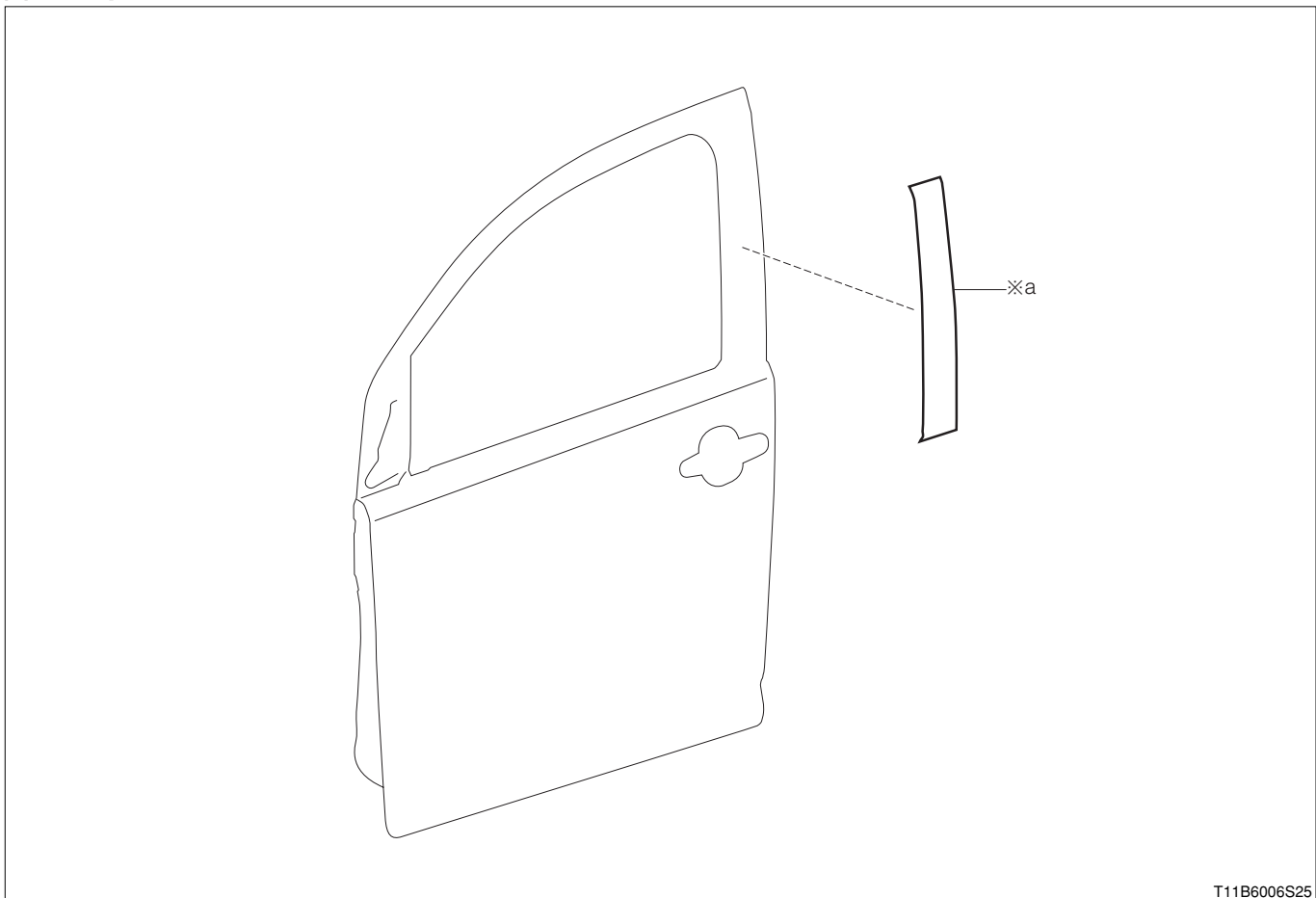

T11B6006S25

※:Non - reusable parts

(2) Removal and installation procedures

▼ ▲ 1 a Tape, black out, No.2 RH/LH

8-1-4 POINTS OF REMOVAL**(1) Tape, black out, No.2 RH/LH**

1. Take off the tape from the end slowly.

NOTE

- If the tape doesn't come off easily due to seizure, heat the tape by a drier for easy removal.

8-1-5 POINTS OF INSTALLATION**CAUTION**

- Work inside of the building where there is little wind and dust.
- Application operation shall be done at the temperature between 15 to 27°C.
- Warm up the tape and the door sash sealing side with a drier when the temperature is below 15°C.

(1) Tape, black out, No.2 RH/LH

1. With alcohol, clean off the application surface of the RH/LH front door panel S/A sash to remove dirt and foreign matters from there.

CAUTION

- Anything left on the sealing side when taping will cause weak adhesiveness and external defects such as spots. Therefore, be sure to wipe off dirt.

2. Wrap a spatula with cloth.

NOTE

- A spatula wrapped with cloth gives smooth strokes, thus improving workability.

3. Mix tap water and mild liquid detergent at the ratio of 100 to 1, and spray it evenly onto the applying surface of the RH/LH front door panel S/A sash.

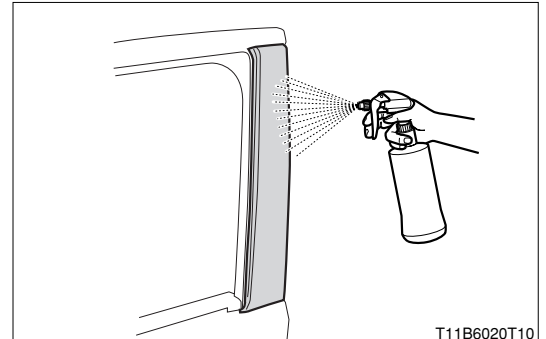

4. Cut out the marked area in the figure on the right.
5. Remove the backing sheet on the top end of the tape.

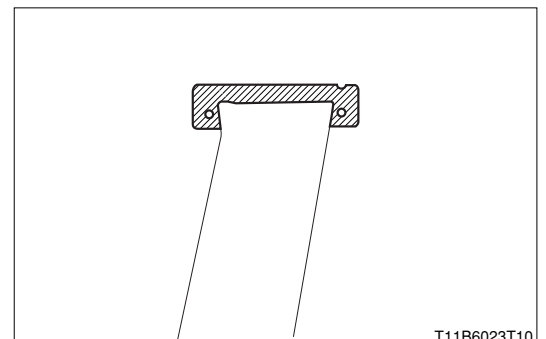

I2-17

6. Place the cut-out of the tape onto the end of curvature of the RH/LH front door panel S/A sash, and paste it temporarily.

CAUTION

- The tape is temporarily pasted parallel to the RH/LH front door panel S/A sash.
- Ensure that there is about 4.5mm of roll-in length behind the vehicle.

7. Check the taping position.

8. Press and paste with the spatula on curvature section (2 locations).

9. After application, push out the water with the spatula and press it down hard.

CAUTION

- Ensure to push out all water from between the tape and the RH/LH front door panel S/A sash, for any remaining water will cause spots later.

10. With a spatula, make a fold on the tape roll-in portions at both sides of the RH/LH front door panel S/A sash.

11. Lightly warm up the tape roll-in portion with a drier, and fold it with fingers.

12. Press the entire tape hard and let it dry after wiping off water.

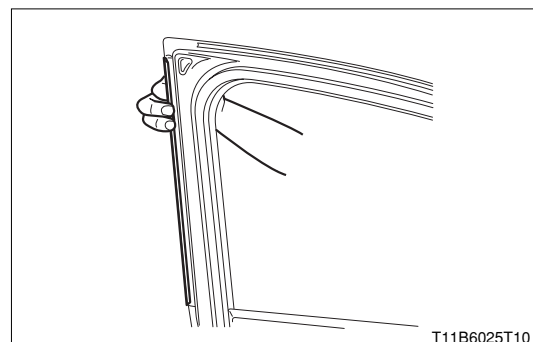
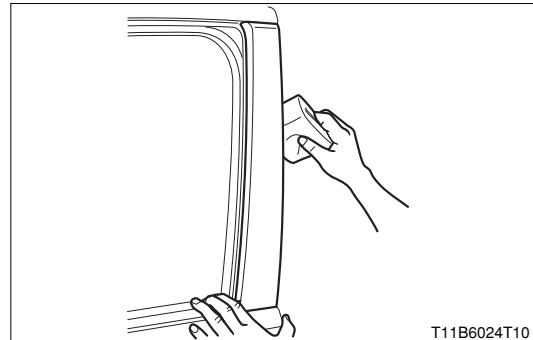
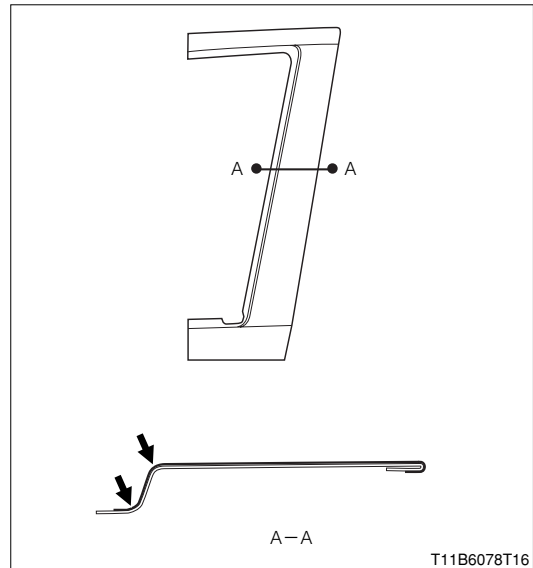
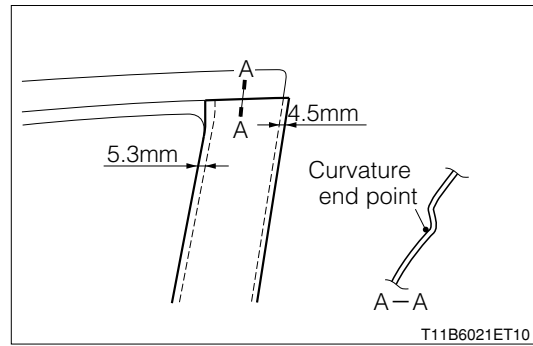

8-1-6 OPERATION AFTER INSTALLATION

1. Install the front door glass run RH/LH.

Refer to Page I1-11.

2. Install the front door window outer weather-strip.

Refer to Page I1-11.

I2-19

9 BLACKOUT TAPES(REAR DOOR)

9-1 REMOVAL AND INSTALLATION

9-1-1 ARTICLES TO BE PREPARED

Tool

Rubber spatula

Lubricant,adhesive,others

Spray,Dryer,Soap water,Cloth

9-1-2 OPERATION BEFORE REMOVAL

1.Remove the rear door window outer weather-strip.

Refer to Page I1-18.

2.Remove the rear door glass run RH/LH.

Refer to Page I1-18.

9-1-3 REMOVAL AND INSTALLATION PROCEDURES

(1) Components

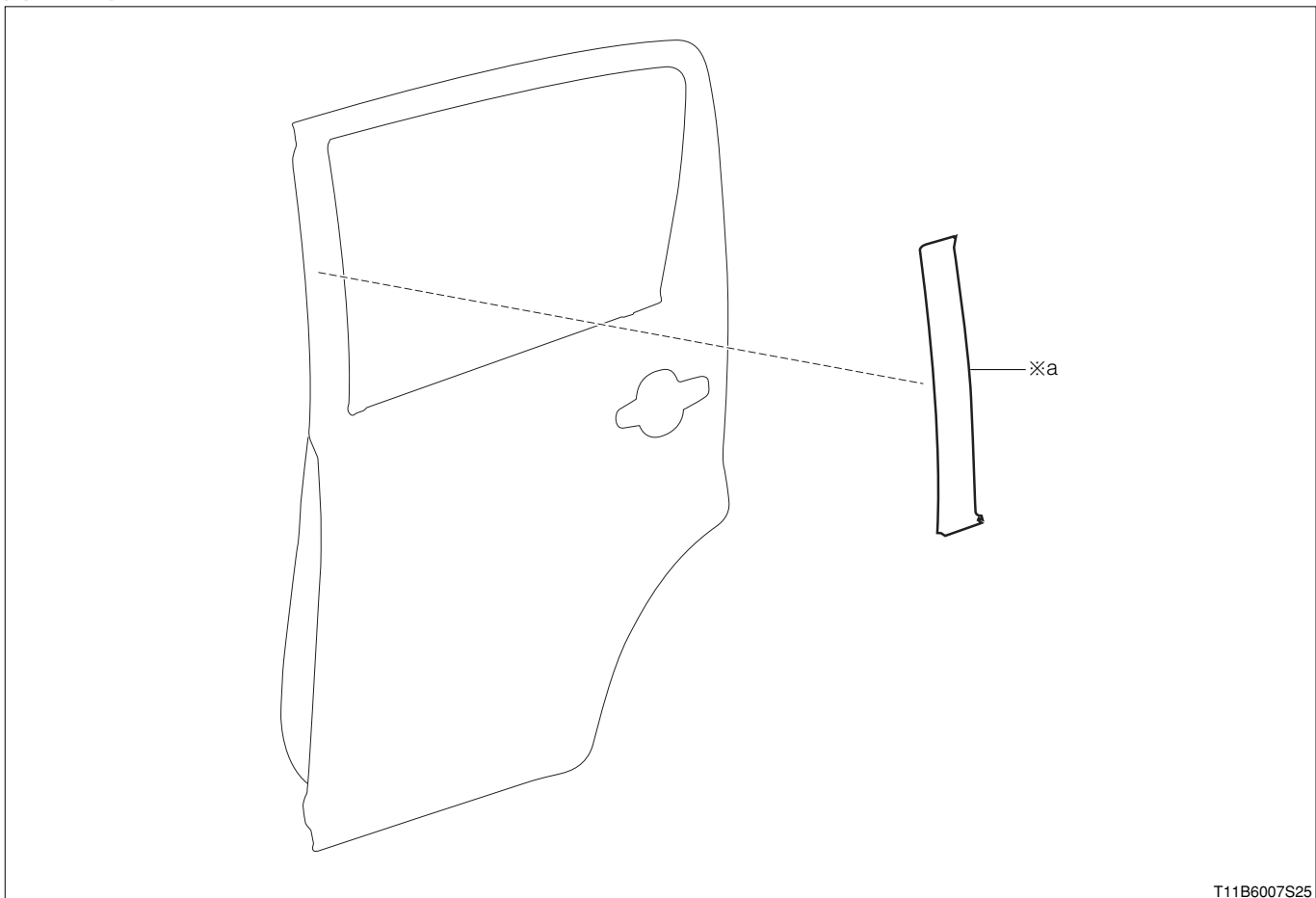

T11B6007S25

※:Non - reusable parts

(2) Removal and installation procedures

▼ ▲ 1 a Tape, black out, No.3 RH/LH

9-1-4 POINTS OF REMOVAL

(1) Tape, black out, No.3 RH/LH

1. Take off the tape from the end slowly.

NOTE

- If the tape doesn't come off easily due to seizure, heat the tape by a drier for easy removal.

9-1-5 POINTS OF INSTALLATION

CAUTION

- Work inside of the building where there is little wind and dust.
- Tape application shall be done at the temperature between 15 to 27°C.
- Warm up the tape and the door sash sealing surface with a drier when the temperature is below 15°C.

(1) Tape, black out, No.3 RH/LH

1. With alcohol, clean off the application surface of the RH/LH rear door panel S/A sash to remove dirt and foreign matters from there.

CAUTION

- Anything left on the sealing side when taping will cause weak adhesiveness and external defects such as spots. Therefore, be sure to wipe off dirt.

2. Wrap a spatula with cloth.

NOTE

- A spatula wrapped with cloth gives smooth strokes, thus improving workability.

3. Mix tap water and mild liquid detergent at the ratio of 100 to 1, and spray it evenly onto the applying surface of the RH/LH rear door panel S/A sash.

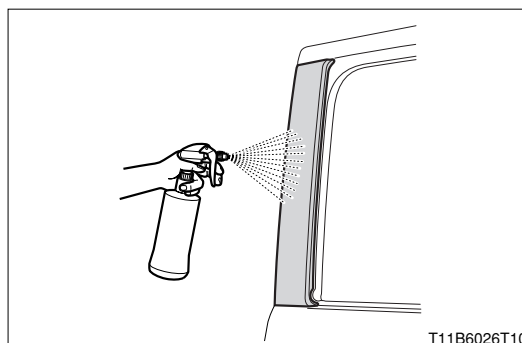

4. Cut out the marked area in the figure on the right.
5. Remove the backing sheet on the top end of the tape.

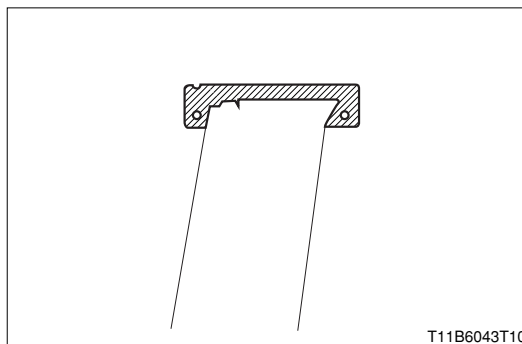

6. Place the cut-out of the tape onto the end of curvature of the RH/LH rear door panel S/A sash, and paste it temporarily.

CAUTION

- The tape is temporarily pasted parallel to the RH/LH rear door panel S/A sash.
- Check that there is approx. 13.5mm of roll-in length for the left side.

7. Check the taping position.

8. Press and paste with the spatula on the curvature section (4 locations).

9. After taping, push out the water with the spatula.

CAUTION

- Paste parallel to the RH/LH rear door panel S/A sash.

10. Check the taping position.

11. After taping, push out the water with the spatula.

CAUTION

- Ensure to push out all water from between the tape and the RH/LH rear door panel S/A sash, for any remaining water will cause spots later.

12. With a spatula, make a fold on the tape roll-in portions.

13. Lightly warm up the tape roll-in portion with a drier, and fold it with fingers.

14. Press the entire tape hard and let it dry after wiping off water.

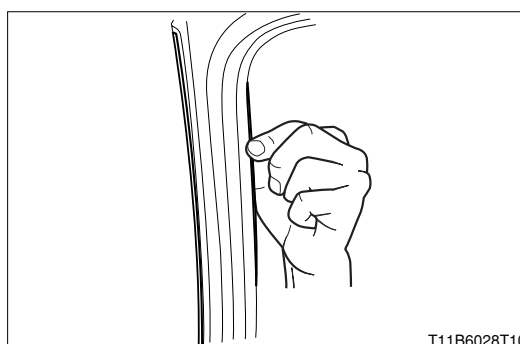
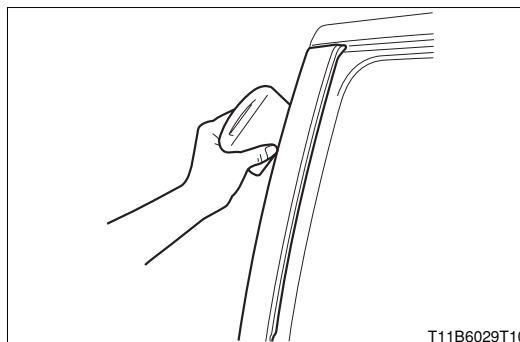
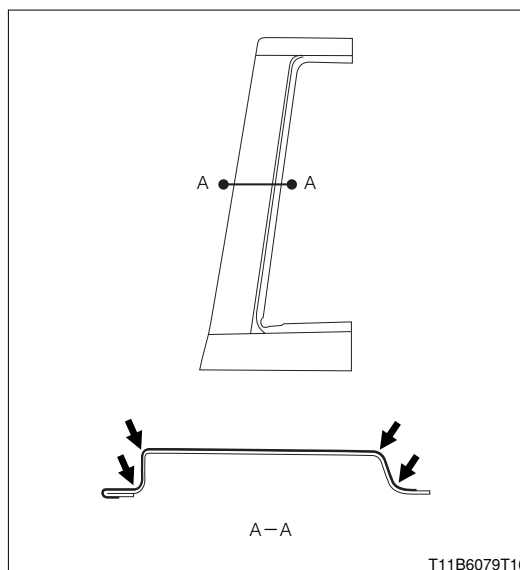
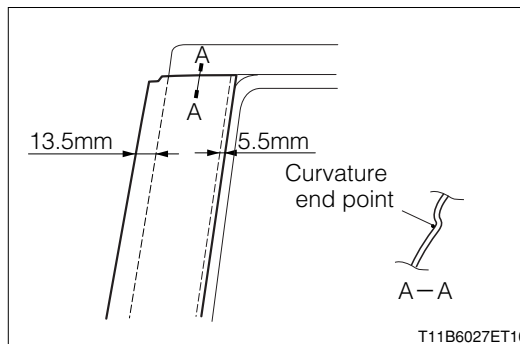

9-1-6 OPERATION AFTER INSTALLATION

1. Install the rear door glass run RH/LH.

Refer to Page I1-18.

2. Install the rear door window outer weather-strip.

Refer to Page I1-18.

10 INSTRUMENT PANEL

10-1 REMOVAL AND INSTALLATION

CAUTION

- Refer to the precaution on maintenance for SRS airbag system.

Refer to Page A1-26.

10-1-1 ARTICLES TO BE PREPARED

Tool

Clip remover

10-1-2 OPERATION BEFORE REMOVAL

- 1.Remove the battery negative (－) terminal.
- 2.Remove the front pillar garnish RH/LH.
Refer to Page I2-48.

- 3.Remove the cowl side trim board RH/LH.
Refer to Page I2-48.

10-1-3 REMOVAL AND INSTALLATION PROCEDURES

(1) Components

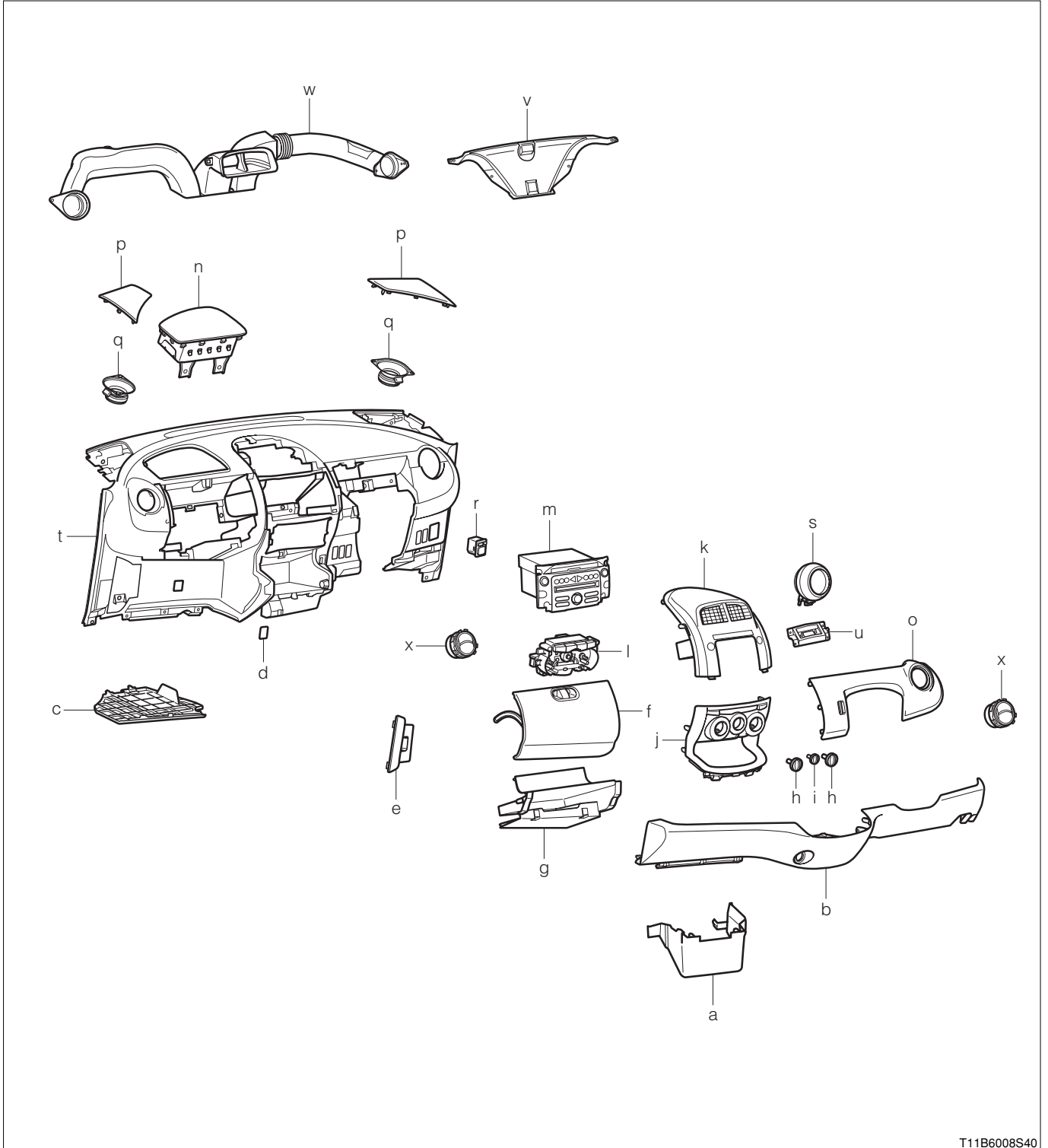

T11B6008S40

The illustration shows a typical example.

(2) Removal and installation procedures

- | | |
|---|--|
| ▼ 1 a Panel, console | ▼ ▲ 13 m Receiver Ay, radio |
| ▼ 2 b Panel S/A, instrument panel finish, lower | ▼ ▲ 14 n Airbag Ay, instrument panel passenger |
| ▼ 3 c Cover, instrument panel under, No.1 | ▼ ▲ 15 o Panel, instrument cluster finish |
| ▼ 4 d Cover, instrument, lower | ▼ 16 p Grille, speaker, RH/LH |
| ▼ 5 e Cover, fuse box opening | ▲ 17 q Speaker Ay, radio |
| ▼ 6 f Door, instrument panel | 18 r Switch Ay, outer mirror |
| ▼ 7 g Box Ay, instrument panel, No.1 | ▼ 19 s Tachometer Ay, engine |
| 8 h Knob S/A, control | ▼ 20 t Panel, instrument |
| 9 i Knob S/A, control | ▼ 21 u Bracket, accessory meter |
| ▼ 10 j Panel S/A, instrument cluster finish, lower center | ▼ 22 v Nozzle Ay, defroster |
| ▼ 11 k Panel S/A, instrument cluster finish, center | ▼ 23 w Duct S/A, heater to register, center |
| ▼ ▲ 12 l Control Ay, heater | ▼ 24 x Register Ay, instrument panel, No.1 |

10-1-4 POINTS OF REMOVAL

(1) Panel, console

1. Disengage the pawls indicated in the right figure and remove the panel.

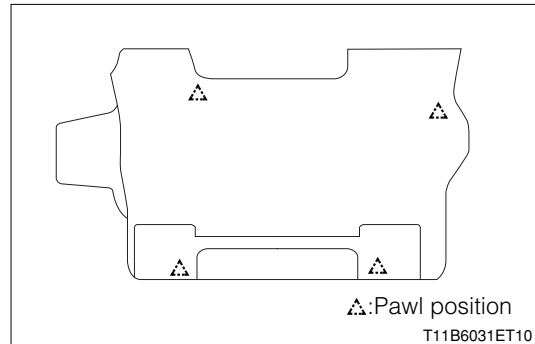

(2) Panel, instrument panel finish, lower

1. Remove the screws. (RHD vehicle: 6 points, LHD vehicle: 5 points)
2. Remove the clips (3 locations).
3. Disengage the pawls indicated in the figure below and remove.

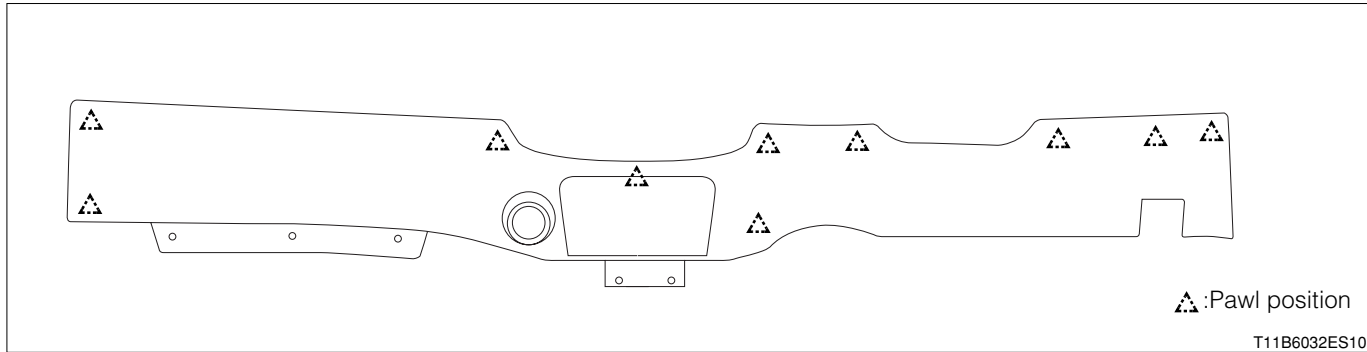

(3) Cover, instrument panel under, No.1

1. Disengage the pawls indicated in the right figure and remove the cover.

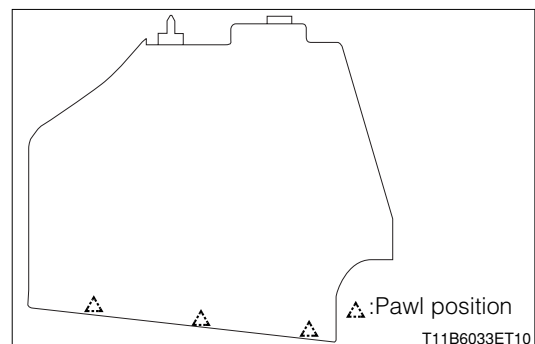

(4) Cover, instrument, lower

1. Disengage the pawls indicated in the right figure and remove the cover.

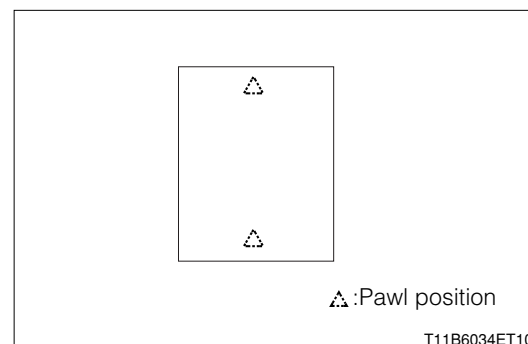
**(5) Cover, fuse box opening****① RHD vehicles**

1. Disengage the pawls indicated in the right figure and remove the cover.

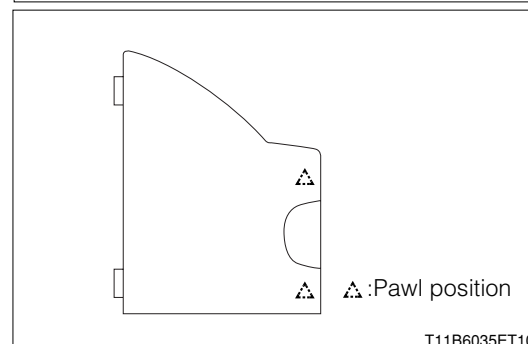
**② LHD vehicles**

1. Disengage the pawls indicated in the right figure and remove the cover.

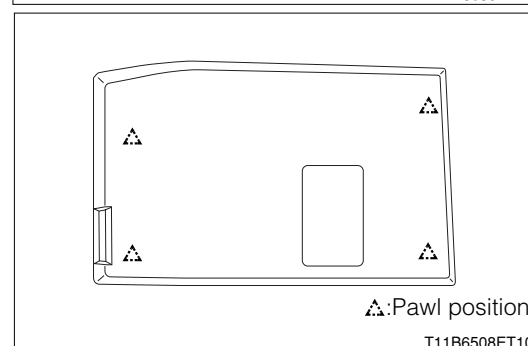
**(6) Door, instrument panel**

1. Open the door fully and then close approx. 10mm from the full open position. While pushing up the right and left door arm sections together, remove them through the instrument panel holes.

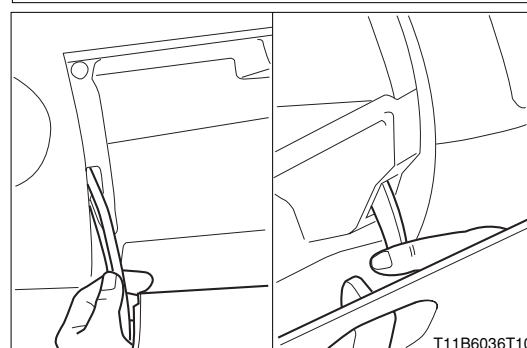
**(7) Box, instrument panel, No.1**

1. Disengage the pawls indicated in the right figure and remove the box.

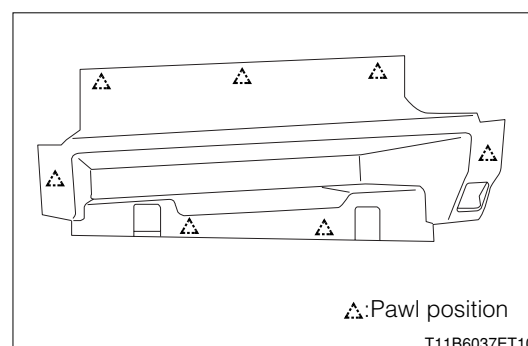
**(8) Panel S/A, instrument cluster finish, lower center**

1. Remove the screws (4 locations).

2. Disengage the pawls indicated in the right figure and remove the panel S/A.

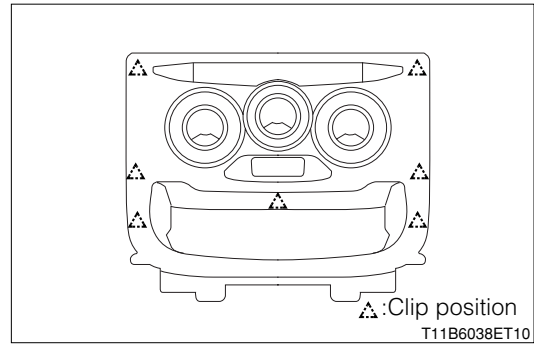

(9) Panel S/A, instrument cluster finish, center

1. Disengage the pawls indicated in the right figure and remove the panel S/A.

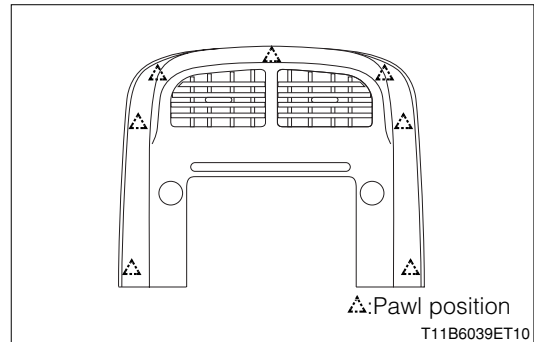

(10) Control Ay, heater

Refer to Page K1-7.

(11) Receiver Ay, radio

Refer to Page J4-1.

(12) Airbag Ay, instrument panel passenger

Refer to Page H1-11.

(13) Panel, instrument cluster finish

1. Disengage the pawls in the sequence of d→e→f→c→b→a→g→h→i→j, and remove the panel.

CAUTION

- Failure to follow the sequence will break the panel.

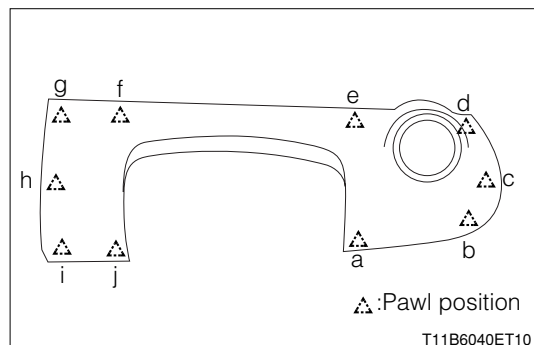

(14) Grille, speaker, RH/LH

1. Disengage the pawls indicated in the right figure and remove it.

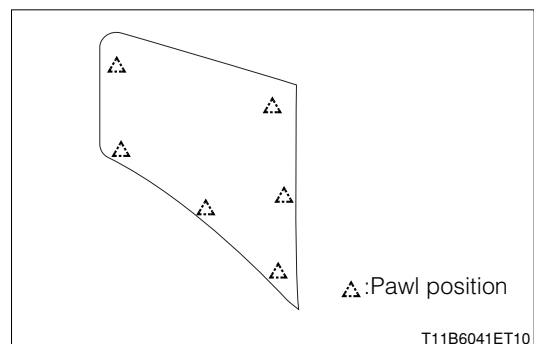

(15) Tachometer Ay, engine

Refer to Page J3-4.

(16) Panel, instrument

1.Remove the electric power steering column Ay from the instrument panel reinforcement S/A.

Refer to Page G1-5.

2.Remove the front door front lower frame subassembly by removing the bolts at the positions indicated in the figure below.

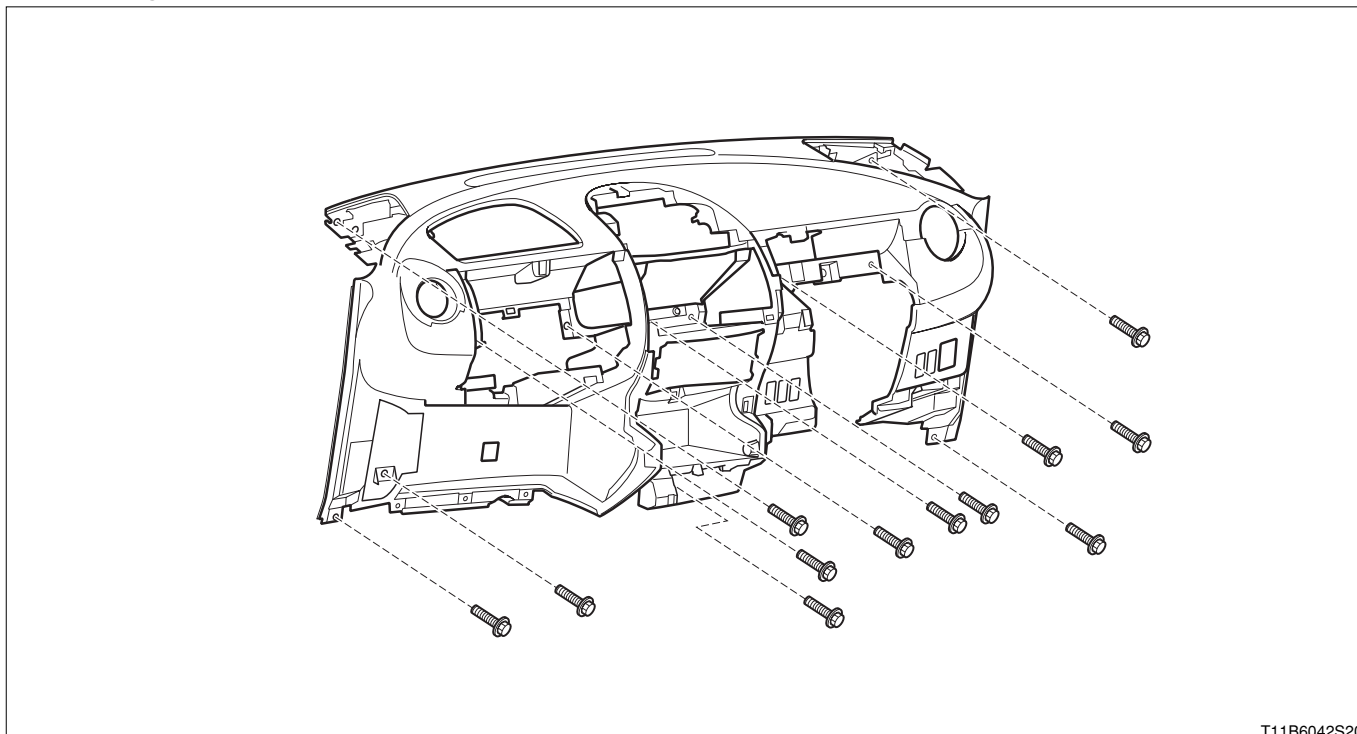

T11B6042S20

(17) Bracket, accessory meter

Refer to Page J3-4.

(18) Nozzle Ay, defroster**① RHD vehicles**

1.Remove the screws (3 locations).

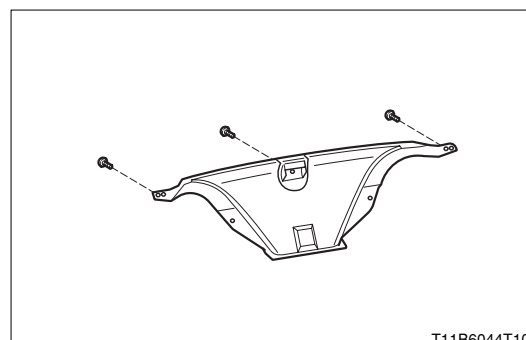

T11B6044T10

② LHD vehicles

1.Remove the screws (5 locations).

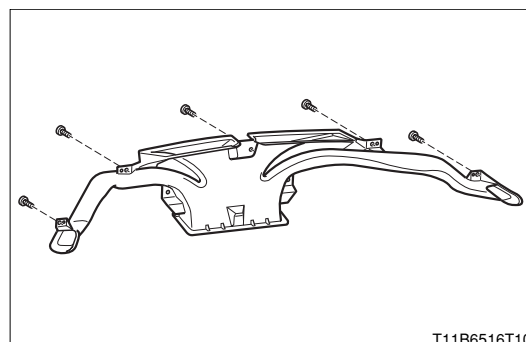

T11B6516T10

(19) Duct S/A, heater to register, center

1. Remove the screws (3 locations).

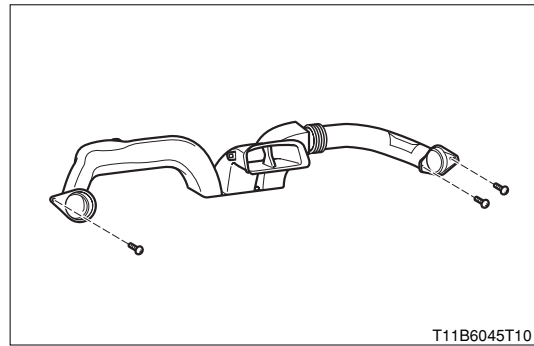

(20) Register Ay, instrument panel, No.1

1. Disengage the pawls indicated in the right figure and remove the register Ay.

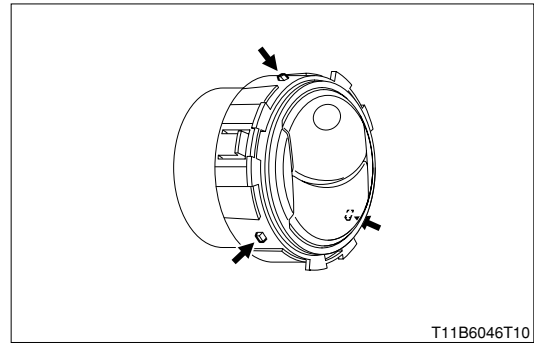

10-1-5 POINTS OF INSTALLATION

(1) Speaker Ay, radio

Refer to Page J4-3.

(2) Panel, instrument cluster finish

1. Engage the pawls indicated in the right figure in the sequence of j to a.

CAUTION

- Press the top part of the pawl to install.

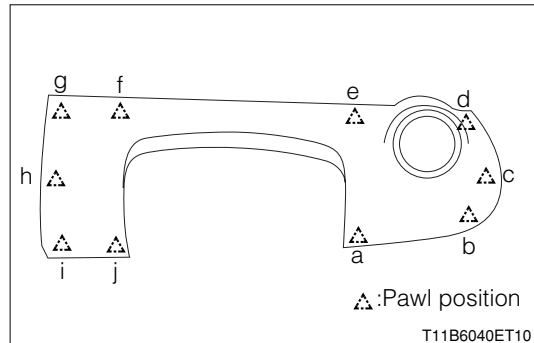

(3) Airbag Ay, instrument panel passenger

Refer to Page H1-11.

(4) Receiver Ay, radio

Refer to Page J4-1.

(5) Control Ay, heater

Refer to Page K1-7.

10-1-6 OPERATION AFTER INSTALLATION

1. Install the front pillar garnish RH/LH.
Refer to Page I2-48.
2. Install the cowl side trim board RH/LH.
Refer to Page I2-48.
3. Connect the battery negative (-) terminal.

11 REAR CONSOLE BOX 11-1 REMOVAL AND INSTALLATION

11-1-1 OPERATION BEFORE REMOVAL

1. Remove the shift lever knob S/A (M/T vehicle only)
Refer to Page F2-15.

11-1-2 REMOVAL AND INSTALLATION PROCEDURES

(1) Components

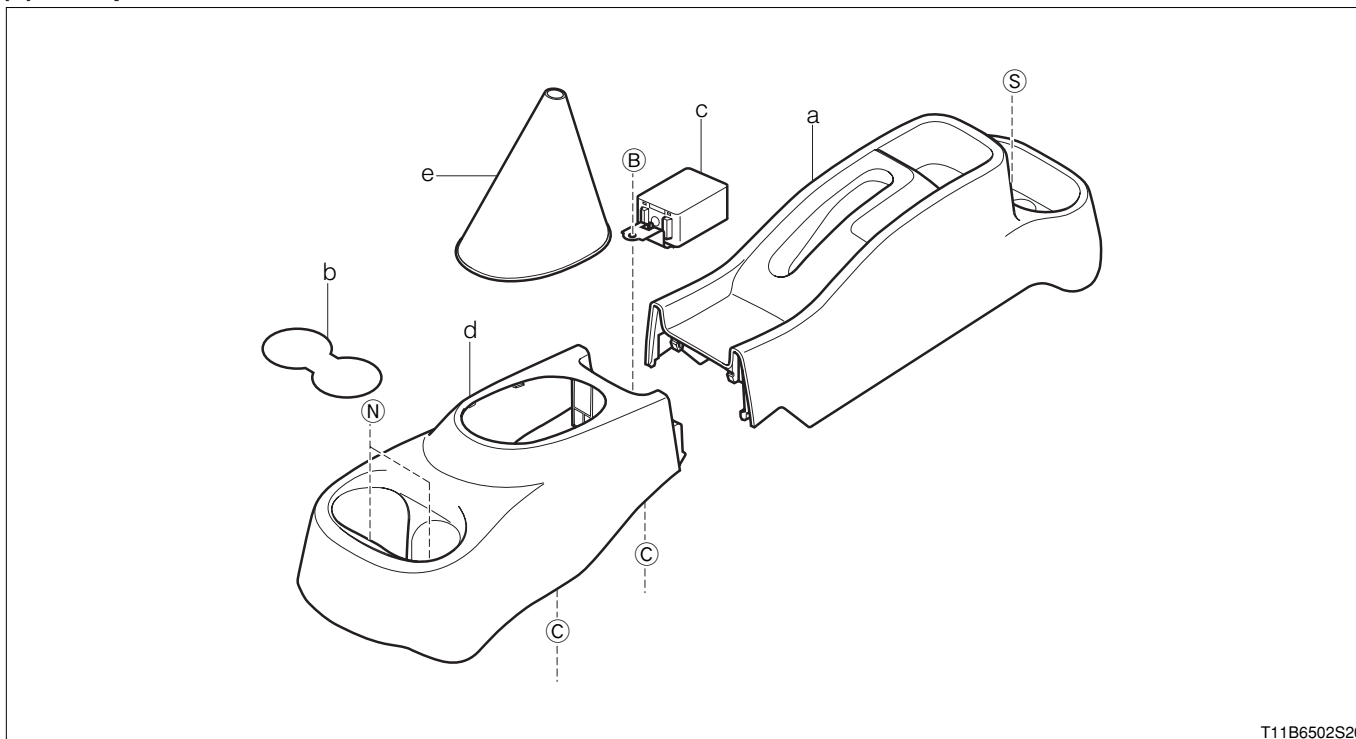

T11B6502S20

(2) Removal and installation procedures

- ▼ 1 a Box S/A, console, rear
- 2 b Carpet, console box
- 3 c Relay Ay, windshield wiper (not equipped for some specifications)
- 4 d Box S/A, console, front
- 5 e Cover Ay, shifting hole (M/T vehicle only)

11-1-3 POINTS OF REMOVAL

(1) Box S/A, console, rear

1. Pull the parking brake lever to provide a gap for moving the box S/A.
2. Disengage the pawls indicated in the right figure and lift the box S/A upward.

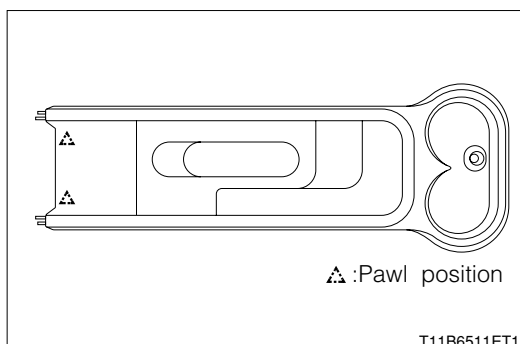

T11B6511ET10

3. Move the box S/A toward the rear of the vehicle.
Disengage it from the front console box S/A to remove.

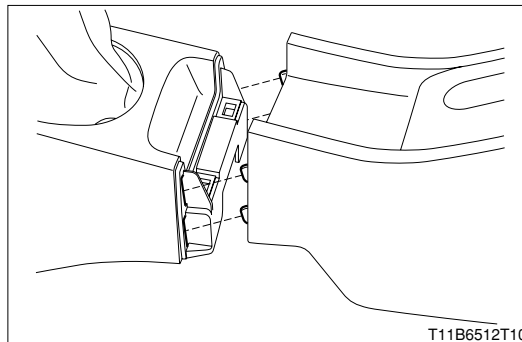

11-1-4 OPERATION AFTER INSTALLATION

1. Install the shift lever knob S/A (M/T vehicle only)
Refer to Page F2-15.

12 FRONT SEAT

12-1 REMOVAL AND INSTALLATION

CAUTION

- Refer to the precaution on checking procedure for SRS airbag system.

Refer to Page A1-26.

12-1-1 ARTICLES TO BE PREPARED

Instrument

Torque wrench

12-1-2 REMOVAL AND INSTALLATION PROCEDURES

(1) Components

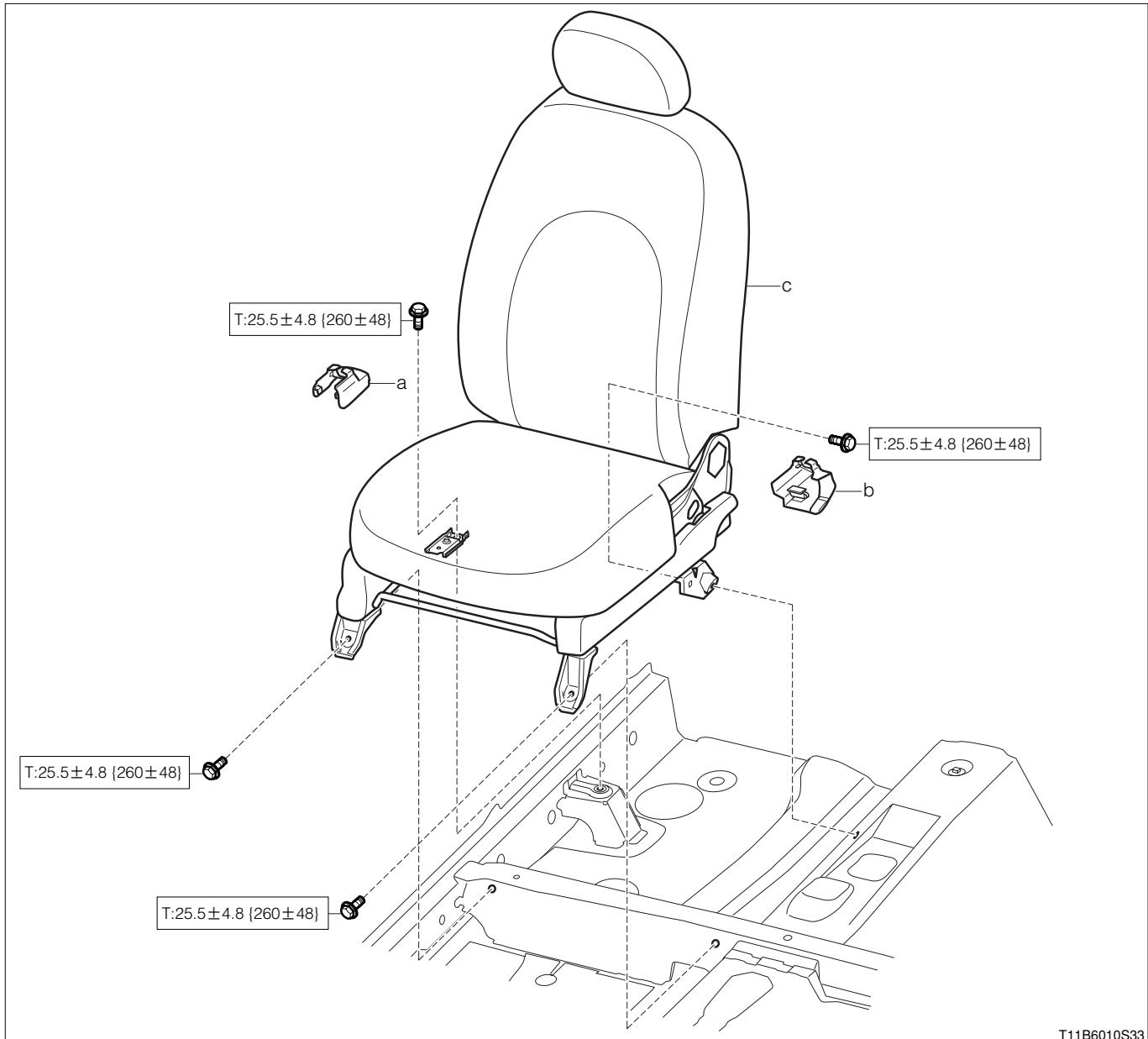

T11B6010S33

Unit:N·m{kgf·cm}

(2) Removal and installation procedures

- 1 a Cover, front seat leg
- 2 b Cover, front seat leg, LH
- ▲ 3 c Seat Ay, front RH/LH

12-1-3 POINTS OF INSTALLATION**(1) Seat Ay, front RH/LH**

1. Temporarily install the bolts a and b.
2. Slide the seat to the most forward position.
3. Tighten the bolts c and d.
4. Tighten the bolts a and b.

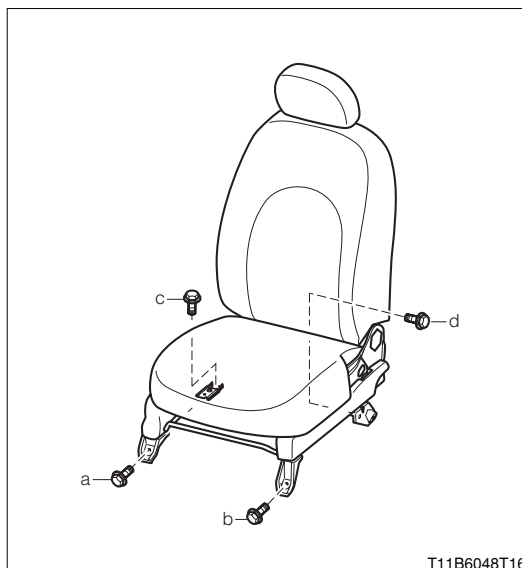

12-2 DISASSEMBLING AND ASSEMBLING

12-2-1 ARTICLES TO BE PREPARED

Instrument

Torque wrench

12-2-2 OPERATION BEFORE DISASSEMBLY

1. Remove the front seat Ay RH/LH.
Refer to Page I2-33.

12-2-3 DISASSEMBLY AND ASSEMBLY PROCEDURES

(1) Components

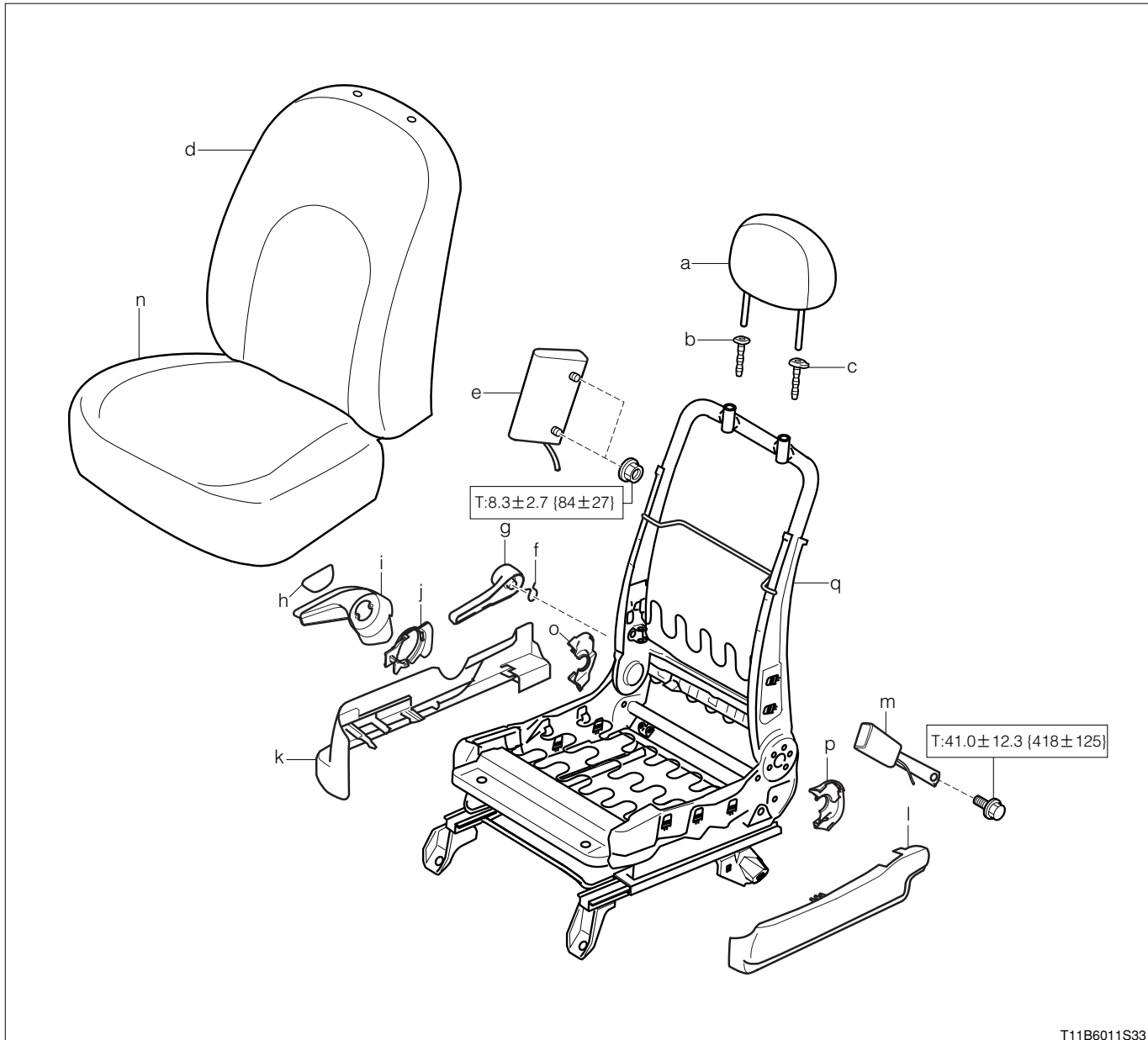

T11B6011S33

Unit: N · m { kgf · cm }

(2) Disassembling and assembling procedures

- | | | | | | |
|---|---|--|----|---|--------------------------------------|
| 1 | a | Headrest Ay, front seat | 10 | j | Spacer, vertical adjuster |
| ▼ | 2 | b Support, front seat headrest, RH | 11 | k | Shield, front seat cushion, RH |
| ▼ | 3 | c Support, front seat headrest, LH | 12 | l | Shield, front seat cushion, inner RH |
| | 4 | d Pad, front seat back w/cover, RH | 13 | m | Belt Ay, front seat, inner |
| | 5 | e Air bag Ay, front seat, RH | 14 | n | Pad S/A, front seat cushion, RH |
| | 6 | f Ring | 15 | o | Cover, seat hinge outer, RH |
| ▼ | 7 | g Handle, reclining adjuster release, RH | 16 | p | Cover, seat hinge inner, RH |
| | 8 | h Cover, vertical adjuster | 17 | q | Frame S/A, front seat w/adjuster, RH |
| | 9 | i Lever, vertical adjuster lock | | | |

12-2-4 POINTS OF DISASSEMBLY

(1) Support, front seat headrest, RH / Support Ay, front seat headrest, LH

- Put a hand from the bottom of the RH front seat back pad W/cover, and press the pawl to push off the support Ay.

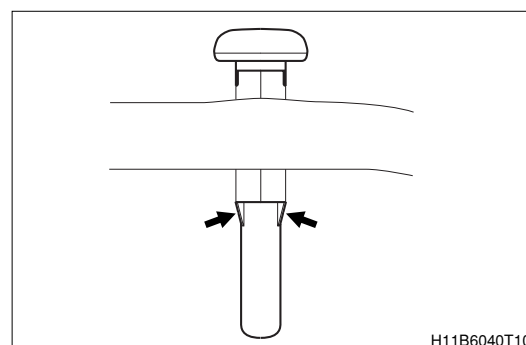

(2) Handle, reclining adjuster release, RH

- Press the ring and disengage the fitting with the RH front seat frame Ay W/adjuster.
- Remove with a flat screwdriver while pressing the ring.

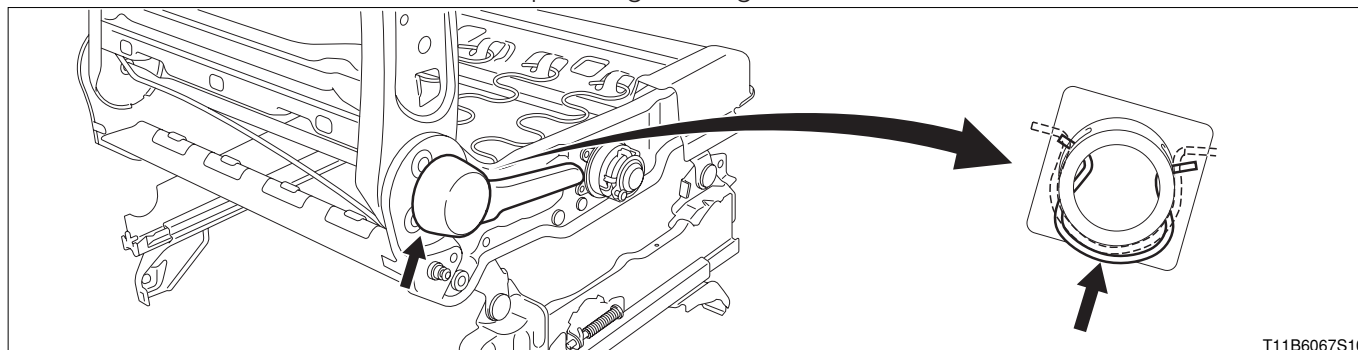

12-2-5 OPERATION AFTER ASSEMBLY

- Install the front seat Ay RH/LH.
Refer to Page I2-33.

13 REAR SEAT

13-1 REMOVAL AND INSTALLATION

13-1-1 ARTICLES TO BE PREPARED

Instrument

Torque wrench

13-1-2 REMOVAL AND INSTALLATION PROCEDURES

(1) Components

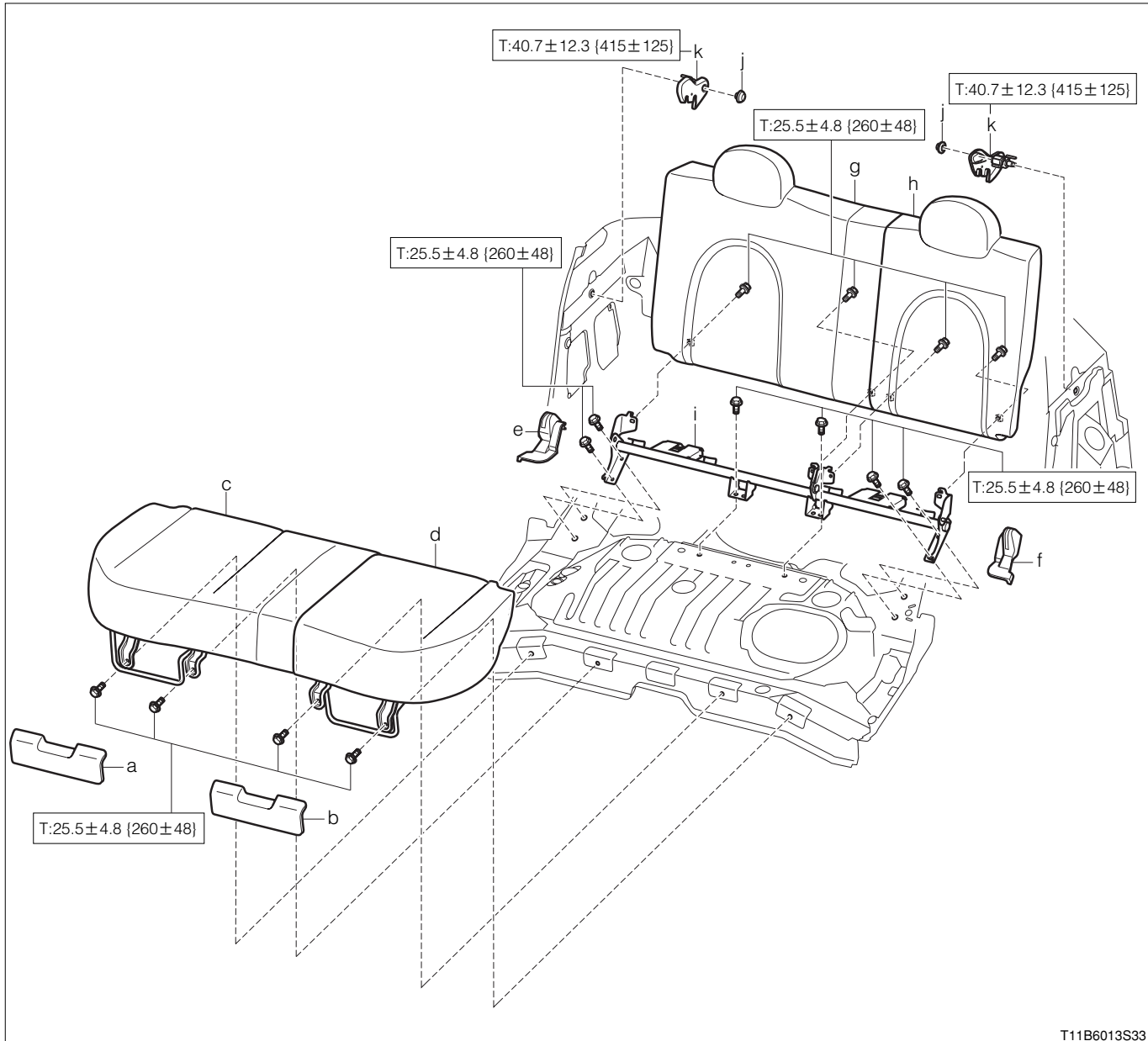

T11B6013S33

Unit:N·m{kgf·cm}

(2) Removal and installation procedures

- | | | | | | |
|---|---|----------------------------|-----|---|---------------------------------|
| 1 | a | Leg S/A, rear seat cushion | 7 | g | Back Ay, rear seat, RH |
| 2 | b | Leg S/A, rear seat cushion | 8 | h | Back Ay, rear seat, LH |
| 3 | c | Cushion Ay, rear seat, RH | ▲ 9 | i | Bracket S/A, CRS anchor |
| 4 | d | Cushion Ay, rear seat, LH | 10 | j | Cap |
| 5 | e | Cover, rear seat hinge | 11 | k | Lock S/A, rear seat back, RH/LH |
| 6 | f | Cover, rear seat hinge, LH | | | |

13-1-3 POINTS OF INSTALLATION

(1) Bracket S/A, CRS anchor

1. Tighten the bolts in the sequence of a to f.

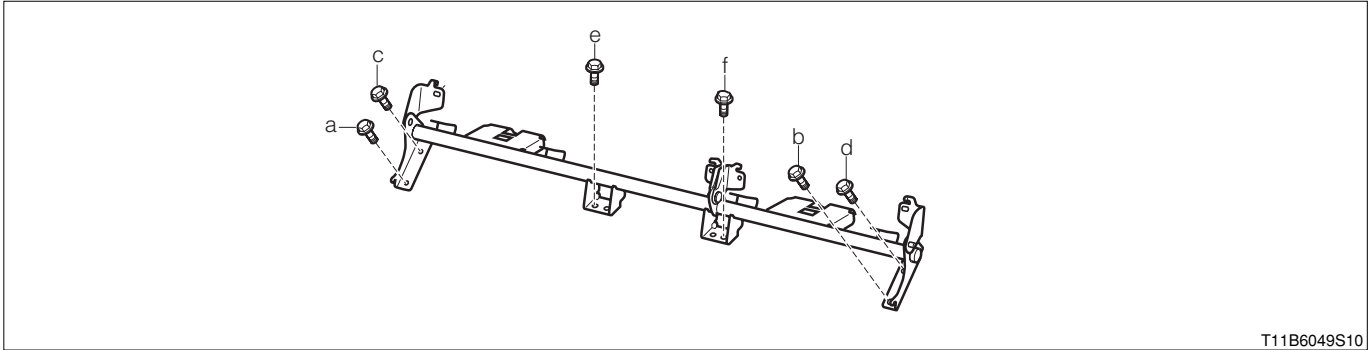

T11B6049S10

(2) Disassembling and assembling procedures

- | | | |
|---|---|--|
| 1 a Headrest Ay, rear seat | ▼ | 14 b Support, front seat headrest, RH |
| ▼ 2 b Support, front seat headrest, RH | ▼ | 15 c Support Ay, front seat headrest, LH |
| ▼ 3 c Support Ay, front seat headrest, LH | ▼ | 16 l Pad S/A, rear seat back, LH |
| ▲ 4 d Ring, hog small | | 17 m Frame S/A, rear seat back, LH |
| ▼ 5 e Pad S/A, rear seat back, RH | ▲ | 18 d Ring, hog small |
| 6 f Frame S/A, rear seat back, RH | | 19 g Ring, E |
| ▲ 7 d Ring, hog small | | 20 h Leg S/A, rear seat cushion |
| 8 g Ring, E | | 21 i Bush |
| 9 h Leg S/A, rear seat cushion | ▼ | 22 n Pad S/A, rear seat cushion, LH |
| 10 i Bush | | 23 o Frame S/A, rear seat cushion, LH |
| ▼ 11 j Pad S/A, rear seat cushion, RH | ▲ | 24 d Ring, hog small |
| 12 k Frame S/A, rear seat cushion, RH | | 25 p Lock S/A, rear seat turn |
| 13 a Headrest Ay, rear seat | | |

13-2-3 POINTS OF DISASSEMBLY**(1) Support, front seat headrest, RH / Support Ay, front seat headrest, LH**

- Put a hand from the bottom of the RH/LH rear seat back pad S/A, and press the pawls to push out the support.

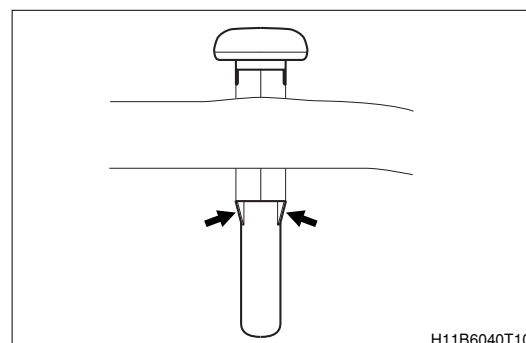
**(2) Pad S/A, rear seat back, RH**

- Take off the small hog rings indicated in the figure, and remove the pad S/A from the RH rear seat back frame S/A.

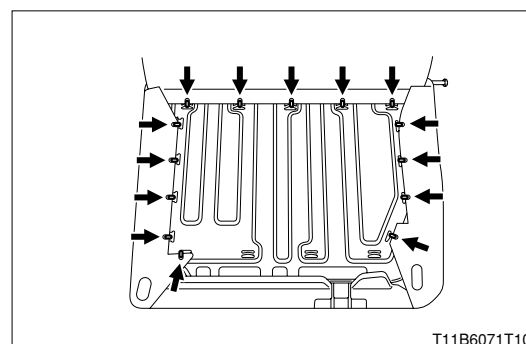
**(3) Pad S/A, rear seat cushion, RH**

- Take off the small hog rings indicated in the figure, and remove pad S/A from the RH rear seat cushion frame S/A.

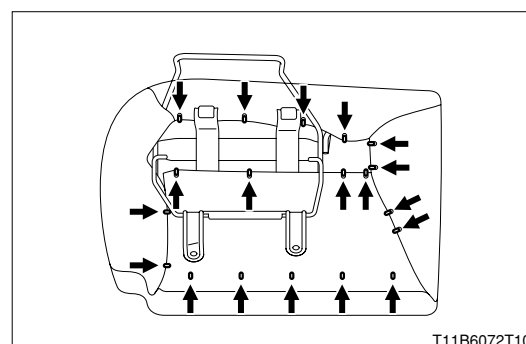

I2-41

(4) Pad S/A, rear seat back, LH

1. Take off the small hog rings indicated in the figure, and remove the pad S/A from the LH rear seat back frame S/A.

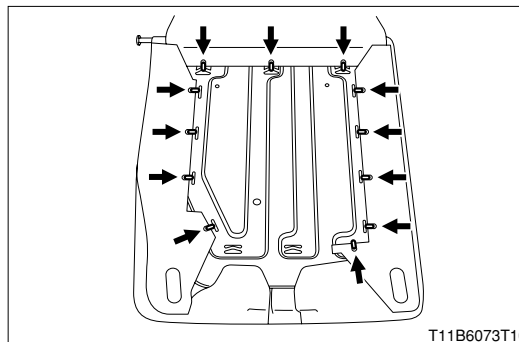

(5) Pad S/A, rear seat cushion, LH

1. Take off the small hog rings indicated in the figure, and remove the pad S/A from the LH rear seat cushion frame S/A.

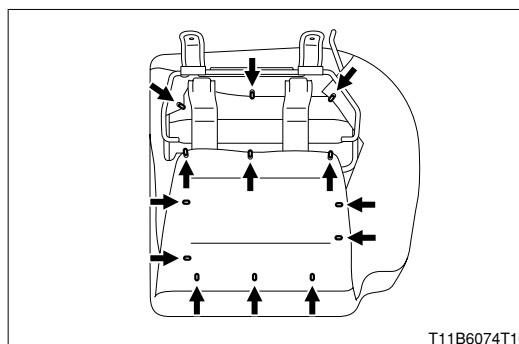

13-2-4 POINTS OF ASSEMBLY

(1) Ring, hog small

1. Install the ring as indicated in the figure.

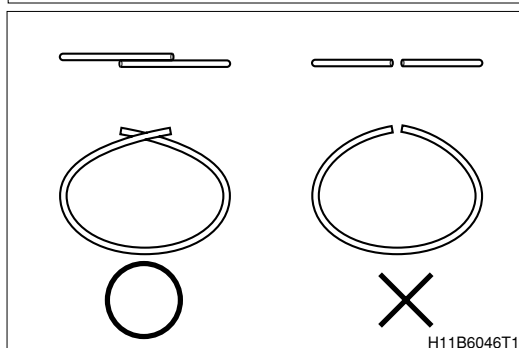

13-2-5 OPERATION AFTER ASSEMBLY

1. Install the rear seat back Ay RH/LH.
Refer to Page I2-37.
2. Install the rear seat cushion Ay RH/LH.
Refer to Page I2-37.

14 FRONT SEAT OUTER BELT

14-1 REMOVAL AND INSTALLATION

CAUTION

- Refer to the precaution on maintenance procedure for the SRS airbag system.

Refer to Page A1-26.

14-1-1 ARTICLES TO BE PREPARED

Instrument

Torque wrench

14-1-2 OPERATION BEFORE REMOVAL

- 1.Remove the battery negative (−) terminal.
- 2.Remove the center pillar lower garnish RH/LH.

Refer to Page I2-48.

14-1-3 REMOVAL AND INSTALLATION PROCEDURES

(1) Components

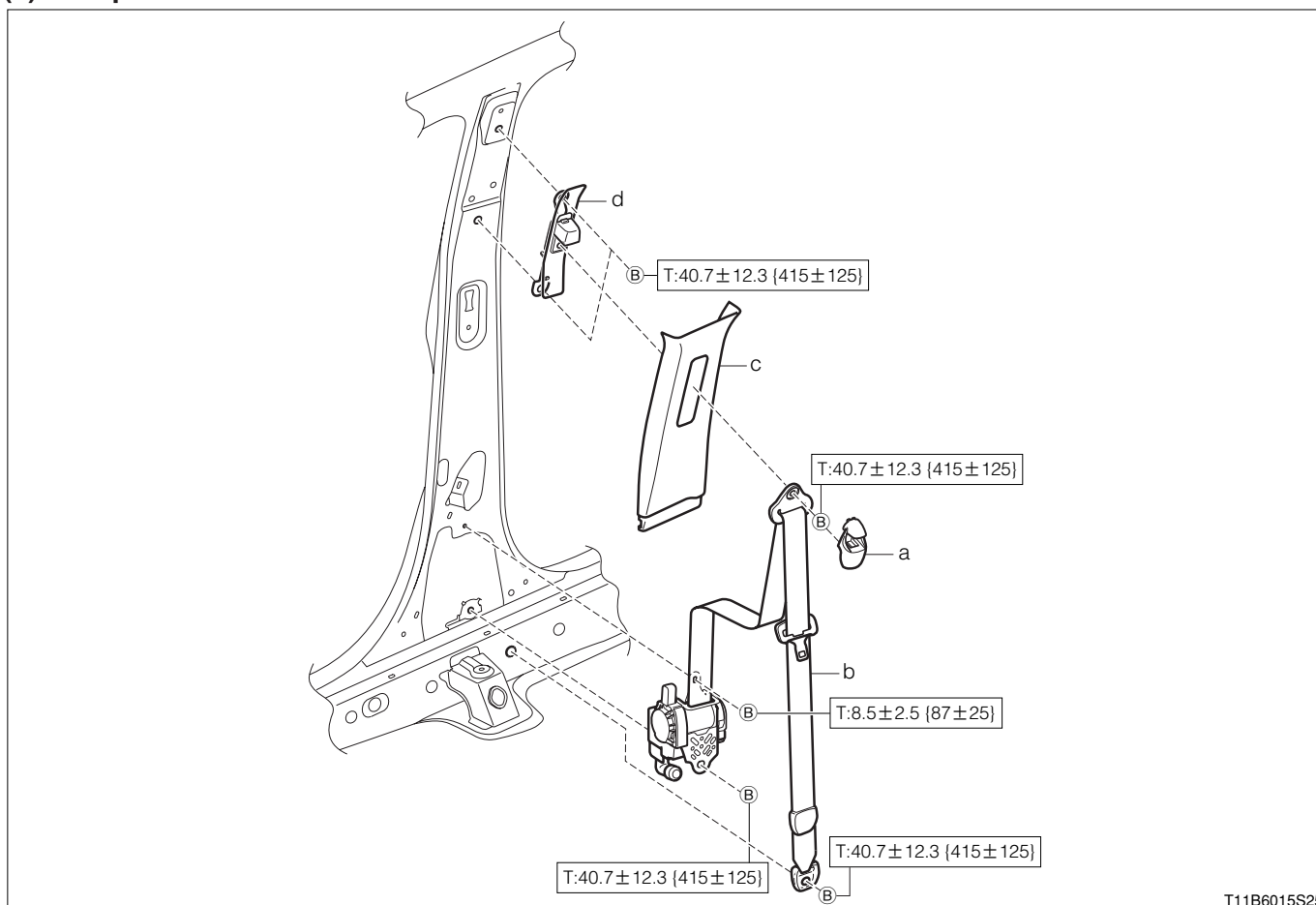

T11B6015S25

Unit:N·m{kgf·cm}

(2) Removal and installation procedures

- 1 a Cover, shoulder belt anchor
- 2 b Belt Ay, front seat outer RH/LH
- ▼ 3 c Garnish, center pillar, upper RH/LH
- 4 d Adjuster Ay, front shoulder belt anchor

14-1-4 POINTS OF REMOVAL

(1) Garnish, center pillar, upper RH/LH

Refer to Page I2-48.

14-1-5 INSPECTION

(1) Belt Ay, front seat belt outer RH/LH

① Check of inclination angle at time of ELR lock

1. Gently move the belt Ay and check the locking state at various tilting angles.

SPECIFIED VALUE: Ensure that the belt locking does not take place within 15 degrees in all directions. Also ensure that the lock is retained beyond 45 degrees.

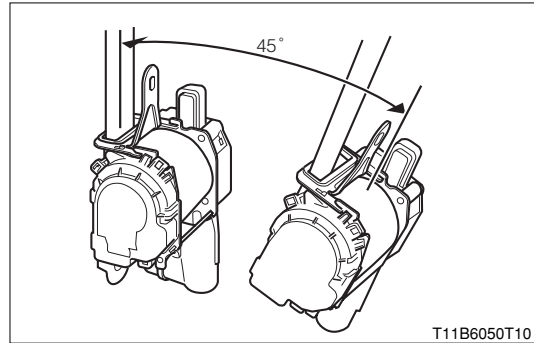

WARNING

- Never disassemble the retractor.

② ELR lock check

1. Check the locking state when the seat belt is pulled out abruptly in the vehicle assembled state.

SPECIFIED VALUE: The belt Ay shall be locked.

(2) External appearance check

1. When the following cases have occurred, replace the belt assembly.
 - (1) Case where the pretensioner mechanism has been actuated.
 - (2) Case where the vehicle is damaged in a collision, including a minor one in which pretensioner mechanism has not been actuated.
 - (3) In cases where the pretensioner mechanism of the belt Ay exhibits damage or cracks.
 - (4) Case where the connector or harness has dents or chips.
 - (5) Case where considerable amount of grease, water, detergent and oil are left on the pretensioner mechanism of the belt Ay.
 - (6) Case where the pretensioner mechanism of the belt Ay has been dropped and damaged.

14-1-6 OPERATION AFTER INSTALLATION

1. Install the RH/LH center pillar lower garnish.

Refer to Page I2-48.

2. Connect the battery negative (–) terminal.
3. Turn ON the IG switch.
4. Ensure that the airbag warning lamp is illuminated for about 6 seconds and then remains extinguished afterward.



15 REAR SEAT OUTER BELT

15-1 REMOVAL AND INSTALLATION(TWO-POINT SEAT BELTS)

15-1-1 ARTICLES TO BE PREPARED

Instrument

Torque wrench

15-1-2 OPERATION BEFORE REMOVAL

1. Remove the rear quarter trim panel Ay RH/LH.
Refer to Page I2-48.

15-1-3 REMOVAL AND INSTALLATION PROCEDURES

(1) Components

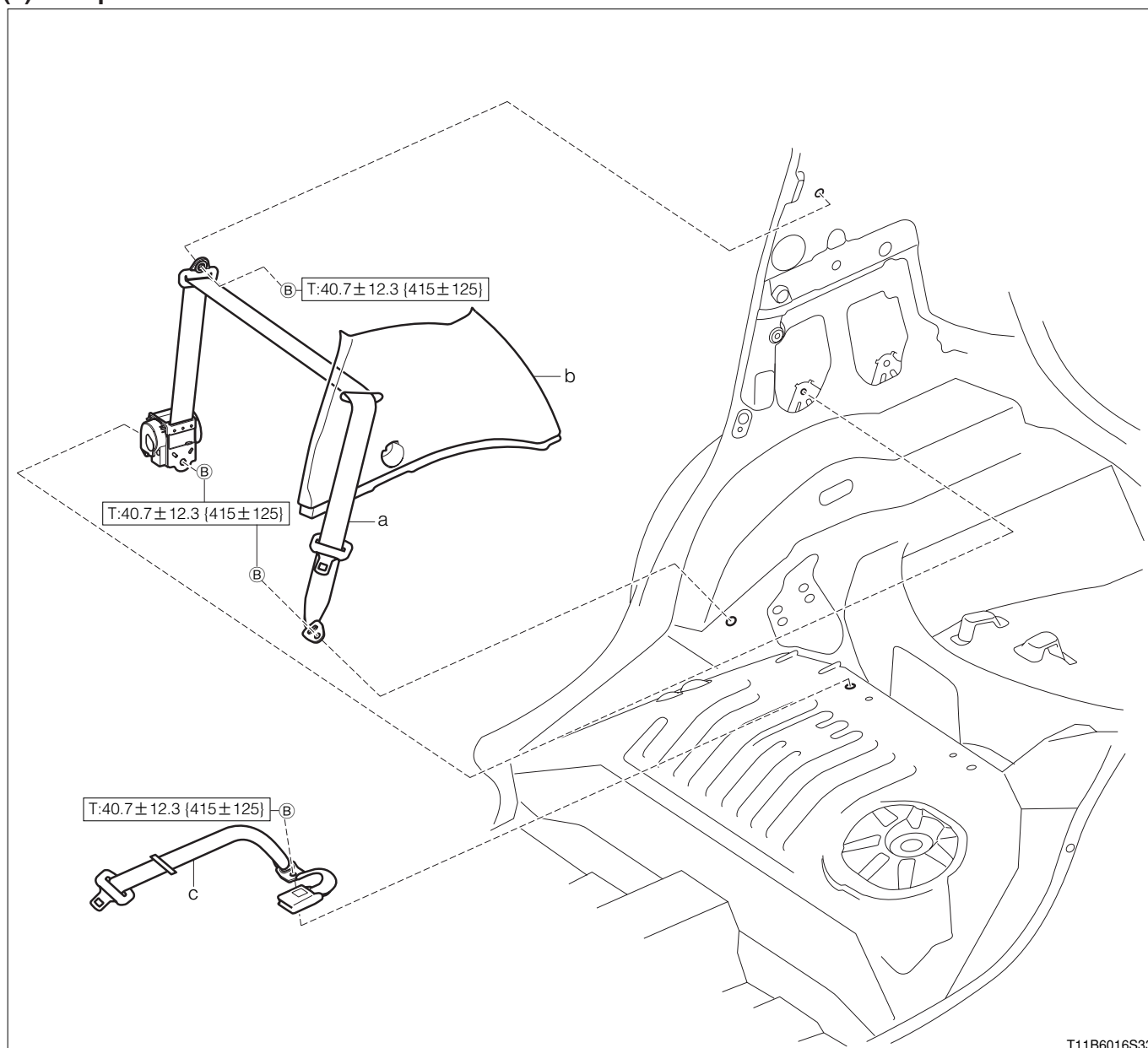

T11B6016S33

Unit:N·m{kgf·cm}

(2) Removal and installation procedures

- 1 a Belt Ay, rear seat, outer RH/LH
- ▼ 2 b Garnish, roof side inner, RH/LH
- 3 c Belt Ay, rear seat lap type, center W/inner

I2-45

15-1-4 POINTS OF REMOVAL

(1) Garnish, roof side, inner RH/LH

Refer to Page I2-48.

15-1-5 INSPECTION

(1) Belt Ay, rear seat, outer

① CHECK of inclination angle at time of ELR lock

1. Gently move the belt Ay and check the locking state at various tilting angles.

SPECIFIED VALUE: Ensure that the belt locking does not take place within 15 degrees in all directions. Also ensure that the lock is retained beyond 45 degrees.

WARNING

- Never disassemble the retractor.

(2) ELR lock check

1. Check the locking state when the seat belt is pulled out abruptly in the vehicle assembled state.

SPECIFIED VALUE: The belt shall be locked.

15-1-6 POINTS OF INSTALLATION

(1) Belt Ay, rear seat, outer RH/LH

CAUTION

- Assemble in a way that the webbing does not twist.
- In the assembled state, ensure that the belt can be pulled out and returned smoothly.

15-1-7 OPERATION AFTER INSTALLATION

1. Install the rear quarter trim panel Ay RH/LH.

Refer to Page I2-48.

15-2 REMOVAL AND INSTALLATION(THREE-POINT SEAT BELTS)

15-2-1 ARTICLES TO BE PREPARED

Instrument

Torque wrench

15-2-2 OPERATION BEFORE REMOVAL

1.Remove the rear quarter trim panel Ay RH/LH.

Refer to Page I2-48.

15-2-3 REMOVAL AND INSTALLATION PROCEDURES

(1) Components

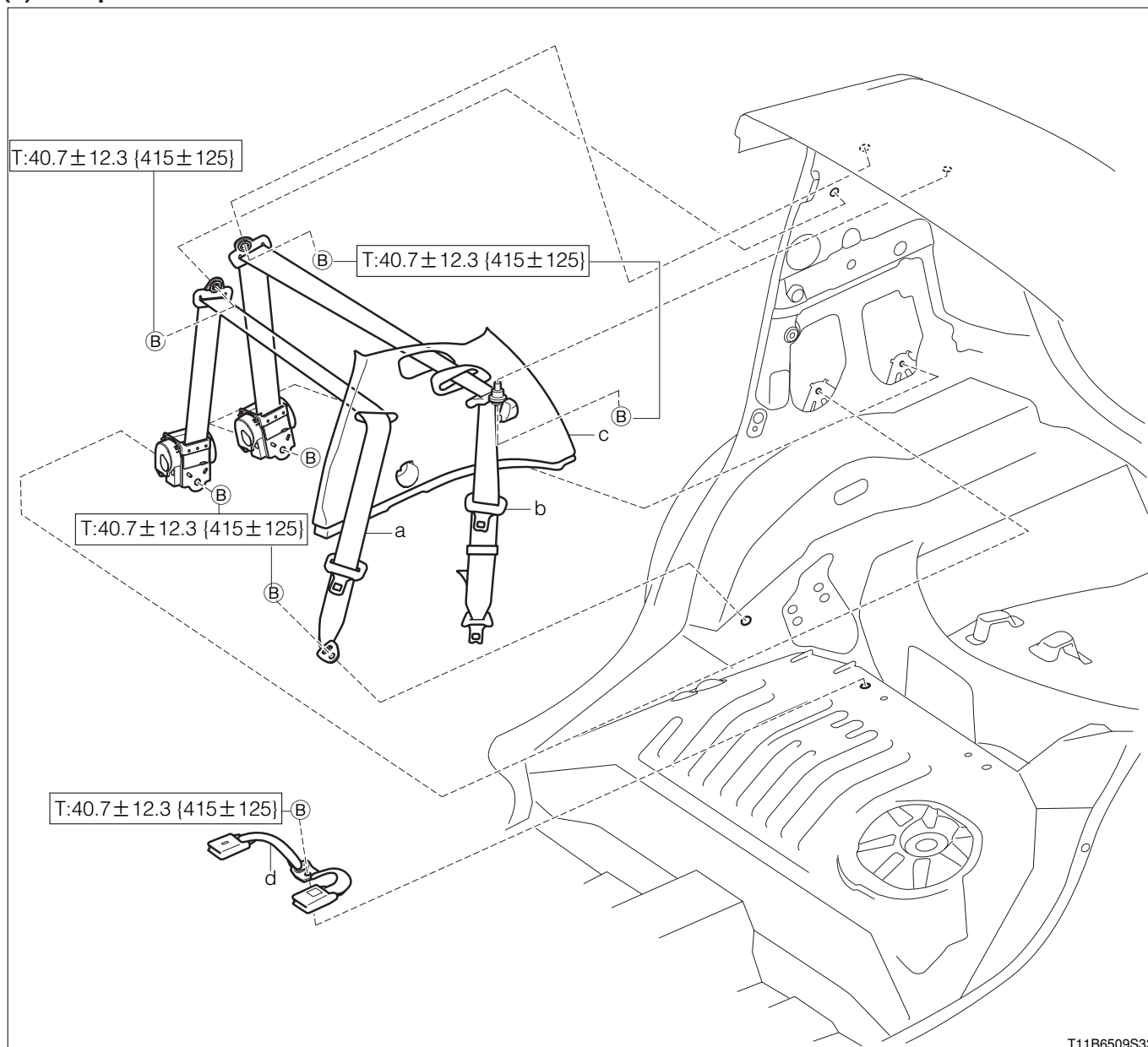

T11B6509S33

Unit:N·m{kgf·cm}

(2) Removal and installation procedures

- 1 a Belt Ay, rear seat, outer RH/LH
- 2 b Belt Ay, rear seat, outer center
- ▼ 3 c Garnish, roof side inner, RH/LH
- 4 d Belt Ay, rear seat lap type, center W/inner

15-2-4 POINTS OF REMOVAL

(1) Garnish, roof side, inner RH/LH

Refer to Page I2-48.

15-2-5 INSPECTION

(1) Belt Ay, rear seat, outer and belt Ay, rear seat, outer center

① Check of inclination angle at time of ELR lock

1. Gently move the belt Ay and check the locking state at various tilting angles.

SPECIFIED VALUE: Ensure that the belt locking does not take place within 15 degrees in all directions. Also ensure that the lock is retained beyond 45 degrees.

WARNING

- Never disassemble the retractor.

(2) ELR lock check

1. Check the locking state when the seat belt is pulled out abruptly in the vehicle assembled state.

SPECIFIED VALUE: The belt shall be locked.

15-2-6 POINTS OF INSTALLATION

(1) Belt Ay, rear seat, outer center and belt Ay, rear seat, outer RH/LH

CAUTION

- Assemble in a way that the webbing does not twist.
- In the assembled state, ensure that the belt can be pulled out and returned smoothly.

15-2-7 OPERATION AFTER INSTALLATION

1. Install the rear quarter trim panel Ay RH/LH.

Refer to Page I2-48.

16 TRIM PANEL

16-1 REMOVAL AND INSTALLATION

16-1-1 ARTICLES TO BE PREPARED

Tool

Clip remover

Lubricant, adhesive, others

Protective tape

16-1-2 OPERATION BEFORE REMOVAL

1. Remove the shoulder anchor portion of the RH/LH outer front seat belt Ay. (Only when removing the RH/LH upper center pillar garnish.)
Refer to Page I2-42.
2. Remove the shoulder anchor portion of the RH/LH outer rear seat belt Ay. (Only when removing the RH/LH inner roof side garnish.)
Refer to Page I2-44.
3. Remove the shoulder anchor section of the outer center rear seat belt Ay. (Only when the inner RH /LH roof side garnish of the three-point seat belt-equipped vehicle has been removed)
Refer to Page I2-46.
4. Remove the dome lamp Ay. (Only when removing the LH rear quarter trim panel Ay.)
Refer to Page J1-17.

16-1-3 REMOVAL AND INSTALLATION PROCEDURES

(1) Components

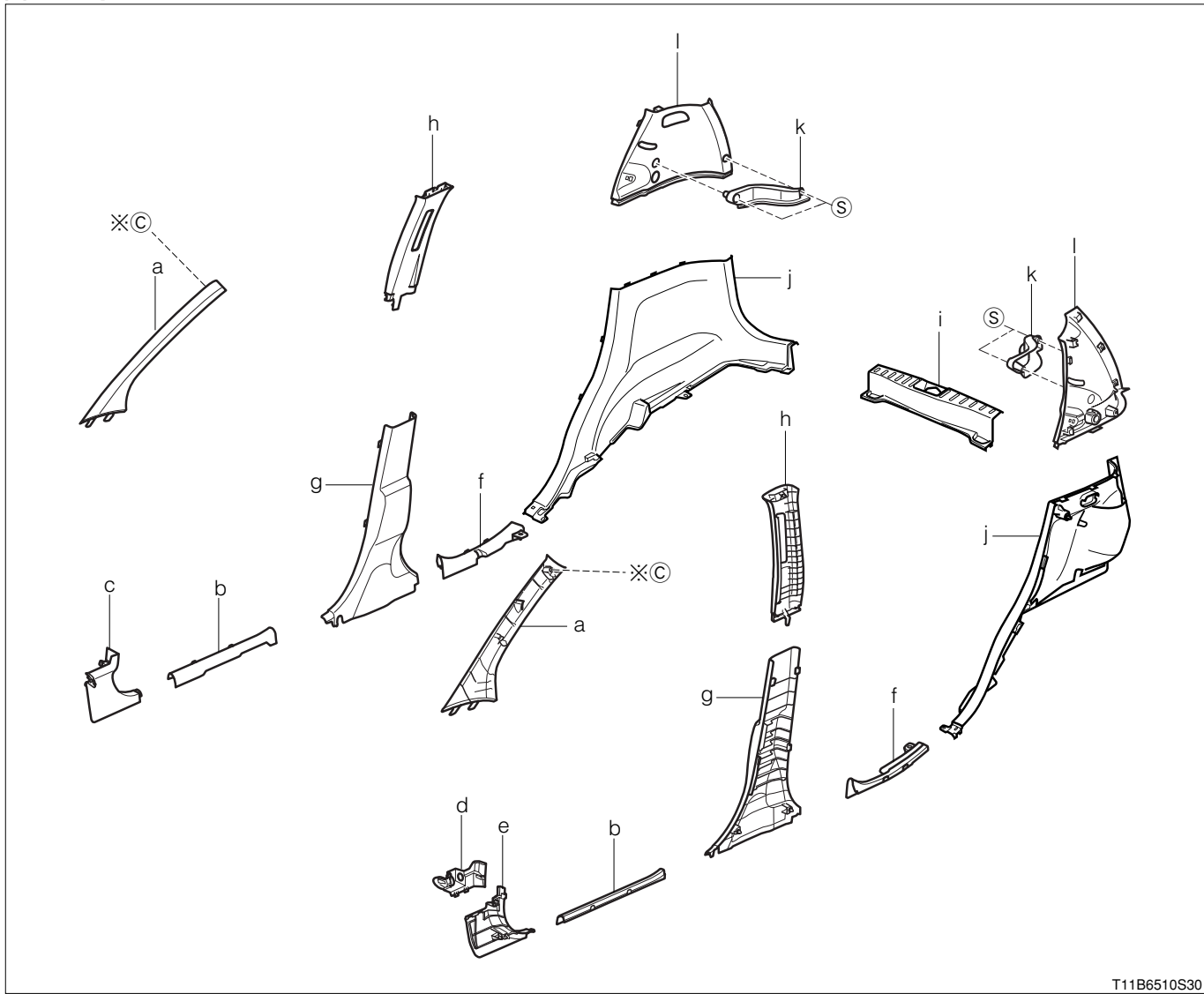

T11B6510S30

⊗:Non-reusable parts (vehicles with curtain shield airbag)

(2) Removal and installation procedures

- ▼ 1 a Garnish, front pillar, RH/LH
- ▼ 2 b Plate, front door scuff, RH/LH
- ▼ 3 c Board, cowl side trim, RH
- ▼ 4 d Cover, cowl side trim service hole
- ▼ 5 e Board, cowl side trim, LH
- ▼ 6 f Plate, rear door scuff, RH/LH
- ▼ 7 g Garnish, center pillar, lower RH/LH
- ▼ 8 h Garnish, center pillar, upper RH/LH
- ▼ 9 i Cover, deck trim, rear
- ▼ 10 j Panel Ay, quarter trim, rear RH/LH
- ▼ 11 k Panel S/A, quarter trim, upper RH/LH
- ▼ 12 l Garnish, roof side, inner RH/LH

16-1-4 POINTS OF REMOVAL**(1) Garnish, front pillar, RH/LH**

1. Remove the weather-strip.
2. Using a flat screwdriver wrapped with a protection tape, press the pawl (A) fitting section from the bottom of the vehicle indicated in the right figure and remove.
3. Disengage the pawls indicated in the right figure except the one in section A at the right figure and, remove the garnish.

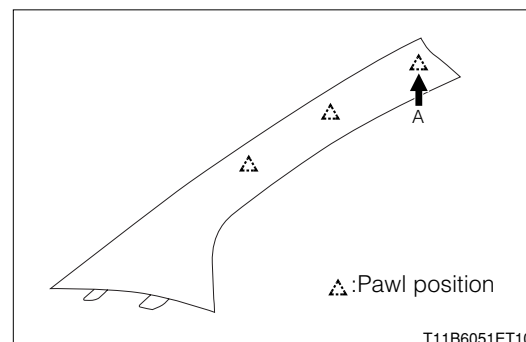
**(2) Plate, front door scuff, RH/LH**

1. Disengage the pawls indicated in the right figure and, remove the plate.

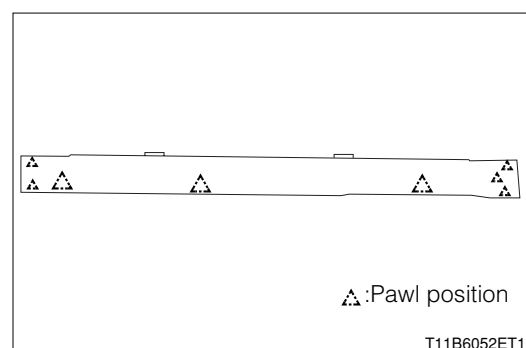
**(3) Board, cowl side trim, RH**

1. Disengage the pawls indicated in the right figure and, remove the board.

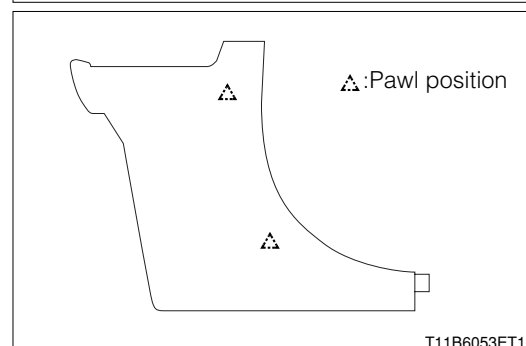
**(4) Cover, cowl side trim service hole**

1. Disengage the pawls indicated in the right figure and, remove the cover.

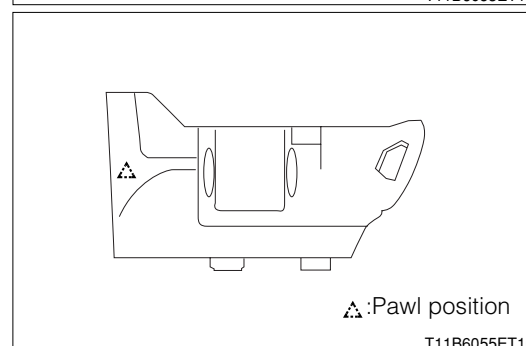

(5) Board, cowl side trim, LH

1. Disengage the pawls indicated in the right figure and, remove the board.

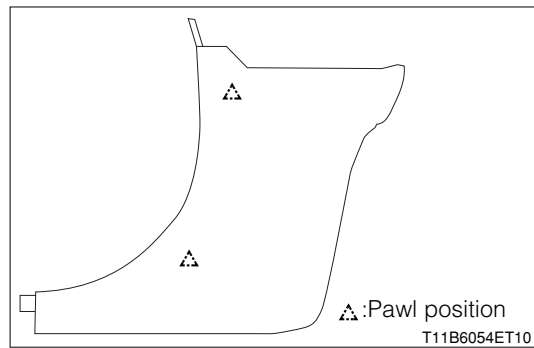

(6) Plate, rear door scuff, RH/LH

1. Disengage the pawls indicated in the right figure and, remove the plate.

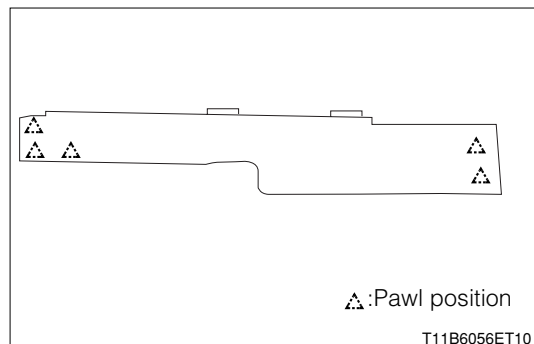

(7) Garnish, center pillar, lower RH/LH

1. Disengage the clips indicated in the right figure and, remove the garnish.

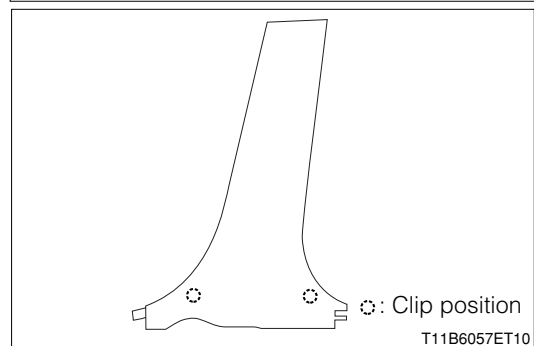

(8) Garnish, center pillar, upper RH/LH

1. Disengage the clips indicated in the right figure and, remove the garnish.

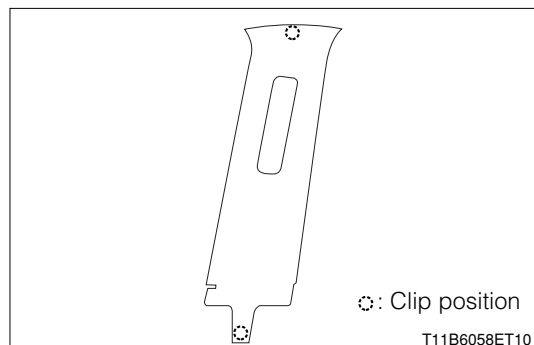

CAUTION

- Hold the correct place indicated in the right figure to prevent the garnish from getting deformed. Remove it without bending.

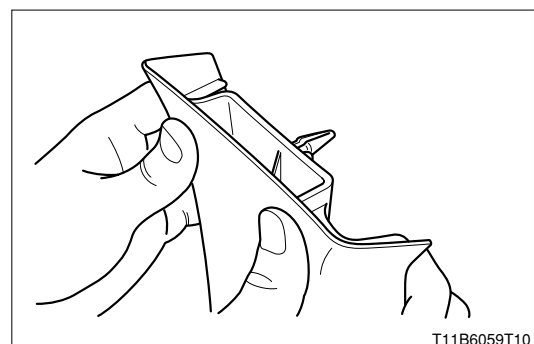

(9) Cover, deck trim, rear

1. Disengage the pawls indicated in the right figure and, remove the cover.

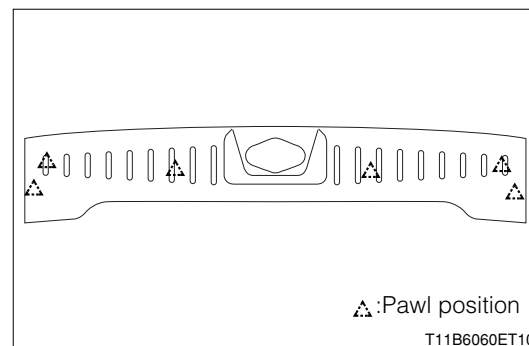
**(10) Panel Ay, quarter trim, rear RH/LH**

1. Disengage the clips indicated in the right figure and, remove the panel Ay.

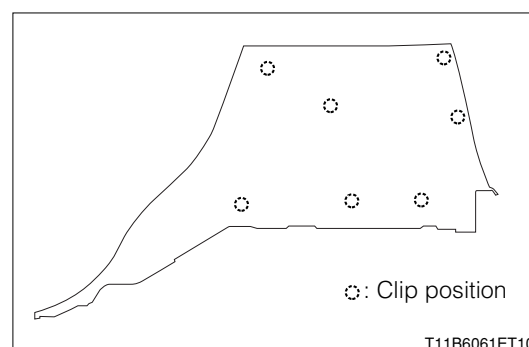
**(11) Garnish, roof side, inner RH/LH**

1. Disengage the clips indicated in the right figure and, remove the garnish.

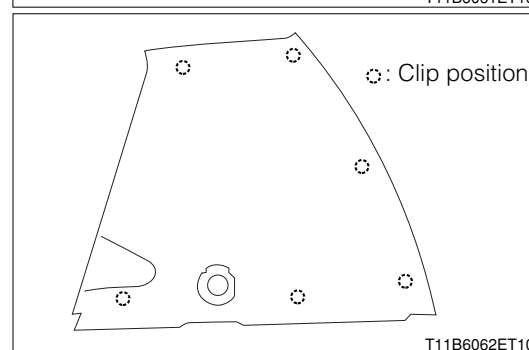
**16-1-5 OPERATION AFTER INSTALLATION**

1. Install the dome lamp Ay. (Only when removing the LH rear quarter trim panel Ay.)
Refer to Page J1-17.
2. Install the shoulder anchor section of the RH/LH outer front seat belt Ay. (Only when removing the RH/LH upper center pillar garnish.)
Refer to Page I2-42.
3. Install the shoulder anchor section of the outer center rear seat belt Ay. (Only when the inner RH /LH roof side garnish of the three-point seat belt-equipped vehicle has been removed)
Refer to Page I2-46.
4. Install the shoulder anchor portion of the RH/LH outer rear seat belt Ay. (Only when removing the RH/LH inner roof side garnish.)
Refer to Page I2-44.

17 ROOF HEADLINING

17-1 REMOVAL AND INSTALLATION

17-1-1 ARTICLES TO BE PREPARED

Tool

Clip remover

Lubricant, adhesive, others

Protective tape, Wire harness repair tape (Part number : 82997-B2010-000)

17-1-2 OPERATION BEFORE REMOVAL

1. Remove the front pillar garnish RH/LH.

Refer to Page I2-48.

2. Remove the center pillar upper garnish RH/LH.

Refer to Page I2-48.

3. Remove the shoulder anchor section of the outer center rear seat belt Ay. (Three-point seat belt-equipped vehicle)

Refer to Page I2-48.

4. Remove the roof side inner garnish RH/LH.

Refer to Page I2-46

5. Remove the map lamp Ay.

Refer to Page J1-15.

6. Remove the dome lamp Ay.

Refer to Page J1-16.

17-1-3 REMOVAL AND INSTALLATION PROCEDURES

(1) Components

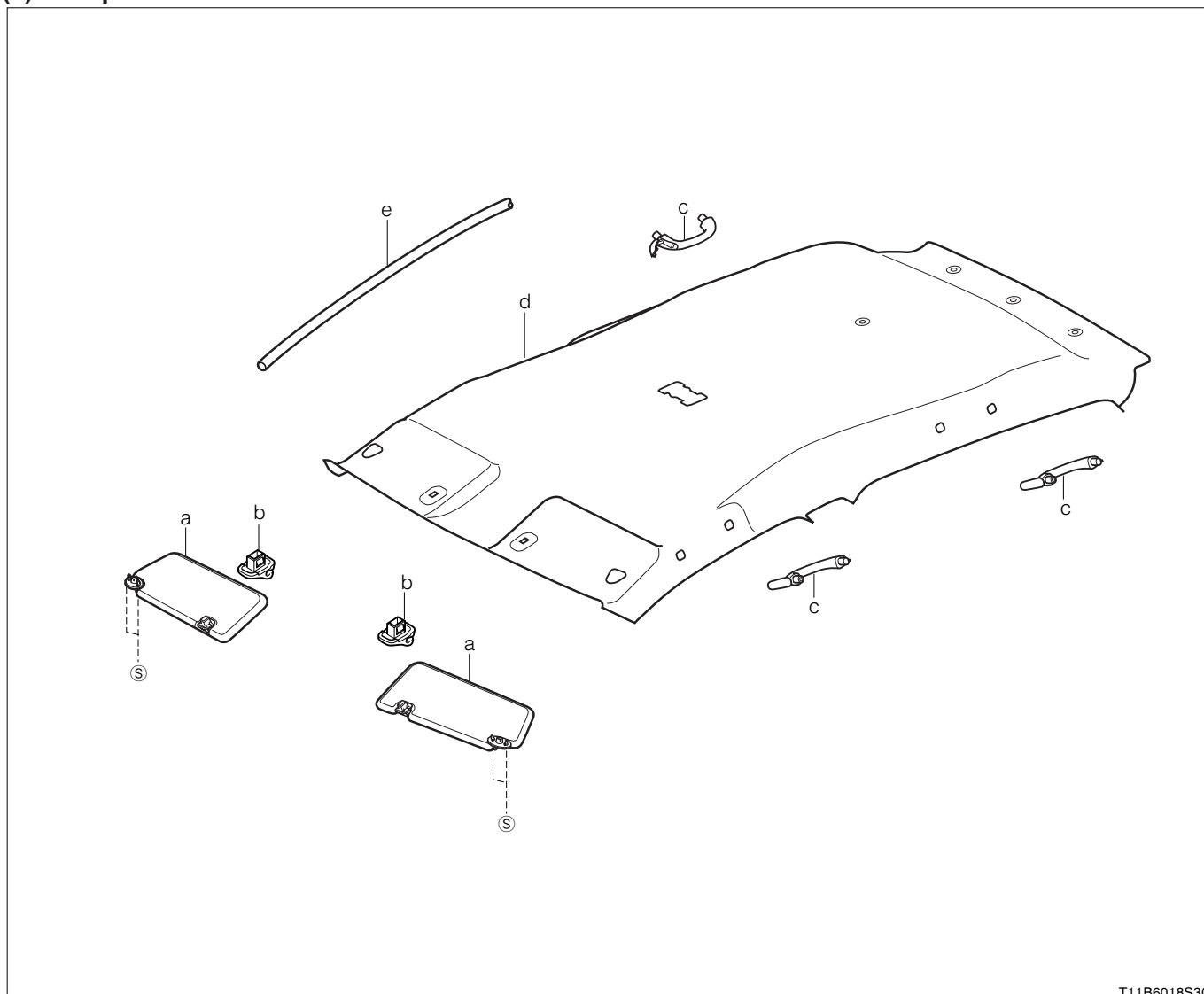

T11B6018S30

(2) Removal and installation procedures

- 1 a Visor Ay, RH/LH
- ▼ 2 b Holder, visor
- 3 c Grip, assist
- ▼ ▲ 4 d Headlining Ay, roof
- 5 e Hose Ay, washer

17-1-4 POINTS OF REMOVAL

(1) Holder, visor

1. Disengage the pawls to remove it by inserting a minus driver wrapped in protection tape from both sides.

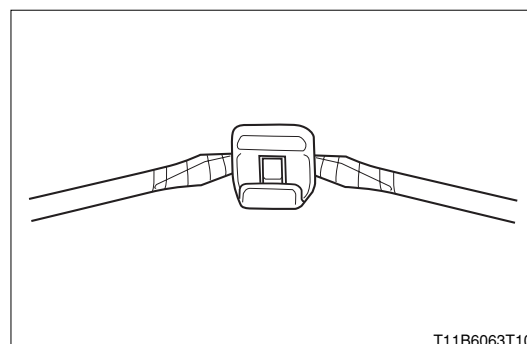

T11B6063T10

(2) Headlining Ay, roof

1.Remove the clips (4 locations).

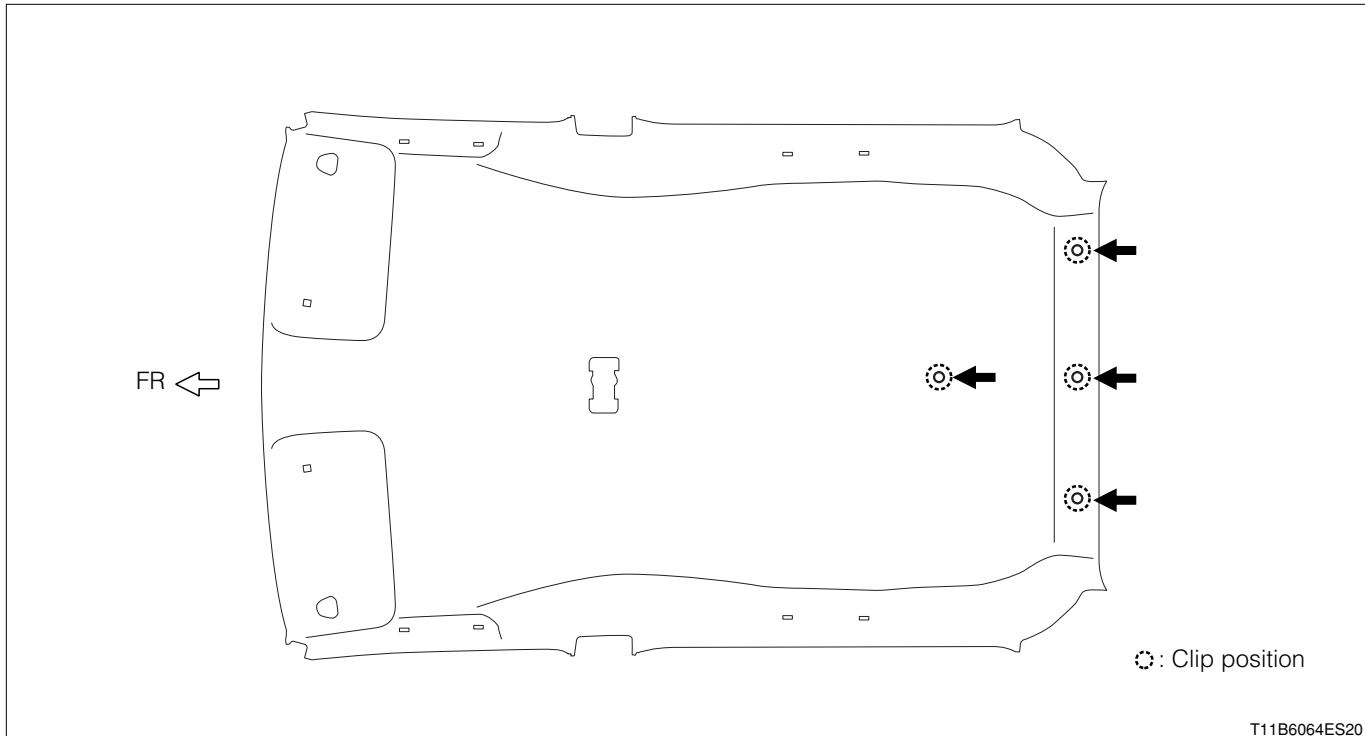

17-1-5 POINTS OF INSTALLATION

(1) Headlining Ay, roof

- 1.Apply the double-sided tape to the groove in the head lining Ay.
- 2.Fix the washer hose Ay along the head lining Ay groove to which the double-sided tape has been affixed.

NOTE

- Tape: Wire harness repair tape, Part No : 82997-B2010-000

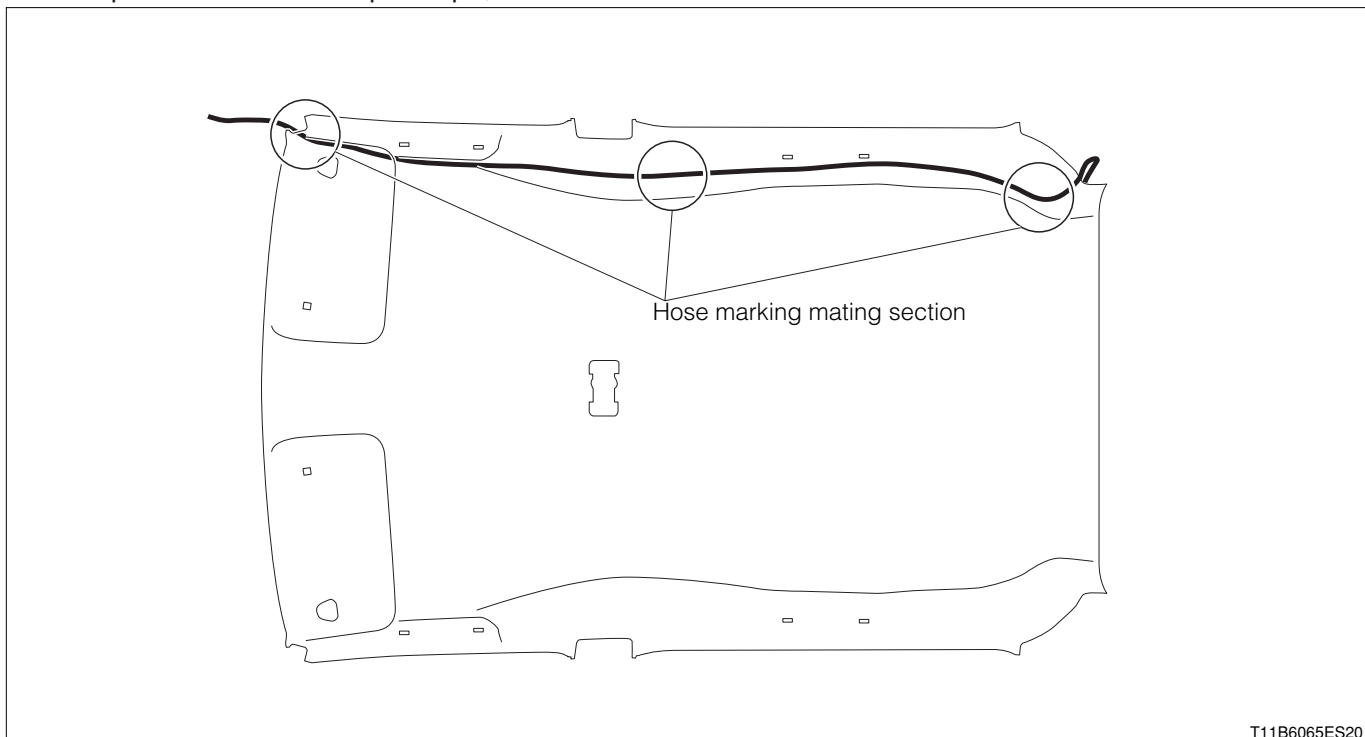

17-1-6 OPERATION AFTER INSTALLATION

1. Install the dome lamp Ay.

Refer to Page J1-16.

2. Install the map lamp Ay.

Refer to Page J1-15.

3. Install the roof side inner garnish RH/LH.

Refer to Page I2-48.

4. Install the shoulder anchor section of the outer center rear seat belt Ay. (Three-point seat belt-equipped vehicle)

Refer to Page I2-46.

5. Install the center pillar upper garnish RH/LH.

Refer to Page I2-48.

6. Install the front pillar garnish RH/LH.

Refer to Page I2-48.

18 FLOOR CARPET

18-1 REMOVAL AND INSTALLATION

18-1-1 OPERATION BEFORE REMOVAL

- 1.Remove the front seat Ay RH/LH.
Refer to Page I2-33.

- 2.Remove the rear console box S/A.
Refer to Page I2-31.

- 3.Remove the front console box S/A.
Refer to Page I2-31.

- 4.Remove the rear seat cushion Ay RH/LH.
Refer to Page I2-37.

- 5.Remove the front door scuff plate RH/LH.
Refer to Page I2-48.

- 6.Remove the cowl side trim board RH/LH.
Refer to Page I2-48.

- 7.Remove the rear door scuff plate RH/LH.
Refer to Page I2-48.

- 8.Remove the center pillar lower garnish RH/LH.
Refer to Page I2-48.

18-1-2 REMOVAL AND INSTALLATION PROCEDURES

(1) Components

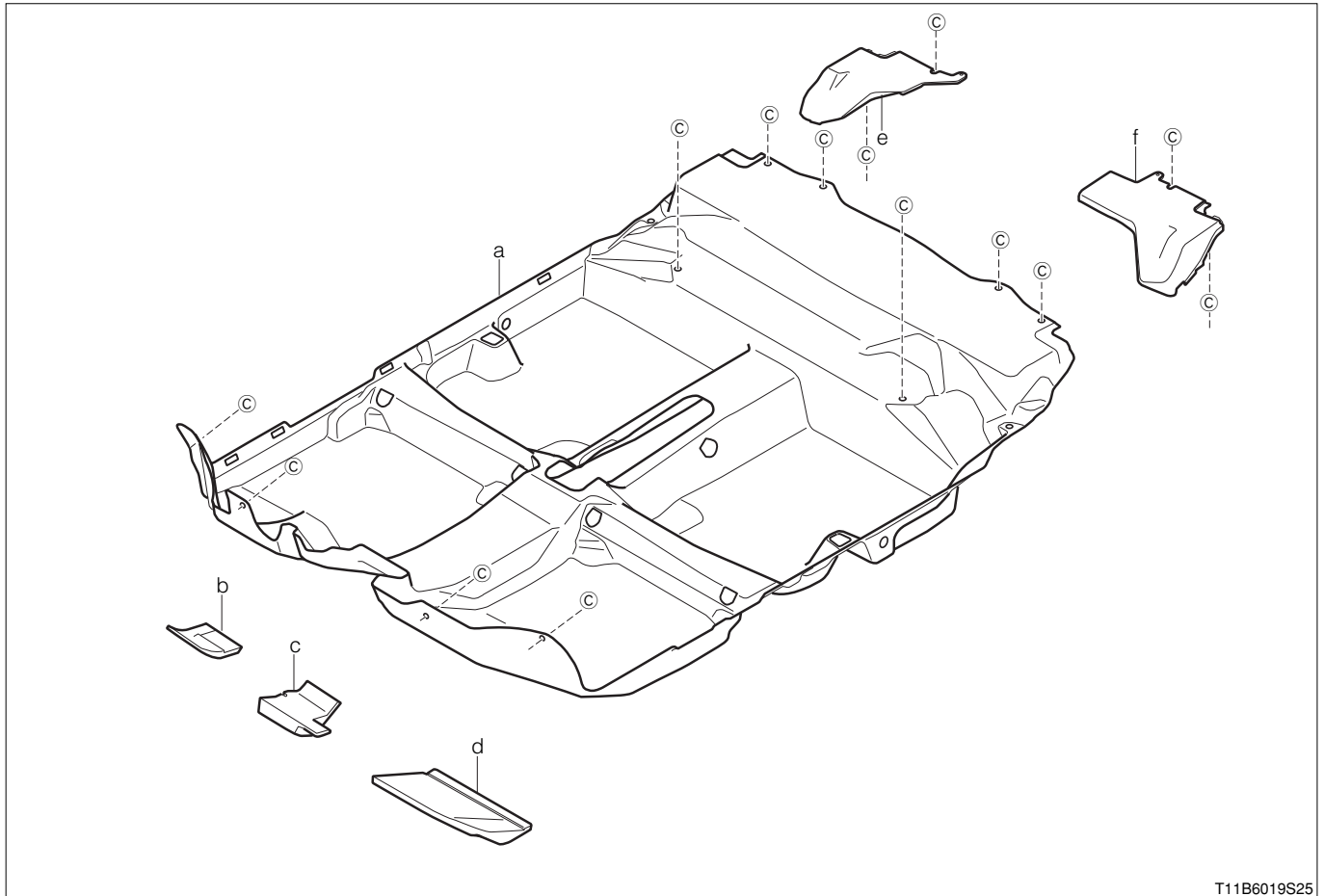

T11B6019S25

(2) Removal and installation procedures

- | | | | |
|---|-----------------------------------|---|-------------------------------|
| 1 | a Carpet Ay, floor, front | 6 | f Board, rear floor, front LH |
| 2 | b Pad, dash panel insulator, No.2 | | |
| 3 | c Pad, dash panel insulator, No.4 | | |
| 4 | d Pad, dash panel insulator, No.3 | | |
| 5 | e Board, rear floor, front RH | | |

18-1-3 OPERATION AFTER INSTALLATION

1. Install the center pillar lower garnish RH/LH.
Refer to Page I2-48.
2. Install the rear door scuff plate RH/LH.
Refer to Page I2-48.
3. Install the cowl side trim board RH/LH.
Refer to Page I2-48.
4. Install the front door scuff plate RH/LH.
Refer to Page I2-48.
5. Install the rear seat cushion Ay RH/LH.
Refer to Page I2-37.
6. Install the front console box S/A.
Refer to Page I2-31.
7. Install the rear console box S/A.
Refer to Page I2-31.
8. Install the front seat Ay RH/LH.
Refer to Page I2-33.