

C1 FRONT SUSPENSION

FRONT SUSPENSION -----	C1 - 1
BASIC CHECK AND ADJUSTMENT --	C1 - 1
FRONT SHOCK ABSORBER AND	
FRONT COIL SPRING -----	C1 - 6
REMOVAL AND INSTALLATION -----	C1 - 6
FRONT SUSPENSION LOWER ARM--	C1 - 10
REMOVAL AND INSTALLATION-----	C1 - 10
FRONT STABILIZER BAR-----	C1 - 14
REMOVAL AND INSTALLATION-----	C1 - 14
FRONT SUSPENSION MEMBER -----	C1 - 17
REMOVAL AND INSTALLATION-----	C1 - 17

C1-1

1 FRONT SUSPENSION

1-1 BASIC CHECK AND ADJUSTMENT

1-1-1 CHECK OF EACH PART OF SUSPENSION

(1) Operations prior to check

1. Jack up the vehicle.
2. Remove the front disc wheels.

(2) Check of bolts for tightening condition

1. Check bolts and nuts of each part of the axle and suspensions for loosen.

(3) Check of excessive play

1. Check each part of the axle and suspensions specified in the item given below to see if any looseness, etc. is present.
 - (1) Ball joint
 - (2) Steering linkage
 - (3) Each part of the suspension
 - (4) Front disc wheel bearing

Refer to Page D2-1.

(4) Check of damage

1. Visually check each part of the axle and suspensions to see if any damage is present.

(5) Check of cracks and damage

1. Visually check the dust boots of the ball joints to see if any cracks and damage are present.

(6) Check of shock absorber for oil leakage

1. Visually check the front shock absorber sleeve section, etc. to see if any oil leakage is present.

1-1-2 FRONT WHEEL ALIGNMENT

(1) Articles to be prepared

Tool

CCK gauge compensator, Brake pedal pusher

Instrument

Turning radius gauge, Tire pressure gauge, Camber caster gauge, Dial gauge
--

(2) Checks prior to measurement

① Check of vehicle conditions

1. Check that the vehicle is in the unloaded state. (Fuel fully filled, spare tire and tools mounted)

② Check of tires for size and wear conditions

1. Check that the tires has no wrong size, no significant difference in wear between the right and left and uneven wear.

③ Check of tire air inflation pressure

Refer to Page C3-1.

④ Check of tires for runout

Refer to Page C3-2.

⑤ Check bolts of each part of the suspension for tightening conditions

Refer to Page C1-1.

⑥ Check of each part of the suspensions for excessive play

Refer to Page C1-1.

(3) Toe-in**① Check**

1. Rock the vehicle so that it may be stabilized.
2. Move the vehicle about 5 m straight forward by pushing it by hands.

CAUTION

- When the vehicle has been moved backward, be sure to move it forward by the distance that the vehicle traveled backward.

3. Align the height of the pointer of the toe-in gauge with the center height of the front disc wheel axle, and place the gauge behind the tires.
4. Put a mark on the tread center of each front wheel tire at the rear side. Measure the distance between the two marks. (Dimension A)
5. Slowly move the vehicle forward by pushing it, until the front wheels tire make 180 degrees turn.

CAUTION

- Be very careful not to turn the wheel more than 180 degrees. If the wheel is turned more than 180 degrees, repeat the operations from Step 3.

6. Measure the distance (B) between the marks at the front section of the front tires.
7. Calculate the toe-in (A-B).

SPECIFIED VALUE: $0.0 \pm 2.0\text{mm}$

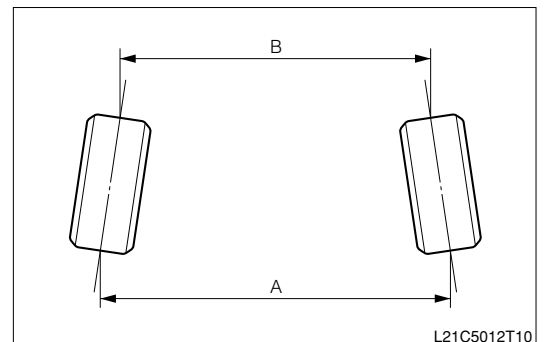
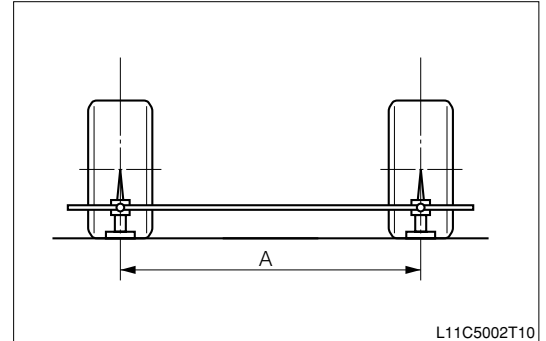
**② Adjustment**

1. Detach the steering rack boot band No.2.
2. Loosen the lock nut of the tie-rod end.
3. Turn the rack ends at the right and left sides the same amount in the opposite direction and adjust them so that the toe-in may enter within the specified range.

SPECIFIED VALUE: $0.0 \pm 1.0\text{mm}$

4. Tighten the lock nut of the tie-rod end.
- TIGHTENING TORQUE: $36.8 \pm 7.3\text{N} \cdot \text{m}$ { $375 \pm 74\text{kgf} \cdot \text{cm}$ }**

CAUTION

- Make sure that the length indicated in the right figure is the same. (Failure to observe this caution may cause differences in the wheel turning angle.)

5. Check the toe-in again.

SPECIFIED VALUE: $0.0 \pm 1.0\text{mm}$

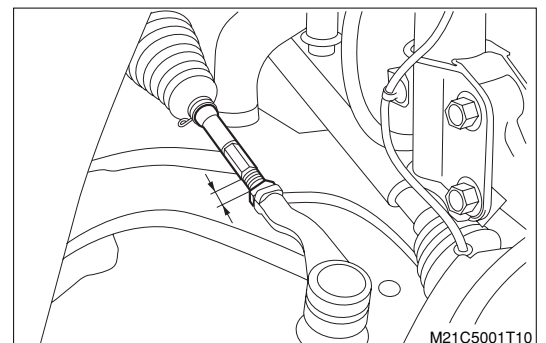

(4) Camber, caster and kingpin inclination angle

① Check

1. Setting of turning radius gauge
2. Align the turning radius gauge with the 0 degrees position and lock it.
3. Drive the vehicle so that the center of the ground-contacting surface of the tire may be aligned with the center of the turning radius gauge.

CAUTION

- The checks should be conducted under the unloaded state and with the service brake applied, using a brake pedal pressure, so that the front wheels may not turn.
- When using a portable type turning radius gauge, make sure to put a base having the same height as the gauge so as to assure the horizontal state.
- Remove the stop lamp fuse so that the stop lamp may not be turned on.

TOOL: Brake pedal pusher

4. Install a compensator to the disc wheel. Then, install a camber/caster/kingpin gauge.
5. Align the graduation of the turning radius gauge with the 0 degrees position. Unlock the turning radius gauge.
6. Install the gauge, while aligning the tip end of the center rod of the camber-caster-kingpin gauge with the designated position of the compensator.

TOOL: CCK gauge compensator

7. Check the camber.
8. Confirm the straight-ahead position.
9. Set the gauge horizontally so that a level bubble of the gauge comes at the center.
10. Read out the graduation at the center position of the bubble of the gauge for the camber measurement.

SPECIFIED VALUE: $0^{\circ} \pm 45'$

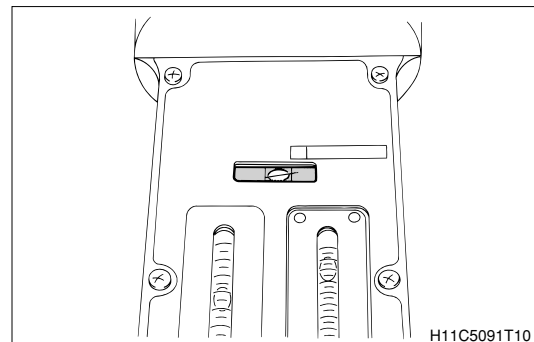
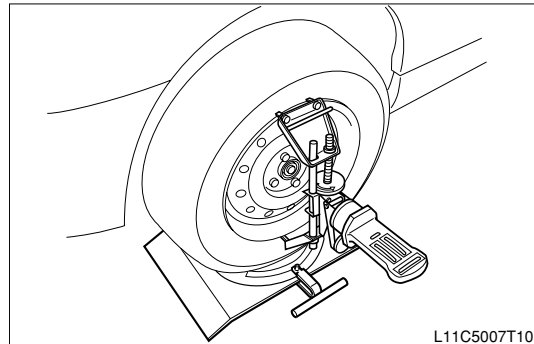
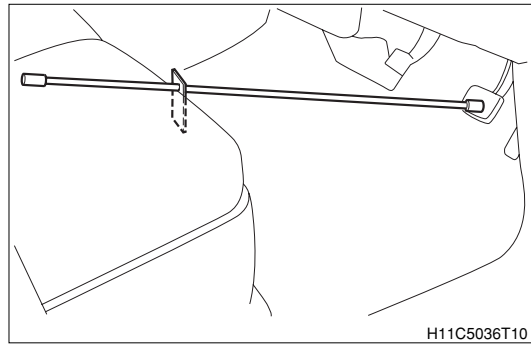

11. Check the caster angle and kingpin angle (Right wheel).

Caster inclination angle

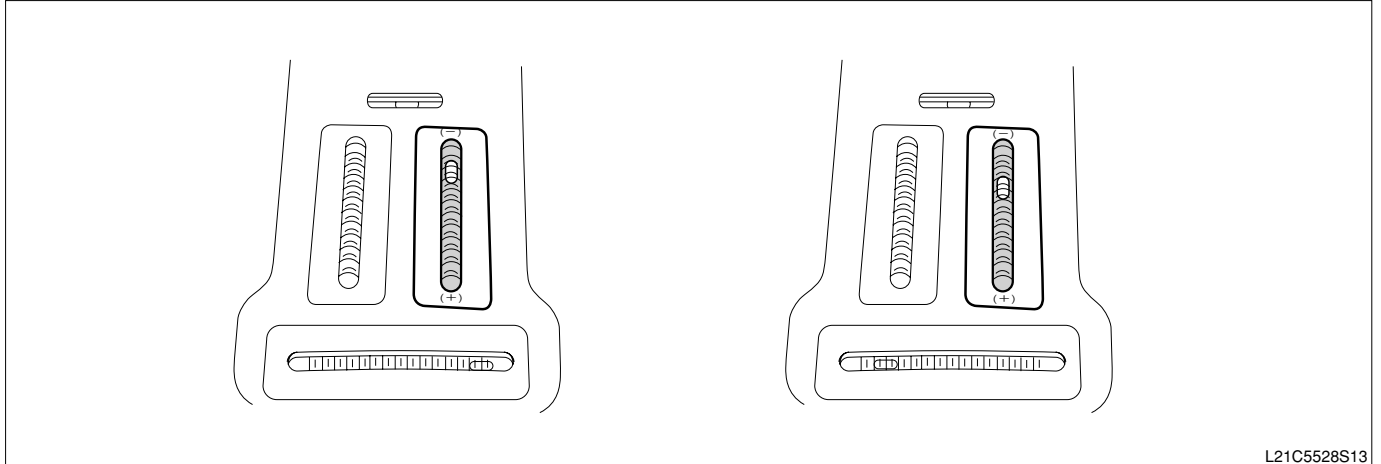

L21C5528S13

Kingpin inclination angle

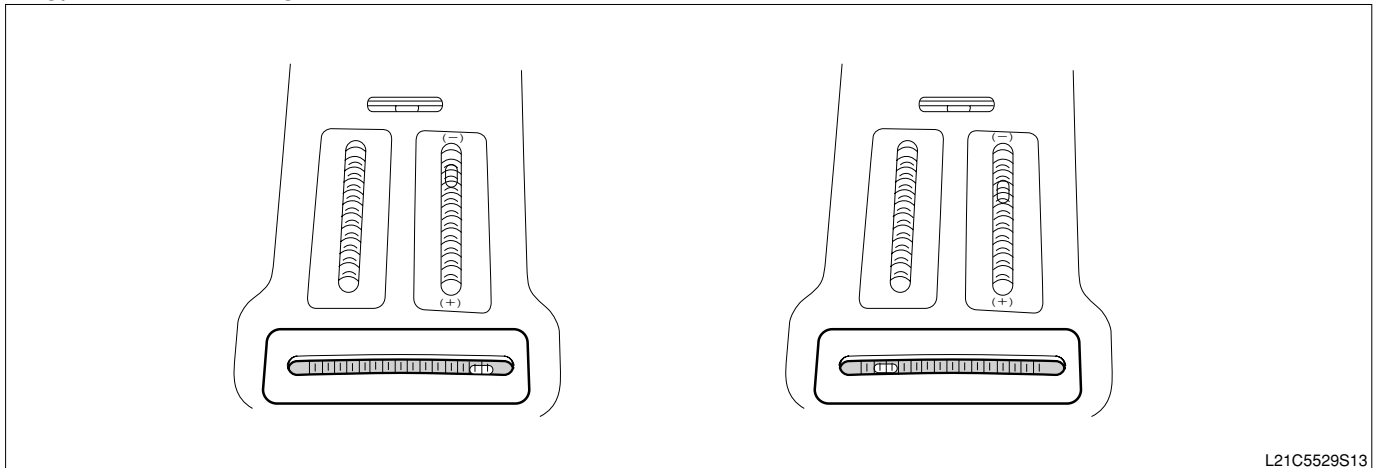

L21C5529S13

12. Turn the steering wheel clockwise until the turning radius gauge points to 20 degrees.

13. Adjust the adjusting screws of the caster angle and kingpin inclination angle until each air bubble is aligned with the "0" position.

14. Turn the steering wheel counterclockwise until the turning radius gauge points 20 degrees.

15. Read the graduation of the bubble center position at the caster angle measuring gauge and kingpin angle measuring gauge.

SPECIFIED VALUE: caster angle $3^{\circ} 28' \pm 1^{\circ}$

kingpin inclination angle $10^{\circ} 36' \pm 1^{\circ}$

16. Check the caster angle and kingpin inclination angle (Left wheel).

NOTE

- This is a non-adjustable type, in which the camber, caster and kingpin inclination angle have already been adjusted to the specified values.

17. Remove the gauge and SST.

C1-5

(5) Wheel turning angle

① Check

1. Turn the steering wheel fully to the right and to the left. At this time, check the wheel turning angle.

Tire	Inside (A)	Outside (B)
155/80R13	$45^{\circ} 42' \begin{smallmatrix} +2 \\ -3 \end{smallmatrix}$	$37^{\circ} 00' \begin{smallmatrix} +2 \\ -3 \end{smallmatrix}$
175/65R14	$40^{\circ} 00' \begin{smallmatrix} +2 \\ -3 \end{smallmatrix}$	$33^{\circ} 48' \begin{smallmatrix} +2 \\ -3 \end{smallmatrix}$

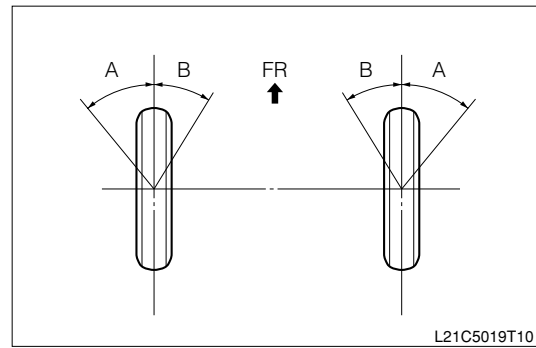

② Adjustment

1. If the turning angles differ greatly between the right and left sides or they are deviated greatly from the specified values, carry out the check and adjustment of the toe-in.

(6) Front side slip

① Check

NOTE

- Even when the side slip value is within the range of the specified value, if there is any abnormality, be sure to check and adjust the above items.

1. Check the side slip, using a side slip tester.

SPECIFIED VALUE: In 5 mm - out 5 mm

2 FRONT SHOCK ABSORBER AND FRONT COIL SPRING

2-1 REMOVAL AND INSTALLATION

WARNING

- If you try to remove the lock nut without using the SST, the front coil spring would jump out, posing a serious danger. Therefore, make sure to employ the SST.

2-1-1 ARTICLES TO BE PREPARED

SST

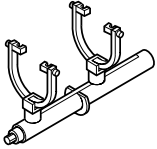
Shape	Part No.	Part name
	09727-30021-000 (09727-30020-000)	Compressor, front coil spring

Instrument

Torque wrench

2-1-2 OPERATION BEFORE REMOVAL

1. Jack up the vehicle.
2. Remove the disc wheel. (Front)
Refer to Page C3-3.
3. Remove the clamp section of the flexible hose.
Refer to Page E1-43.
4. Remove the clamp section of the front speed sensor RH/LH. (ABS-equipped vehicle)
Refer to Page E3-4.
5. Remove the cowl top ventilator louver S/A RH/LH.
Refer to Page I2-8.
6. Disconnect the control cable from the cowl top inner panel S/A.

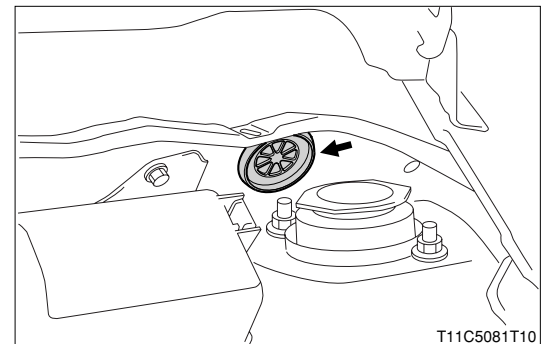

C1-7

2-1-3 REMOVAL AND INSTALLATION PROCEDURES

(1) Components

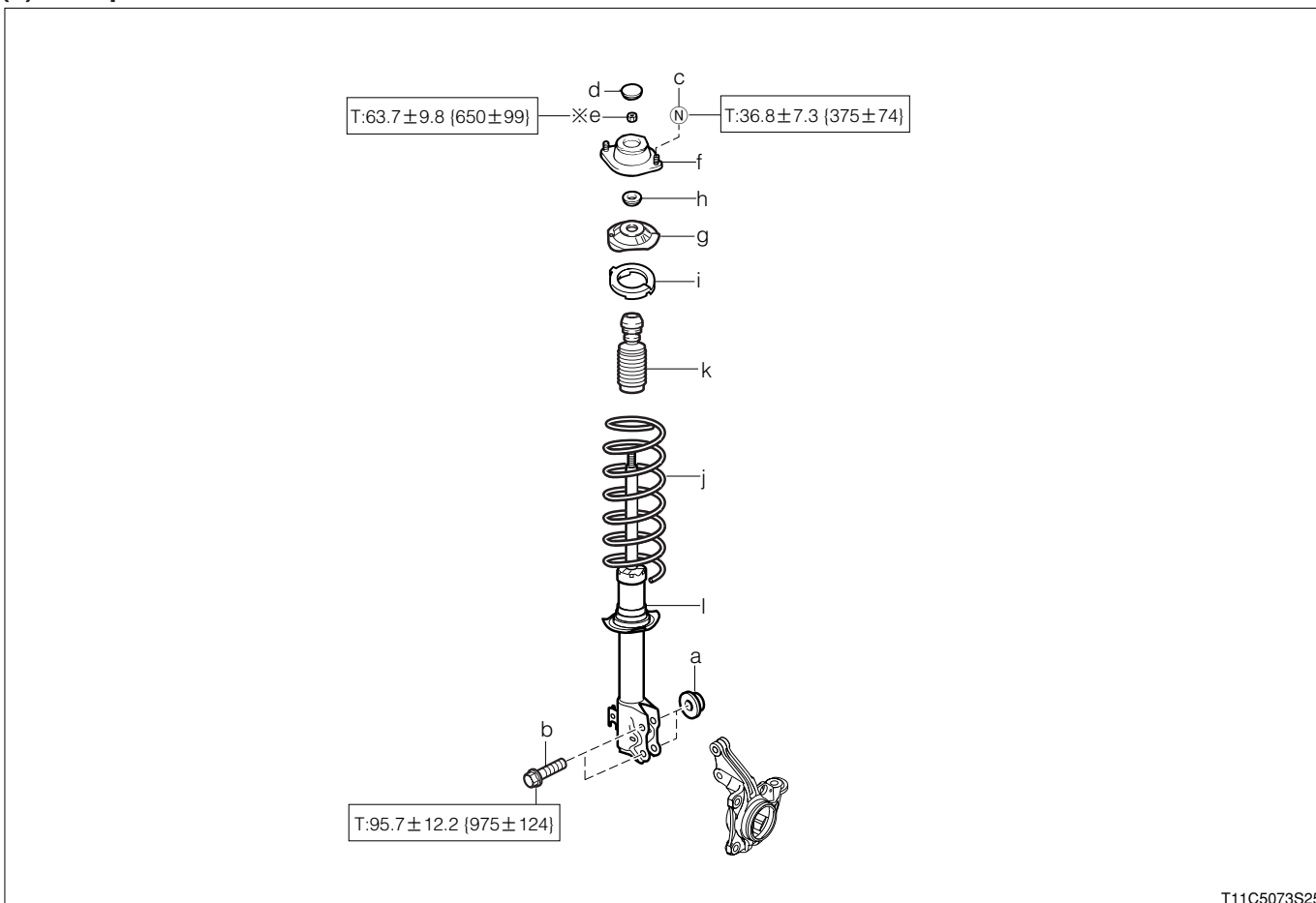

T11C5073S25

※:Non - reusable parts

Unit:N·m{kgf·cm}

(2) Removal and installation procedures

- | | | | |
|-----|---------------------------------|--------|--------------------------------|
| 1 | a Nut, hexagon | 7 | g Seat Ay, front spring, upper |
| 2 | b Bolt, hexagon | 8 | h Bearing, strut mounting |
| 3 | c Nut | 9 | i Insulator, front coil spring |
| 4 | d Cover, bearing dust | ▼ ▲ 10 | j Spring, coil, front |
| 5 | e Nut, lock | 11 | k Bumper, front spring |
| ▼ 6 | f Support S/A, front suspension | 12 | l Absorber Ay, shock, front |

2-1-4 POINTS OF REMOVAL

(1) Support S/A, front suspension

- 1.Put the tool through the service hole so as to remove the nut of the support S/A.

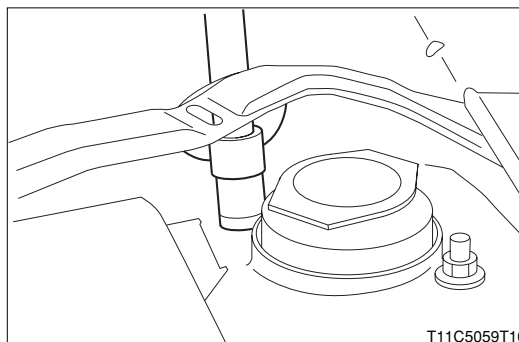

T11C5059T10

(2) Spring, front, coil

1. Install the SST to the spring.
2. Compress the spring fully.

WARNING

- At this time, make sure that the SST is installed in such a way that the distance between the hooks becomes the greatest.
- When compressing the spring, do not use an impact wrench.

SST: 09727-30021-000

2-1-5 INSPECTION**(1) Absorber AY, shock, front RH/LH**

1. Check the operation of the shock absorber Ay by compressing and expanding it.

SPECIFIED VALUE: When the shock absorber is compressed by hand, ensure that it can be compressed with a certain resistance, but without binding. When you release your hand after compressing the shock absorber, ensure that it is extended at a constant speed by itself.

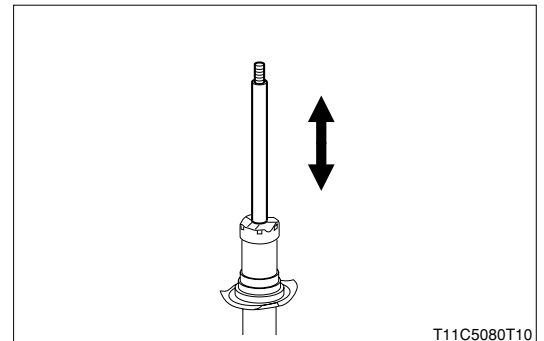
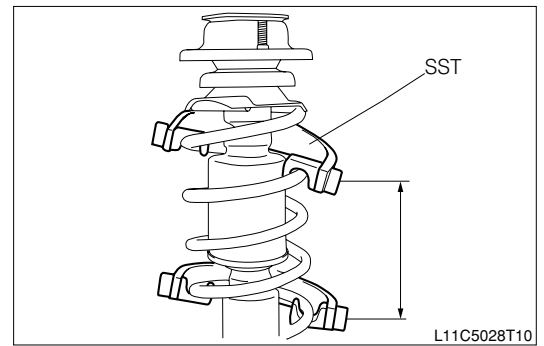
**(2) Spring, front, coil**

1. Check the spring for cracks, wear and damage.

2-1-6 POINTS OF INSTALLATION**(1) Spring, front, coil**

1. Install the spring to the front shock absorber assembly RH/LH, using the SST.

WARNING

- At this time, make sure that the SST is installed in such a way that the distance between the hooks becomes the greatest.
- When compressing the spring, do not use an impact wrench.
- Make sure to align the groove of the spring seats at the upper and lower sides with the edge of the spring.

SST: 09727-30021-000

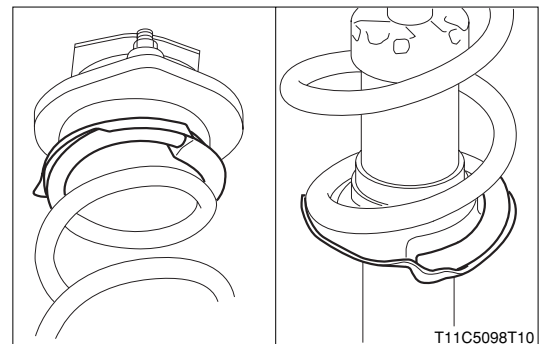

2-1-7 OPERATION AFTER INSTALLATION

1. Install the hole plug to the inner top cowl panel S/A.
2. Install the cowl top ventilator louver S/A RH/LH.
Refer to Page I2-8.
3. Install the clamp section of the front speed sensor RH/LH. (ABS-equipped vehicle)
Refer to Page E3-4.
4. Install the clamp section of the flexible hose.
Refer to Page E1-43.
5. Install the disc wheel. (Front)
Refer to Page C3-3.
6. Jack down the vehicle.
7. Check and adjust the front wheel alignment.
Refer to Page C1-1.

3 FRONT SUSPENSION LOWER ARM

3-1 REMOVAL AND INSTALLATION

3-1-1 ARTICLES TO BE PREPARED

SST

Shape	Part No.	Part name
	09628-00011-000 (09611-87701-000)	Puller, tie-rod end

Instrument

Torque wrench

Lubricant, adhesive, others

Wire

3-1-2 OPERATION BEFORE REMOVAL

1. Jack up the vehicle.
2. Remove the disc wheel. (Front)
Refer to Page C3-3.
3. Remove the front speed sensor RH/LH from the steering knuckles RH/LH. (ABS-equipped vehicles)
Refer to Page E3-4.
4. Remove the front disc brake caliper Ay RH/LH. Hang them with wire, etc.
Refer to Page E1-53.
5. Remove the front disc.
Refer to Page E1-60.
6. Separate the stabilizer link from the suspension lower arm S/A RH/LH with bush.
Refer to Page C1-14.
7. Remove the nut of the front drive shaft Ay RH/LH.
Refer to Page D2-8.
8. Separate the front shock absorber Ay from the steering knuckles RH/LH.
Refer to Page C1-6.
9. Pull out the front drive shaft Ay RH/LH from the steering knuckles RH/LH. Then, hang it with wire, etc.
Refer to Page D2-8.

C1-11

3-1-3 REMOVAL AND INSTALLATION PROCEDURES

(1) Components

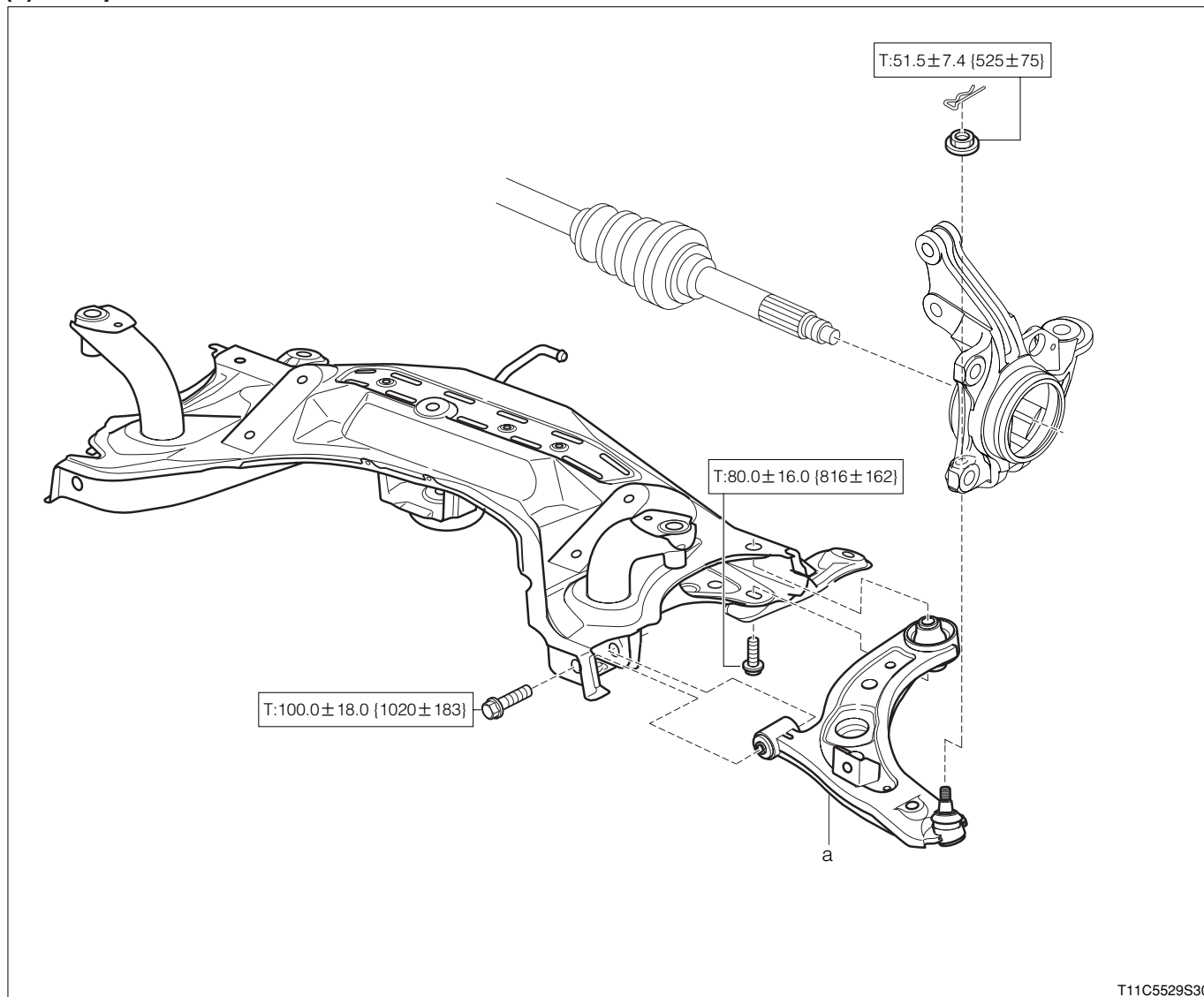

Unit:N·m{kgf·cm}

(2) Removal and installation procedures

▼ ▲ 1 a Arm S/A, suspension lower arm w/bush, RH/LH

3-1-4 POINTS OF REMOVAL

(1) Arm S/A, Suspension lower w/bush, RH/LH

1. Separate the steering knuckles RH/LH from the ball joint section of the arm S/A, using the SST.

CAUTION

- When setting the SST, attach a dummy nut to the threaded portion of the arm subassembly so that the threaded portion may not be damaged.
- Hang the SST using a cord.

SST: 09628-00011-000

2. Remove the two bolts that connect the arm S/A with the front suspension cross member S/A.

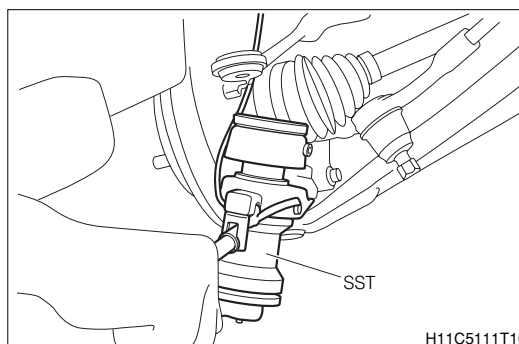

3.Remove the arm S/A from the front side of the vehicle.

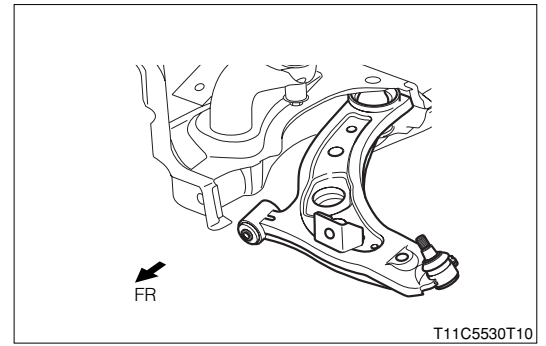

3-1-5 POINTS OF INSTALLATION

(1) Arm S/A, suspension lower w/bush, RH/LH

1.Install the arm S/A from the rear side of the vehicle.

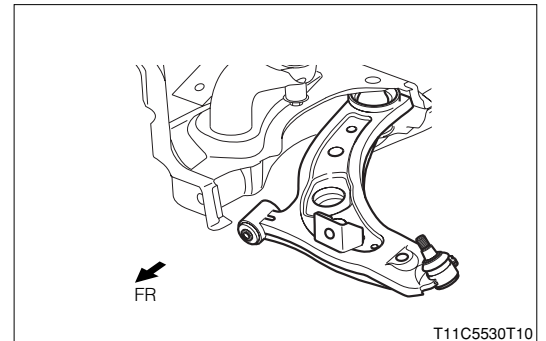

(1) Tighten the arm S/A to the dimensions indicated in the figure. Or, temporarily tighten the arm S/A at this step. Then, rock the vehicle several times under a condition where the vehicle weight is applied, thus stabilizing the suspension. Finally, securely tighten the bolts.

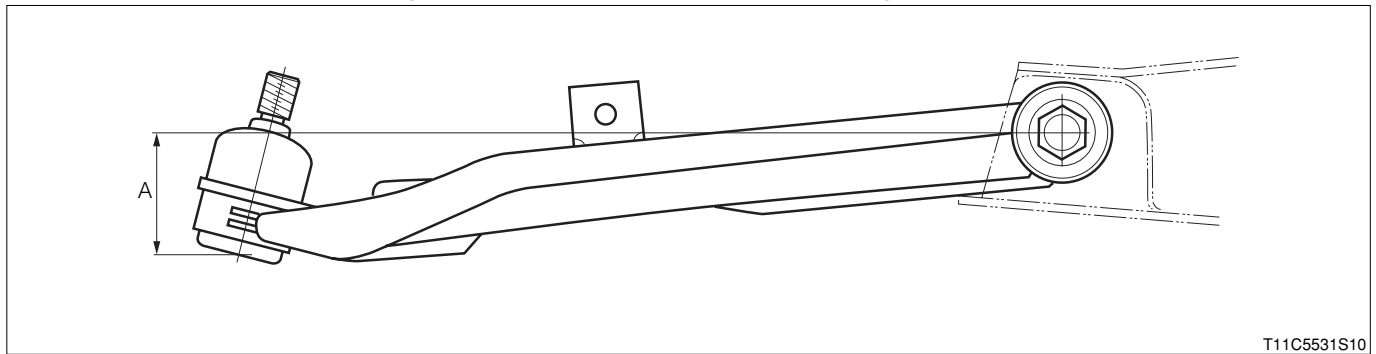

SPECIFIED VALUE:

Measuring point	Dimension A [mm]
Lower arm bush - Lowest edge of arm S/A	46±5

2.Temporarily install the front suspension absorber Ay and the steering knuckle RH/LH.

3.Install the arm S/A to the steering knuckle RH/LH. Tighten them securely.

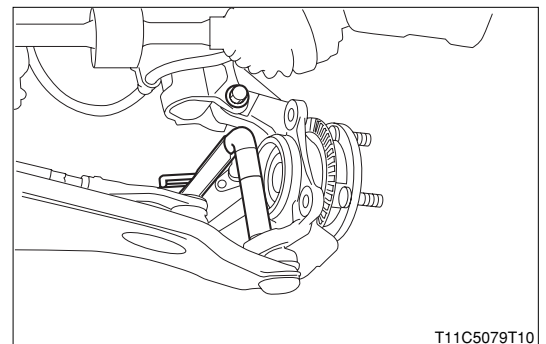

C1-13

CAUTION

- During the assembly, ensure that no oil nor grease is adhered to the threaded portion of the ball stud, tapered section, and steering knuckle RH/LH installation section of the arm subassembly. If oil or grease is adhered, be certain to wipe it off.

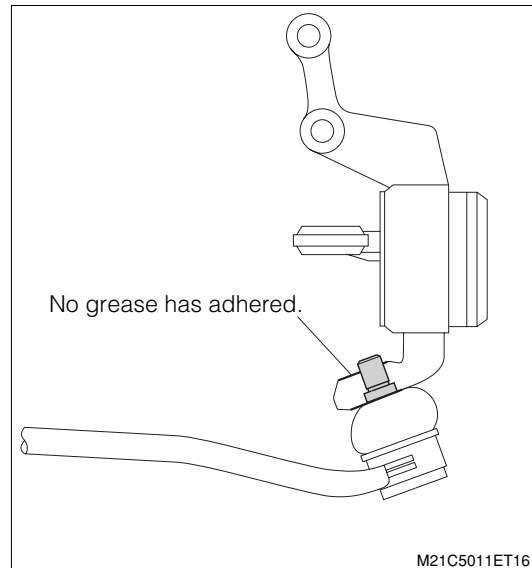

3-1-6 OPERATION AFTER INSTALLATION

1. Insert the front drive shaft Ay RH/LH to the steering knuckle RH/LH.
Refer to Page D2-8.
2. Install the steering knuckle RH/LH to the front shock absorber Ay.
Refer to Page C1-6.
3. Tighten the nuts of the front drive shaft Ay RH/LH.
Refer to Page D2-8.
4. Install the stabilizer link to the suspension lower arm S/A with bush RH/LH.
Refer to Page C1-14.
5. Install the Front disc.
Refer to Page E1-60.
6. Install the front disc brake caliper Ay RH/LH.
Refer to Page E1-53.
7. Install the front speed sensors RH/LH to the steering knuckles RH/LH. (ABS-equipped vehicles)
Refer to Page E3-4.
8. Install the disc wheel. (Front)
Refer to Page C3-3.
9. Jack down the vehicle.
10. Check and adjust the front wheel alignment.
Refer to Page C1-1.

4 FRONT STABILIZER BAR

4-1 REMOVAL AND INSTALLATION

4-1-1 ARTICLES TO BE PREPARED

Instrument

Torque wrench

4-1-2 OPERATION BEFORE REMOVAL

- 1.Lift up the vehicle.
- 2.Remove the disc wheels. (Front)
Refer to Page C3-3.

4-1-3 REMOVAL AND INSTALLATION PROCEDURES

(1) Components

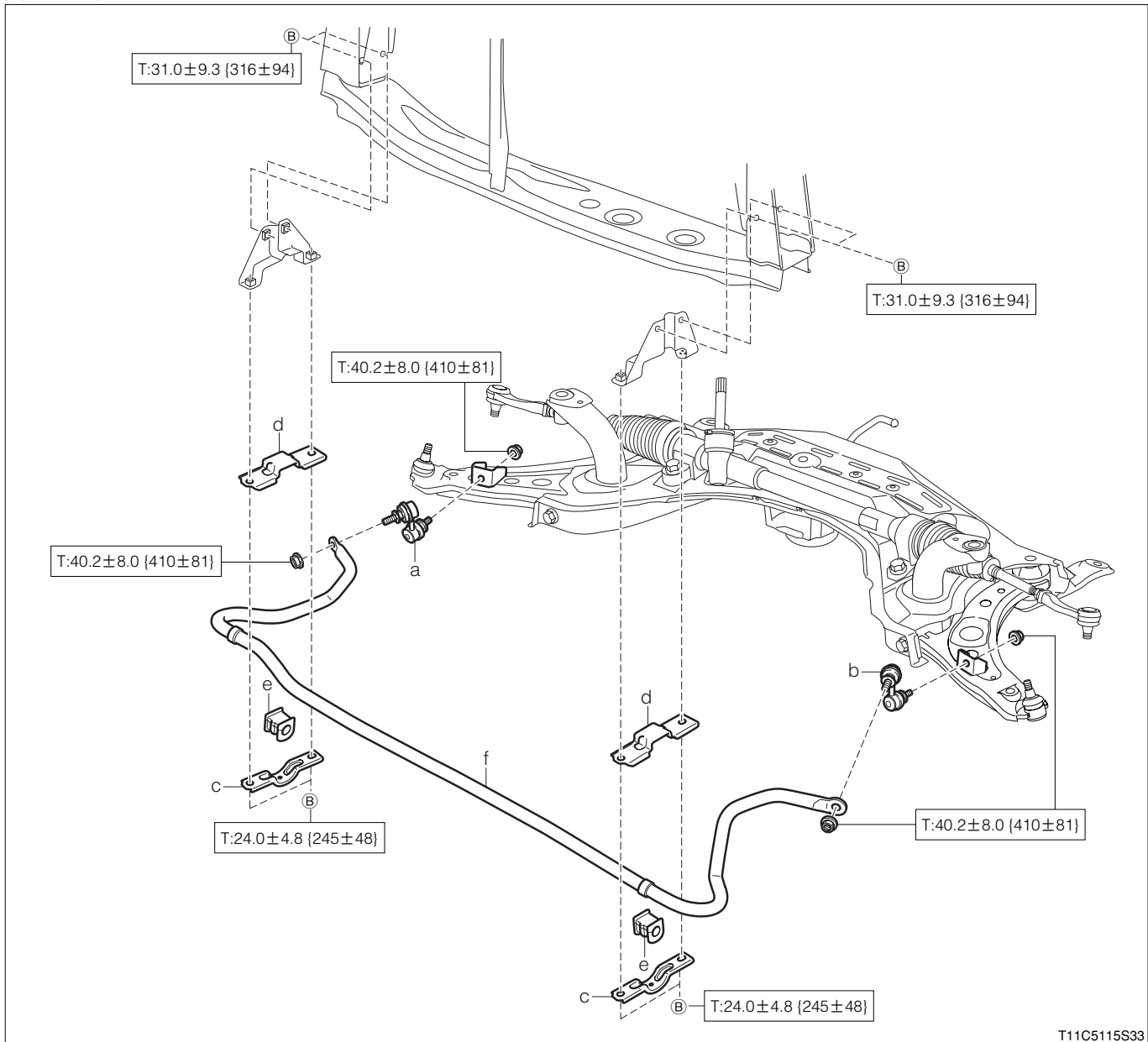

T11C5115S33

Unit:N·m{kgf·cm}

(2) Removal and installation procedures

- ▼ ▲ 1 a Link, stabilizer, No.1
- ▼ ▲ 2 b Link, stabilizer, No.2
- ▲ 3 c Bracket, stabilizer, No.2
- ▲ 4 d Bracket, stabilizer
- 5 e Bush, stabilizer
- ▼ ▲ 6 f Bar, stabilizer, front

4-1-4 POINTS OF REMOVAL

(1) Link, stabilizer

1. When removing the link, be sure to secure the nut section, using a spanner, so that no excessive force may be applied to the ball joint section.

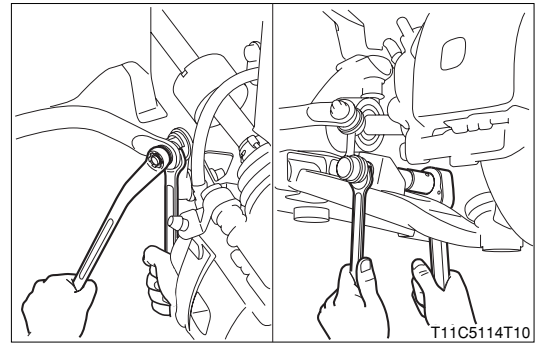

(2) Bar, stabilizer, front

1. Put a mating mark at the position where the bar is assembled with the stabilizer bush.

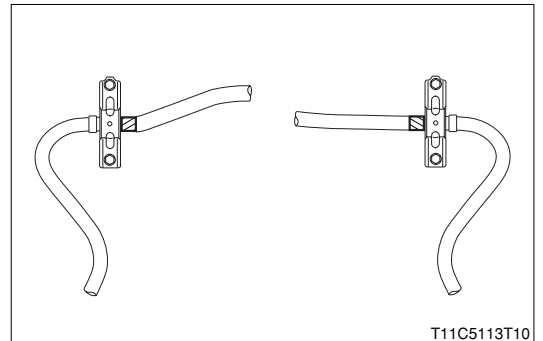

4-1-5 POINTS OF INSTALLATION

(1) Bar, stabilizer, front

1. Install the stabilizer bushing to the bar, while referring to the mating mark that has been put during the removal operation.

(2) Bracket, stabilizer

1. Install the bracket in such a way that the side at which an elongated hole is provided comes to the vehicle rear side. Then, gradually tighten the attaching bolts alternately at the front and rear sides, while exercising utmost care so that the bracket may not be tilted.

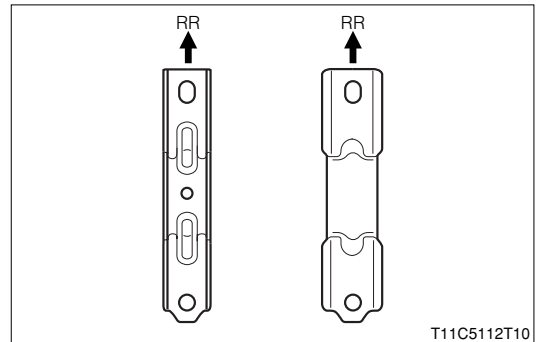

(3) Link, stabilizer

1. When tightening the hexagon nut, be sure to secure the nut section of the link so that no excessive force may be applied to the ball joint section of the link, using a spanner.
2. Once tighten the link temporarily. Afterward, rock the vehicle several times under the weighted condition so that the suspension may be settled. Then, carry out the tightening securely.

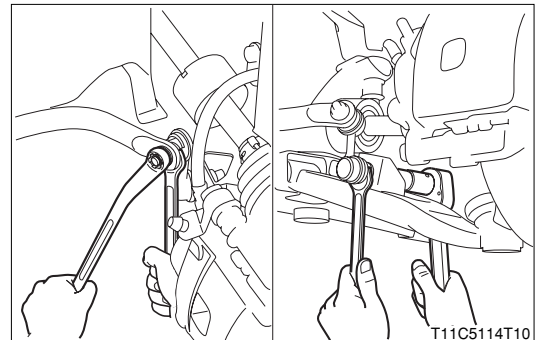

4-1-6 OPERATION AFTER INSTALLATION

1. Install the disc wheels. (Front)

Refer to Page C3-3.

2. Lift down the vehicle.

C1-17

5 FRONT SUSPENSION MEMBER

5-1 REMOVAL AND INSTALLATION

5-1-1 ARTICLES TO BE PREPARED

SST

Shape	Part No.	Part name
	09628-00011-000 (09611-87701-000)	Puller, tie-rod end

Instrument

Torque wrench

Lubricant, adhesive, others

Wooden block

5-1-2 OPERATION BEFORE REMOVAL

1. Separate the joint at the steering gear assembly side of the steering shaft universal joint assembly No.2.

Refer to Page G1-5.

2. Push out the steering column hole shield to the vehicle outside under a condition where it is attached to the steering gear assembly.

3. Lift up the vehicle.

4. Remove the disc wheels. (Front)

Refer to Page C3-3.

5. Remove the front speed sensors RH/LH from the steering knuckles RH/LH. (ABS-equipped vehicles)

Refer to Page E3-4.

6. Remove the front disc brake caliper Ay RH/LH. Hang it with a wire, etc.

Refer to Page E1-53.

7. Remove the Front disc.

Refer to Page E1-60.

8. Separate the stabilizer link from the suspension lower arm S/A RH/LH with bush.

Refer to Page C1-14.

9. Remove the nuts of the front drive shaft Ay RH/LH.

Refer to Page D2-8.

10. Remove the steering knuckles RH/LH and the ball joint sections of the tie-rod end S/A RH/LH, using the SST.

CAUTION

- When setting the SST, attach a dummy nut to the threaded portion of the tie-rod end S/A RH/LH so that the threaded portion may not be damaged.
- Hang the SST using a cord.

SST: 09628-00011-000

11. Separate the front shock absorber Ay from the steering knuckles RH/LH.

Refer to Page C1-6.

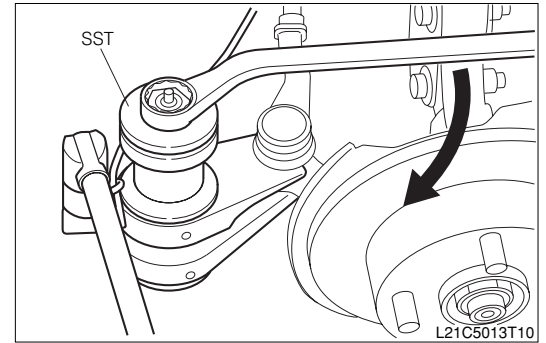

12. Pull out the front drive shaft Ay RH/LH from the steering knuckles RH/LH. Then, hang them with a wire, etc.

Refer to Page D2-8.

13. Separate the steering knuckles RH/LH from the ball joints of the suspension lower arm S/A with bush RH/LH, using the SST.

CAUTION

- When setting the SST, attach a dummy nut to the threaded portion of the suspension lower arm S/A with bush RH/LH so that the threaded portion may not be damaged.
- Hang the SST using a cord.

SST: 09628-00011-000

14. Remove the exhaust front pipe Ay.

(1) Vehicle mounted with Type 1KR engine

Refer to Page B4-3.

(2) Vehicle mounted with Type K3 engine

Refer to Page B4-6.

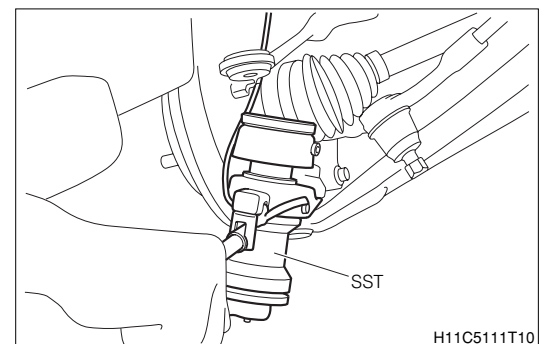

15. Remove the transmission floor shift Ay. (M/T vehicle)

Refer to Page F2-15.

16. Remove the transmission control cable Ay. (A/T vehicle)

Refer to Page F3-34.

C1-19

17. Apply a garage jack to the joint section between the engine Ay and the manual transaxle Ay/automatic transaxle Ay to support.

CAUTION

- When applying a garage jack, be sure to interpose a wooden block or cloth so as not to scratch the parts.
- Care must be exercised that the engine will not get lowered while it is supported with the garage jack.

18. Remove the bolts that connect the engine mounting rear bracket with the engine mounting control rod S/A.

Refer to Page B12-7.

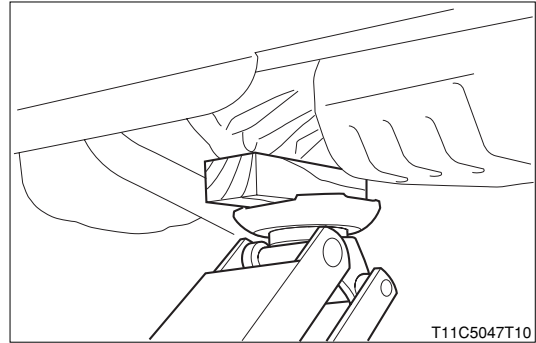

5-1-3 REMOVAL AND INSTALLATION PROCEDURES

(1) Components

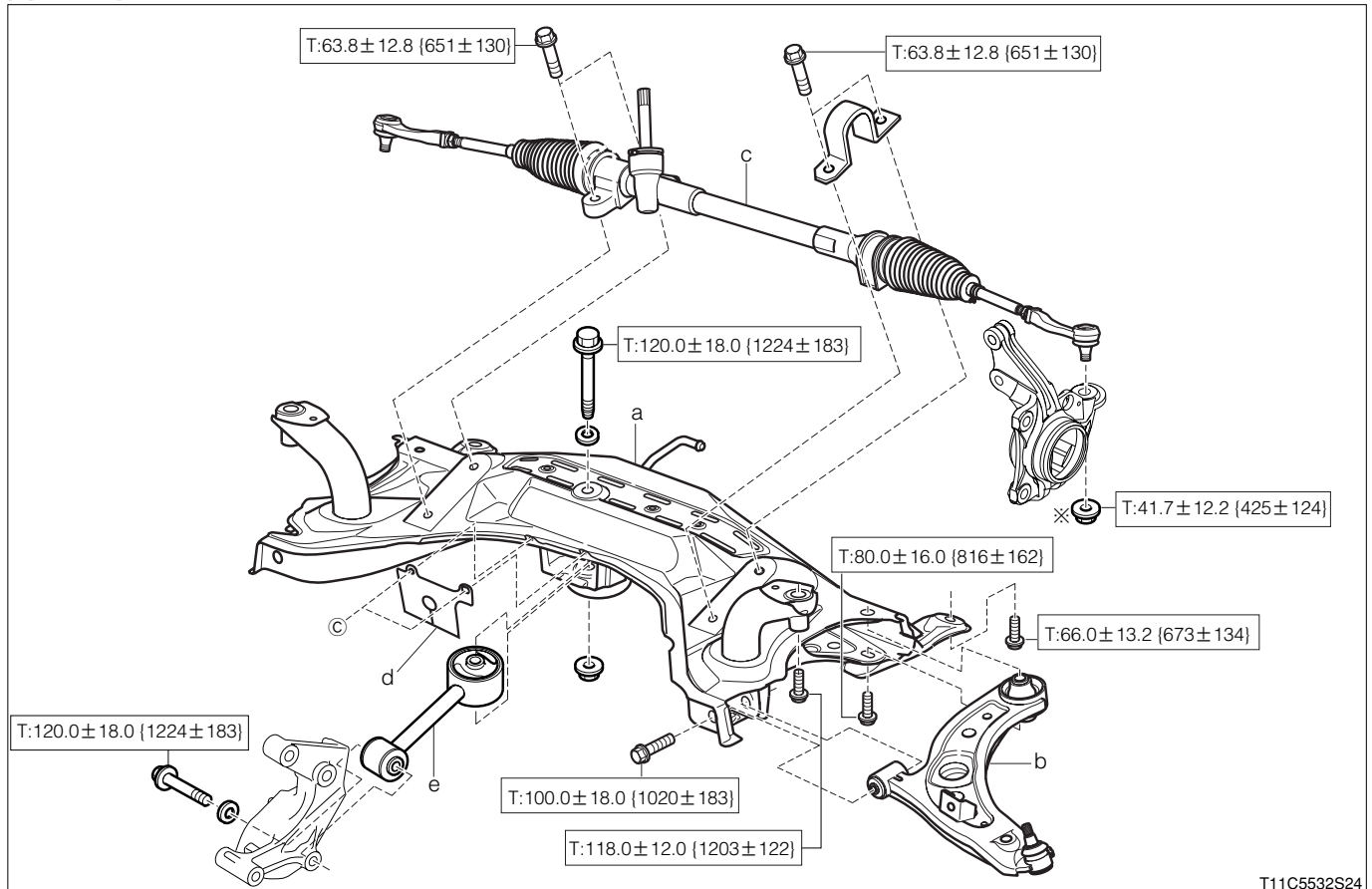

T11C5532S24

※:Non - reusable parts

Unit:N·m{kgf·cm}

(2) Removal procedures

- ▼ 1 a Crossmember S/A, front suspension
- 2 b Arm S/A, suspension lower w/bush, RH/LH
- 3 c Gear Ay, steering
- 4 d Cover, engine mounting hole (Cold region specification vehicle)
- 5 e Rod S/A, engine mounting control

(3) Installation procedures

- ▲ 1 a Crossmember S/A, front suspension
- 2 b Arm S/A, suspension lower w/bush, RH/LH
- 3 c Gear Ay, steering
- 4 d Cover, engine mounting hole (Cold region specification vehicle)
- 5 e Rod S/A, engine mounting control

5-1-4 POINTS OF REMOVAL

(1) Crossmember S/A, front suspension

1. Apply a garage jack to the jacking point of the crossmember S/A.

CAUTION

- When applying a garage jack, be sure to interpose a wooden block or cloth so as not to scratch the parts.

2. Remove the crossmember S/A from the vehicle with the following parts given below mounted on it.
 - (1) Arm S/A, suspension lower w/bush, RH/LH
 - (2) Gear Ay, steering
 - (3) Cover, engine mounting hole (Cold region specification vehicle)
 - (4) Rod S/A, engine mounting control
3. Remove the suspension lower w/bush RH/LH.
4. Remove the steering gear Ay.
5. Remove the engine mounting hole cover. (Cold region specification vehicle)
6. Remove the engine mounting control rod S/A.

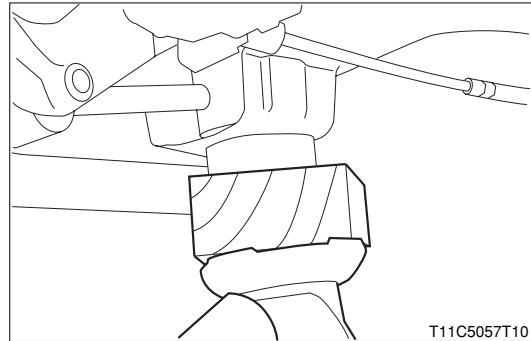

5-1-5 POINTS OF INSTALLATION

(1) Crossmember S/A, front suspension

1. Install the engine mounting control rod S/A in such a direction that it faces toward the front side of the vehicle relative to the crossmember S/A. Then, tighten it from the bolt side.
2. Install the engine mounting hole cover. (Cold region specification vehicle)
3. Install the steering gear Ay.
4. Install the suspension lower w/bush RH/LH.
5. Using a garage jack, support the following parts given below while they are mounted on the crossmember S/A. Install the crossmember S/A to the vehicle, while adjusting its position.

CAUTION

- When applying a garage jack, be sure to interpose a wooden block or cloth so as not to scratch the parts.
 - (1) Arm S/A, suspension lower w/bush, RH/LH
 - (2) Gear Ay, steering
 - (3) cover, engine mounting hole (Cold region specification vehicle)
 - (4) Rod S/A, engine mounting control

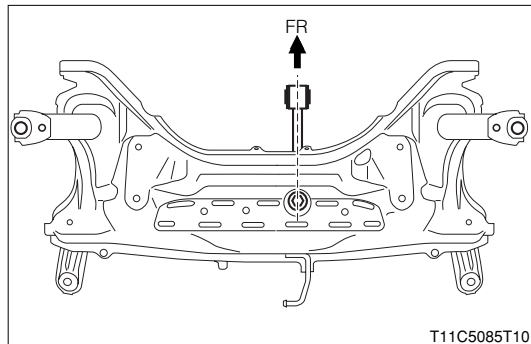

5-1-6 OPERATION AFTER INSTALLATION

1. Apply a garage jack to the joint section between the engine Ay and the manual transaxle Ay/automatic transaxle Ay to support.

CAUTION

- When applying a garage jack, be sure to interpose a wooden block or cloth so as not to scratch the parts.
- Care must be exercised that the engine will not get lowered while it is supported with the garage jack.

2. Tighten the bolts connecting the engine mounting rear bracket and engine mounting control rod S/A.

Refer to Page B12-7.

3. Install the transmission floor shift Ay. (M/T vehicle)

Refer to Page F2-15.

4. Install the transmission control cable Ay. (A/T vehicle)

Refer to Page F3-34.

5. Install the exhaust front pipe Ay.

(1) Vehicle mounted with Type 1KR engine

Refer to Page B4-3.

(2) Vehicle mounted with Type K3 engine

Refer to Page B4-6.

6. Adjust the installation dimension of the suspension lower arm S/A with bush RH/LH.

Refer to Page C1-10.

7. Install the ball joint sections of the suspension lower arm S/A with bush RH/LH to the steering knuckles RH/LH.

Refer to Page C1-10.

8. Insert the front drive shaft Ay RH/LH to the steering knuckle RH/LH.

Refer to Page D2-8.

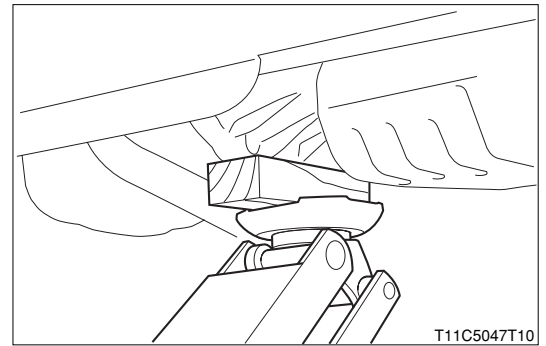

9. Install the steering knuckle RH/LH to the front shock absorber Ay.
Refer to Page C1-6.
10. Install the ball joint sections of the steering tie-rod end S/A RH/LH to the steering knuckles RH/LH.
Refer to Page G2-1.
11. Tighten the nuts of the front drive shaft Ay RH/LH.
Refer to Page D2-8.
12. Install the stabilizer link to the suspension lower arm S/A with bush RH/LH.
Refer to Page C1-14.
13. Install the front disc.
Refer to Page E1-60.
14. Install the front disc brake caliper Ay RH/LH.
Refer to Page E1-53.
15. Install the front speed sensors RH/LH to the steering knuckles RH/LH. (ABS-equipped vehicles)
Refer to Page E3-4.
16. Install the disc wheels. (Front)
Refer to Page E3-3.
17. Lift down the vehicle.
18. Install the No.2 steering shaft universal joint Ay to the steering gear Ay.
Refer to Page G1-5.
19. Check and adjust the front wheel alignment.
Refer to Page C1-1.