

SHIFT AND SELECT LEVER SHAFT COMPONENTS

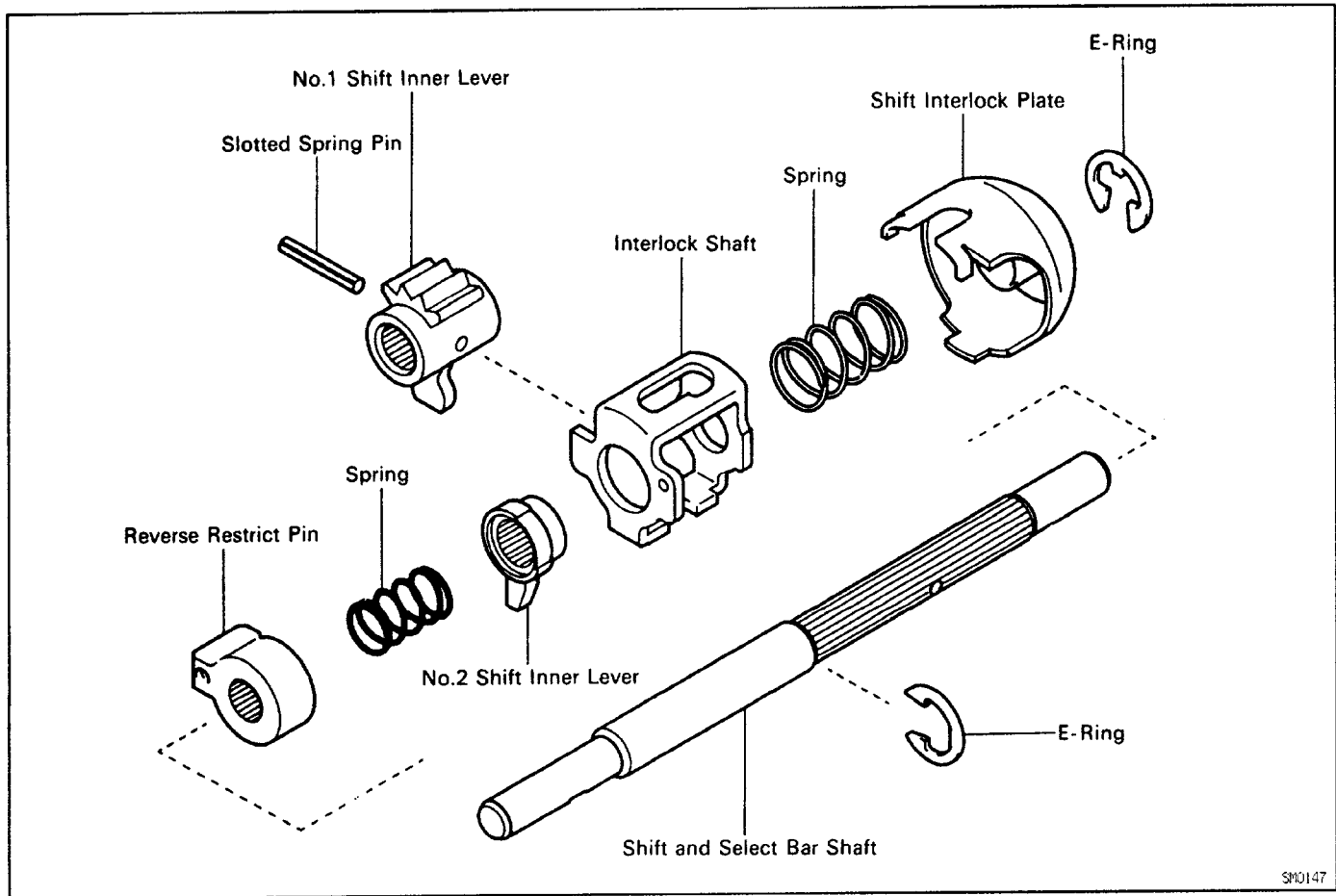

SM0147

MX040-01

SHIFT AND SELECT LEVER SHAFT DISASSEMBLY

1. REMOVE SHIFT INTERLOCK PLATE

(a) Remove the E-ring.

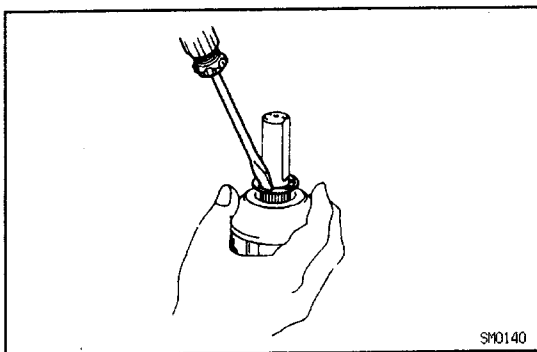

(b) Remove the interlock plate and spring.

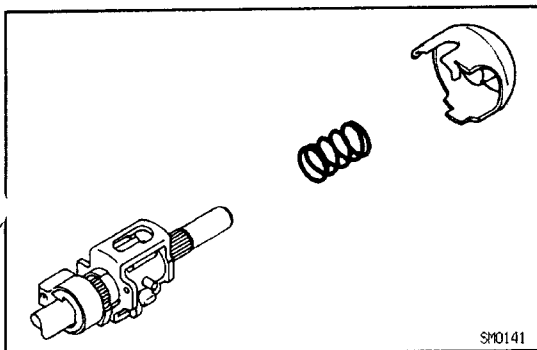

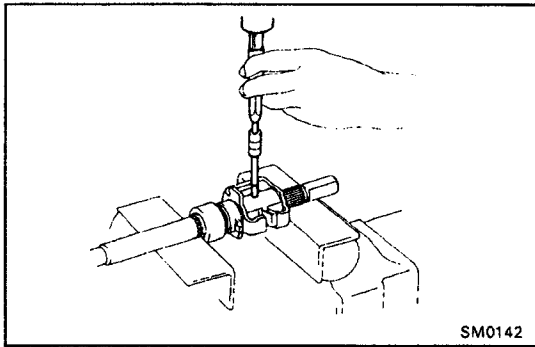

SM0142

2. REMOVE INTERLOCK SHAFT, NO.1 SHIFT INNER LEVER, NO.2 SHIFT INNER LEVER, SPRING AND REVERSE RESTRICT PIN

(a) Using a pin punch and hammer, drive out the slotted spring pin.

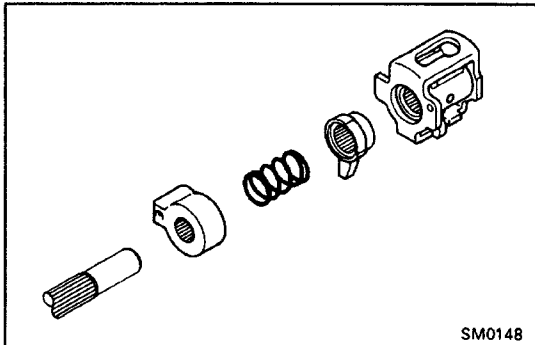

SM0148

(b) Remove the interlock shaft, No.1 shift inner lever, No. 2 shift inner lever, spring and reverse restrict pin.

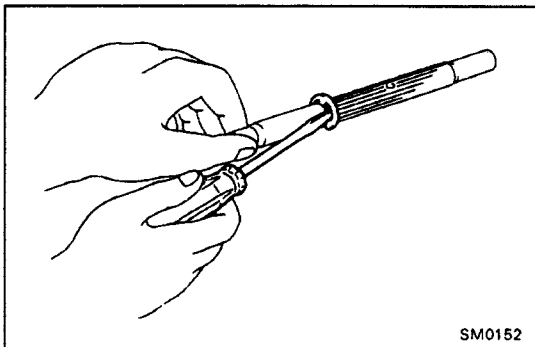

SM0152

3. REMOVE E- RING

SHIFT AND SELECT LEVER SHAFT MX04R-01 ASSEMBLY

(See page [MX1-45](#))

1. APPLY MP GREASE TO PARTS. AS SHOWN

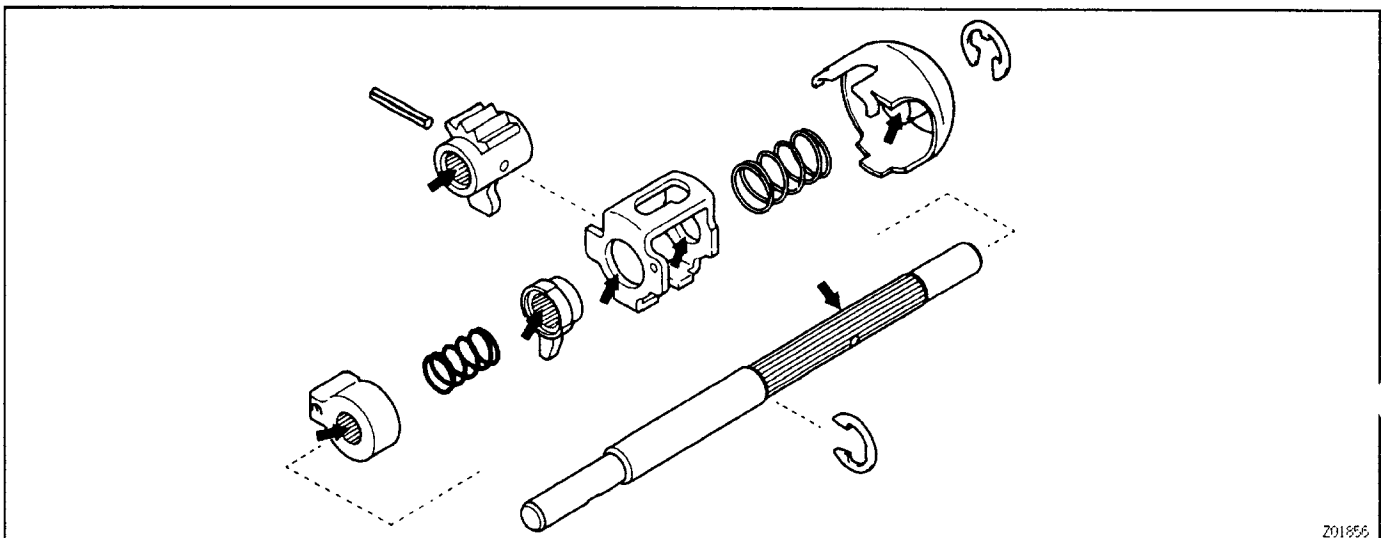

Z01356

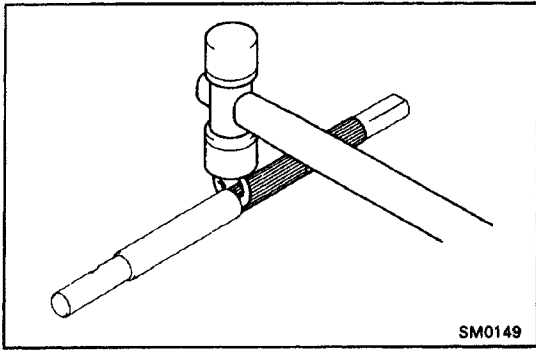

2. INSTALL E-RING

Using a plastic hammer, install the E-ring.

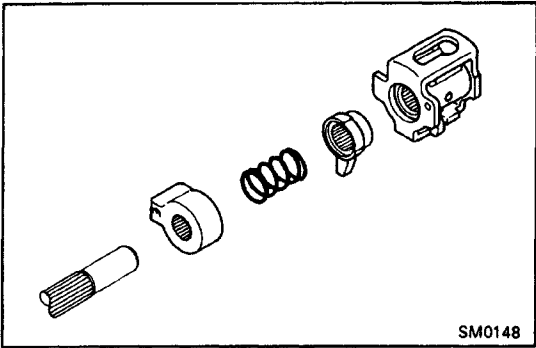

3. INSTALL REVERSE RESTRICT PIN, SPRING, NO.2 SHIFT INNER LEVER, NO.1 SHIFT INNER LEVER AND INTERLOCK SHAFT

(a) Install the reverse restrict pin, spring, No.2 shift inner lever, No.1 shift inner lever and interlock plate.

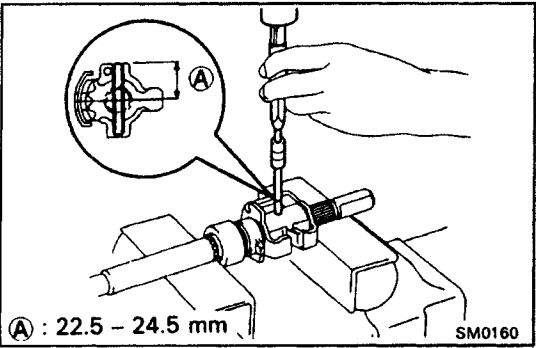

(b) Using a pin punch and hammer, drive in the slotted spring pin.

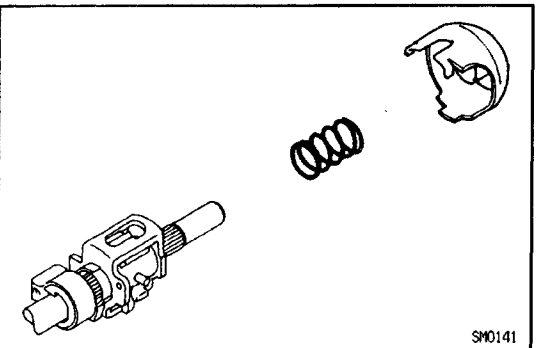

4. INSTALL SHIFT INTERLOCK PLATE

(a) install the spring and interlock plate.

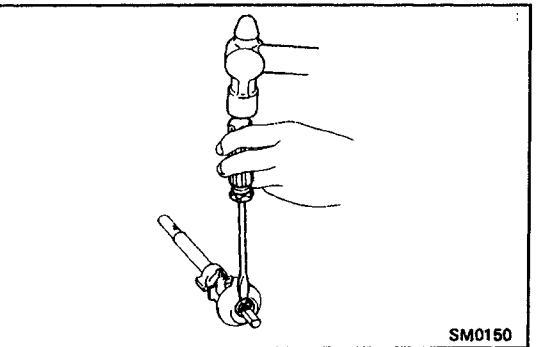

(b) Using a screwdriver and hammer, install the E-ring.